

# RIVERWALK

## STAGE 33

### GEELONG ROAD, WERRIBEE

### WYNDHAM CITY COUNCIL

FOR



## CIVIL DRAWINGS

## ROADS AND DRAINAGE

DCE REF: 10933RD  
MELWAY REF: 244 F2

Drawing File: C:\2d Synergy\data\SYNERGY-MEL\10933-Riverwalk - Stage 33\_1796\DESIGN\1\_1000\04\_L01\10933RD301.dwg - FS  
2022/04/13, 2022 - 17:55pm --mrcvrt--

© Dalton Consulting Engineers Pty Ltd



**DALTON  
CONSULTING  
ENGINEERS**  
ABN 78 429 221 049

VICTORIA  
T 61 3 9813 7400  
W [dceng.com.au](http://dceng.com.au)

QUEENSLAND  
T 61 7 3374 9000  
E [info@dceng.com.au](mailto:info@dceng.com.au)

**CONSTRUCTION**

Drawing File: C:\124\_Synergy\delta\ENERGY-MEL\10933-1166\1\_DESIGN\01\_A040\04-101  
 10933SP01.dwg - SP01  
 Date/Time: Wed Apr 13, 2022 - 12:59pm - mshd

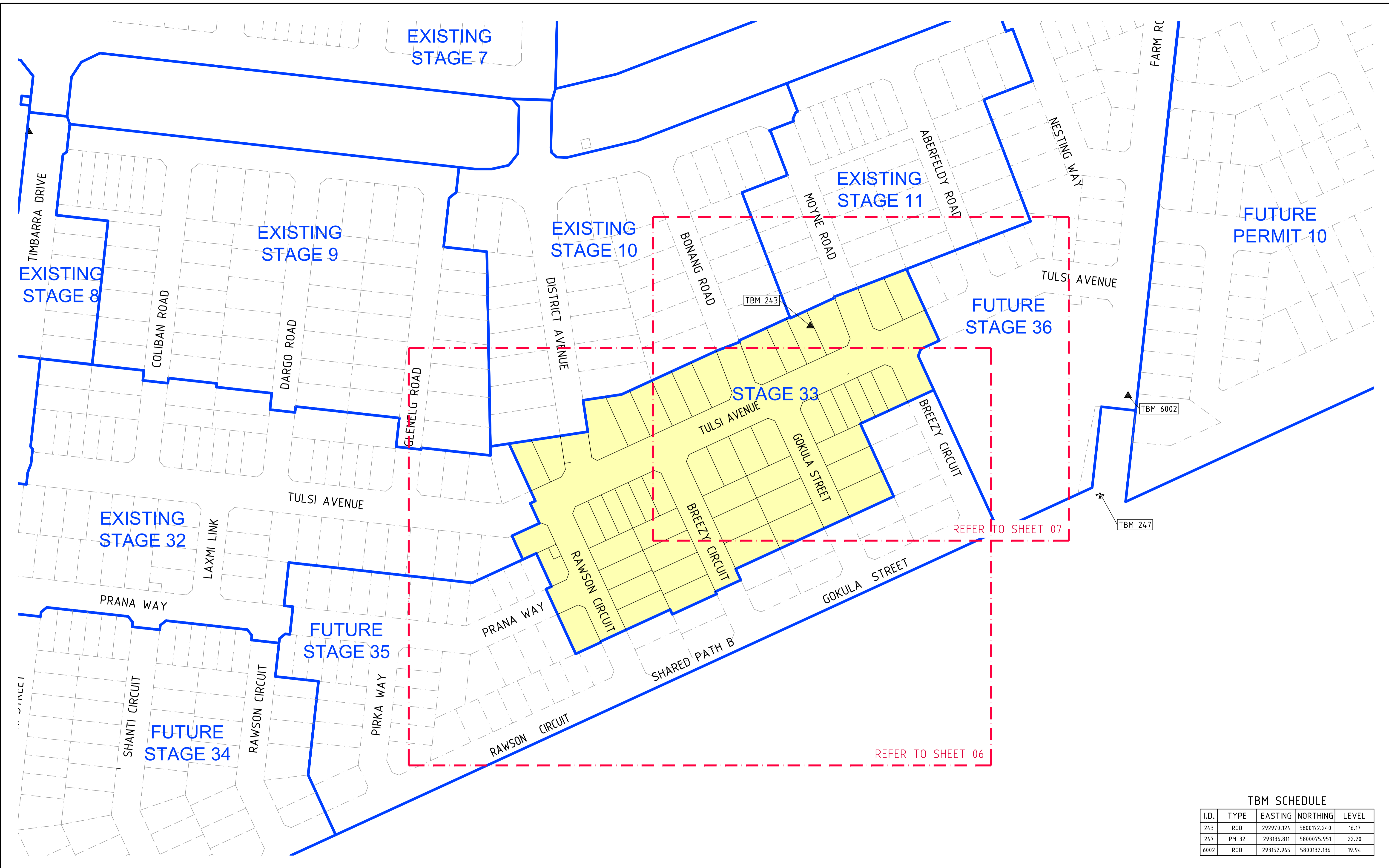

**TBM SCHEDULE**

I.D.	TYPE	EASTING	NORTHING	LEVEL
243	ROD	292970.124	5800172.240	16.17
247	PM 32	293136.811	5800075.951	22.20
6002	ROD	293152.965	5800132.136	19.94

REV	DESCRIPTION	DATE	AMEND	APP'D
0	CONSTRUCTION ISSUE	13/04/22	SR/MM	TL

Drawn: B. SHADE  
 Date: 18/03/21  
 AN: 1271316  
 Designed: K. LIM WAN  
 Date: 09/12/20  
 AN: 2861068  
 Checked: J. HOLLAND  
 Date: 22/01/21  
 AN: 972433  
 Approved: T. LIKOPOULOS  
 Date: 13/04/22  
 AN: 889339

**LEGEND**

- STAGE BOUNDARY
- - - DETAIL PLAN BOUNDARY
- CURRENT STAGE



**RIVERWALK**  
**STAGE 33**  
**GEELONG ROAD, WERRIBEE**  
**WYNDHAM CITY COUNCIL**  
**STAGING PLAN**  
 Drawing No. 10933SP01  
 Sheet No. 05 of 52

**DALTON CONSULTING ENGINEERS**  
 ABN 78 429 221 049  
 VICTORIA: T 61 3 9813 7400, W dceng.com.au  
 QUEENSLAND: T 61 7 3374 9000, E info@dceng.com.au  
CONSTRUCTION

Rev 0

Coords: MGA Levels: AHD  
 Scale @ A1/A3 1:1000 / 1:2000

Written dimensions to take precedence over scale. Contractor shall check and verify all dimensions on site. Discrepancies to be brought to the attention of the Superintendent.

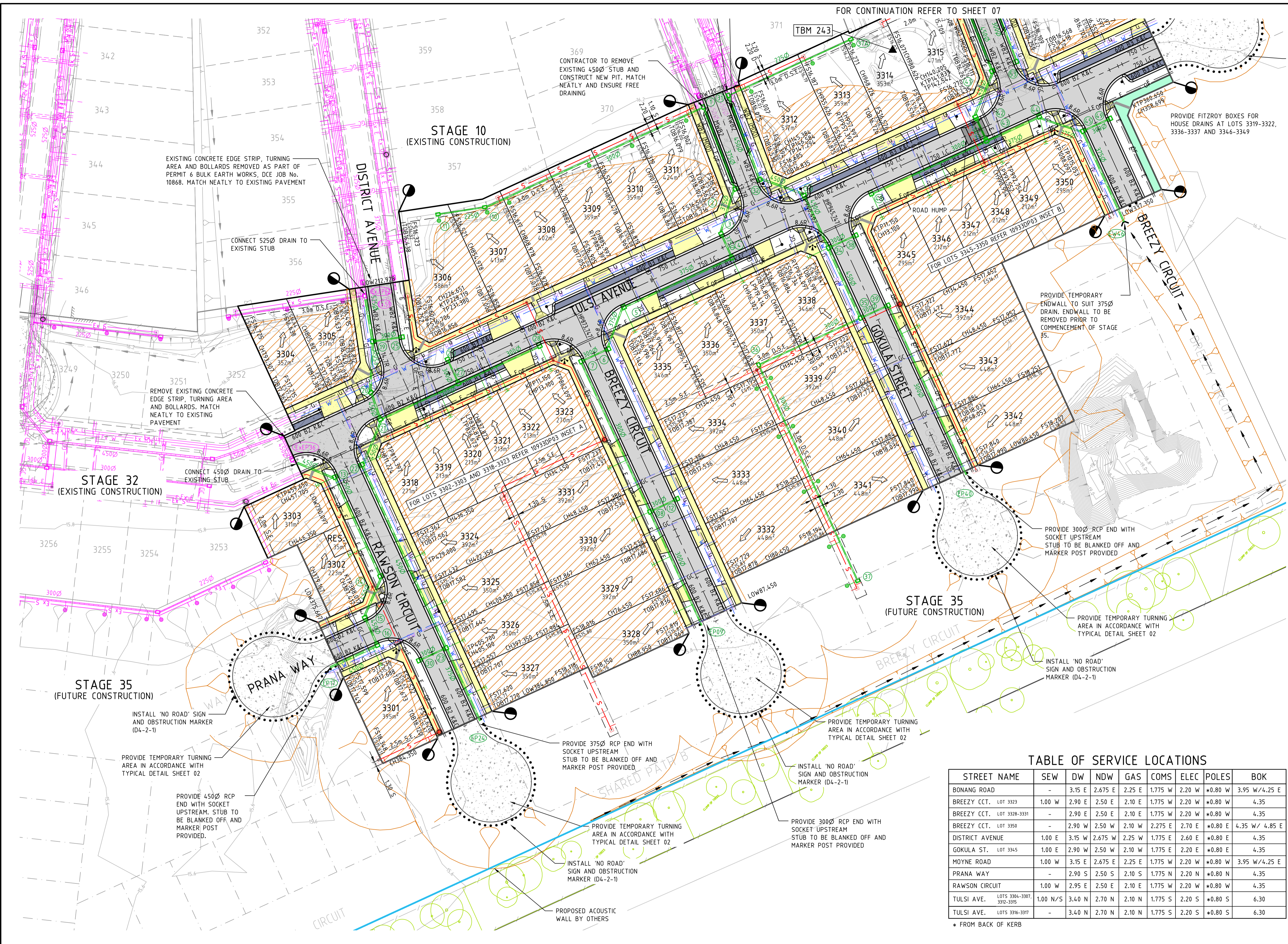

**TBM SCHEDULE**

I.D.	TYPE	EASTING	NORTHING	LEVEL
243	ROD	292970.124	5800172.240	16.17
247	PM 32	293136.811	5800075.951	22.20
6002	ROD	293152.965	5800132.136	19.94

NOTE:  
TBM'S No. 6002 & 247 ARE SHOWN IN DRG. No. 109335P01, SHEET No. 05.

**NOTE: EXISTING SURFACE LEVELS**  
ALL EXISTING SURFACE LEVELS SHOWN ON THIS PLAN ARE PRIOR TO THE COMMENCEMENT OF PERMIT 6 BULK EARTHWORKS (DCE JOB NUMBER 10868).

**NOTE: END OF PAVEMENT WORKS**  
CONCRETE EDGE STRIP AND AG DRAIN TO BE INSTALLED TO THE END OF ALL PAVEMENT WORKS.

**NOTE: EXISTING SERVICES**  
ALL EXISTING SERVICES UNDER NEW AND PROPOSED ROAD PAVEMENT, FOOTPATH AND DRIVEWAYS TO BE FOR BACKFILLED.

**NOTE: EXISTING STRUCTURES**  
ALL EXISTING DRAINAGE PITS AND SEWER STRUCTURES WITHIN NEW WORKS ARE TO BE ADJUSTED TO MATCH NEW FINISHED SURFACE LEVELS.

**NOTE: TACTILE PAVING**  
TACTILE GROUND SURFACE INDICATORS (TGS/IS) ARE SHOWN INDICATIVELY AND SHOULD BE CONSTRUCTED IN ACCORDANCE WITH AS/NZS 1428.4:2009.

**NOTE: PARKING BAYS**  
WHERE APPLICABLE PARKING BAYS TO NEATLY MATCH AND TRANSITION INTO CROSSOVERS AS NOMINATED ON DP01-DP03. ALL OTHER PARKING BAYS ARE TO BE CONSTRUCTED IN ACCORDANCE WITH T002.

**BEWARE!**  
DEVELOPMENT VICTORIA FTTH OPTIC FIBRE CABLES IN THE VICINITY OF WORKS. TEL: 03 9311 4575.

**BEWARE!**  
NBN OPTIC FIBRE CABLES IN THE VICINITY OF WORKS. TEL: 1800 687 626.

**BEWARE!**  
TELSTRA OPTIC FIBRE CABLES IN THE VICINITY OF WORKS. TEL: 9253 8263.

**CAUTION!**  
TELSTRA MAJOR CABLES ARE IN THE VICINITY OF WORKS.

**DANGER!**  
OVERHEAD ELECTRICITY TRANSMISSION LINES. CONTRACTOR TO EXERCISE EXTREME CAUTION WHEN OPERATING IN THE VICINITY OF THESE LINES. THE CONTRACTOR MUST ADHERE TO ALL "NO GO ZONE" REQUIREMENTS OF THE POWER AUTHORITY.

**WARNING!**  
NO DRAINAGE WORKS SHALL COMMENCE UNTIL THE CONTRACTOR CONFIRMS THE I.L. OF ALL EXISTING DRAINS, AND CONFIRMS IN WRITING WITH THE ENGINEERING SUPERVISOR.

**WARNING!**  
THE LOCATION OF EXISTING SERVICES SHOWN ON THESE PLANS MUST BE PROVEN ON SITE, THE APPROPRIATE AUTHORITY MUST BE CONTACTED AND THE SERVICES LOCATED PRIOR TO COMMENCEMENT OF ANY WORKS.

**WARNING!**  
**BEWARE OF ASBESTOS!**  
SOME UNDERGROUND SERVICES MAY BE CONSTRUCTED FROM ASBESTOS CONTAINING MATERIAL. CONTACT THE SUPERINTENDENT FOR INSTRUCTIONS ON HOW TO MANAGE ANY POTENTIAL ASBESTOS HAZARD.

**TABLE OF SERVICE LOCATIONS**

STREET NAME	SEW	DW	NDW	GAS	COMS	ELEC	POLES	BOK
BONANG ROAD	-	3.15 E	2.675 E	2.25 E	1.775 W	2.20 W	*0.80 W	3.95 W/4.25 E
BREEZY CCT. LOT 3323	1.00 W	2.90 E	2.50 E	2.10 E	1.775 W	2.20 W	*0.80 W	4.35
BREEZY CCT. LOT 3328-3331	-	2.90 E	2.50 E	2.10 E	1.775 W	2.20 W	*0.80 W	4.35
BREEZY CCT. LOT 3350	-	2.90 W	2.50 W	2.10 W	2.275 E	2.70 E	*0.80 E	4.35 W / 4.85 E
DISTRICT AVENUE	1.00 E	3.15 W	2.675 W	2.25 W	1.775 E	2.60 E	*0.80 E	4.35
GOKULA ST. LOT 3345	1.00 E	2.90 W	2.50 W	2.10 W	1.775 E	2.20 E	*0.80 E	4.35
MOYNE ROAD	1.00 W	3.15 E	2.675 E	2.25 E	1.775 W	2.20 W	*0.80 W	3.95 W/4.25 E
PRANA WAY	-	2.90 S	2.50 S	2.10 S	1.775 N	2.20 N	*0.80 N	4.35
RAWSON CIRCUIT	1.00 W	2.95 E	2.50 E	2.10 E	1.775 W	2.20 W	*0.80 W	4.35
TULSI AVE. LOTS 3304-3307, 3312-3315	1.00 N/S	3.40 N	2.70 N	2.10 N	1.775 S	2.20 S	*0.80 S	6.30
TULSI AVE. LOTS 3316-3317	-	3.40 N	2.70 N	2.10 N	1.775 S	2.20 S	*0.80 S	6.30

\* FROM BACK OF KERB

REV	DESCRIPTION	DATE	AMEND	APPD
0	CONSTRUCTION ISSUE	13/04/22	SR/MM	TL

Drawn  
Date  
Designed  
Date  
Checked  
Date  
Approved  
Date

B. SHADE  
18/03/21  
1271316  
K. LIM WAN  
09/12/20  
2861068  
J. HOLLAND  
22/01/21  
972433  
T. LIKOPPOULOS  
13/04/22  
889339

**LEGEND**

— EX W —	EX. WATER MAIN	— E —	ELECTRICITY	— SW DRAIN & PIT	SW DRAIN & PIT	— EX TREE TO REMAIN	EX. TREE TO REMAIN
— EX RW —	EX. REC. WATER MAIN	— OF —	OPTIC FIBRE	— H —	HOUSE DRN   PROP. INLET	— TURN AREA	TURN AREA
— EX G —	EX. GAS MAIN	— G —	GAS	— FS21.650	FINISHED SURFACE LEVEL	— FILLING OVER 300mm	FILLING OVER 300mm
— EX E —	EX. ELECTRICAL CABLE	— W —	WATER	— ES20.06	EX. SURFACE LEVEL	— ASPHALT PAVEMENT	ASPHALT PAVEMENT
— EX D —	EX. DRAIN & PIT	— RW —	RECYCLED WATER	— TOB21.650	TOP OF BATTER LEVEL	— CONCRETE SHARED PATH	CONCRETE SHARED PATH
— EX OF —	EX. OPTIC FIBRE	— GC —	DW/NDW/GAS CONDUITS	— L	LIMIT OF WORKS	— CONCRETE PATH   D'WAY	CONCRETE PATH   D'WAY
— EX S —	EX. SEWER MAIN & MH	— R —	REGRADE LOT AT MIN 1 IN 150	— S	SIGNAGE	— CONCRETE PARKING BAY	CONCRETE PARKING BAY
— S —	SEWER MAIN & MANHOLE	— O —	OVERLAND FLOW	— PSM   TBM	PSM   TBM		

**DEVELOPMENT VICTORIA**

Scale @ A1/A3 1:500 / 1:1000

**RIVERWALK  
STAGE 33  
GEELONG ROAD, WERRIBEE  
WYNDHAM CITY COUNCIL  
DETAIL PLAN  
SHEET 01 OF 03  
Drawing No. 10933DP01  
Sheet No. 06 of 52**

**DALTON CONSULTING ENGINEERS**  
ABN 78 429 221 049  
QUEENSLAND  
T 61 7 3374 9000  
E info@dceng.com.au

VICTORIA  
T 61 3 9813 7400  
W dceng.com.au

**CONSTRUCTION**

Drawing File: C:\124\_Synergy\delta\delta\ENERGY-ME\10933-Riverwalk - Stage 33\_1786\1\_DESIGN\01\_ACAD\04-RO...  
 10/03/2021 10:41:00 AM - DP01  
 Date/Time: Wed Apr 13, 2022 - 12:59pm - msh...

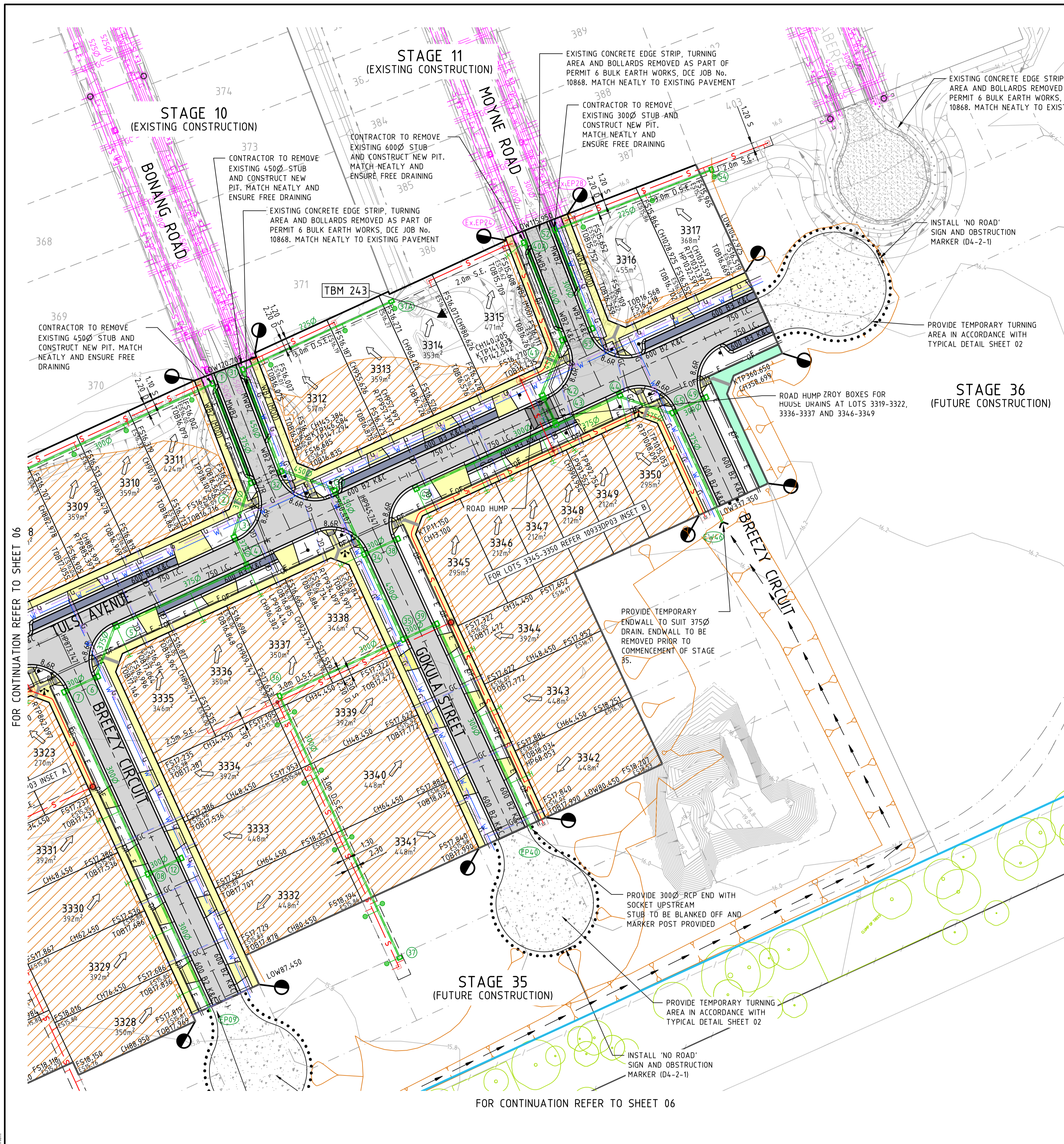

**TABLE OF SERVICE LOCATIONS**

STREET NAME	SEW	DW	NDW	GAS	COMS	ELEC	POLES	BOK
BONANG ROAD	-	3.15 E	2.675 E	2.25 E	1.775 W	2.20 W	+0.80 W	3.95 W/4.25 E
BREEZY CCT. LOT 3323	1.00 W	2.90 E	2.50 E	2.10 E	1.775 W	2.20 W	+0.80 W	4.35
BREEZY CCT. LOT 3328-3331	-	2.90 E	2.50 E	2.10 E	1.775 W	2.20 W	+0.80 W	4.35
BREEZY CCT. LOT 3350	-	2.90 W	2.50 W	2.10 W	2.275 E	2.70 E	+0.80 E	4.35 W/ 4.85 E
DISTRICT AVENUE	1.00 E	3.15 W	2.675 W	2.25 W	1.775 E	2.60 E	+0.80 E	4.35
GOKULA ST. LOT 3345	1.00 E	2.90 W	2.50 W	2.10 W	1.775 E	2.20 E	+0.80 E	4.35
MOYNE ROAD	1.00 W	3.15 E	2.675 E	2.25 E	1.775 W	2.20 W	+0.80 W	3.95 W/4.25 E
PRANA WAY	-	2.90 S	2.50 S	2.10 S	1.775 N	2.20 N	+0.80 N	4.35
RAWSON CIRCUIT	1.00 W	2.95 E	2.50 E	2.10 E	1.775 W	2.20 W	+0.80 W	4.35
TULSI AVE. LOTS 3304-3307, 3312-3315	1.00 N/S	3.40 N	2.70 N	2.10 N	1.775 S	2.20 S	+0.80 S	6.30
TULSI AVE. LOTS 3316-3317	-	3.40 N	2.70 N	2.10 N	1.775 S	2.20 S	+0.80 S	6.30

\* FROM BACK OF KERB

**TBM SCHEDULE**

I.D.	TYPE	EASTING	NORTHING	LEVEL
243	ROD	292970.124	5800172.240	16.17
247	PM 32	293136.811	5800075.951	22.20
6002	ROD	293152.965	5800132.136	19.94

**NOTE: PARKING BAYS**  
WHERE APPLICABLE PARKING BAYS TO NEATLY MATCH AND TRANSITION INTO CROSSOVERS AS NOMINATED ON DP01-DP03. ALL OTHER PARKING BAYS ARE TO BE CONSTRUCTED IN ACCORDANCE WITH TD02.

**NOTE:**  
TBM'S No. 6002 & 247 ARE SHOWN IN DRG. No. 10933SP01, SHEET No. 05.

**NOTE: EXISTING SURFACE LEVELS**  
ALL EXISTING SURFACE LEVELS SHOWN ON THIS PLAN ARE PRIOR TO THE COMMENCEMENT OF PERMIT 6 BULK EARTHWORKS (DCE JOB NUMBER 10868).

**NOTE: END OF PAVEMENT WORKS**  
CONCRETE EDGE STRIP AND AG DRAIN TO BE INSTALLED TO THE END OF ALL PAVEMENT WORKS.

**NOTE: EXISTING SERVICES**  
ALL EXISTING SERVICES UNDER NEW AND PROPOSED ROAD PAVEMENT, FOOTPATH AND DRIVEWAYS TO BE FCR BACKFILLED.

**NOTE: EXISTING STRUCTURES**  
ALL EXISTING DRAINAGE PITS AND SEWER STRUCTURES WITHIN NEW WORKS ARE TO BE ADJUSTED TO MATCH NEW FINISHED SURFACE LEVELS.

**NOTE: TACTILE PAVING**  
TACTILE GROUND SURFACE INDICATORS (TGS/IS) ARE SHOWN INDICATIVELY AND SHOULD BE CONSTRUCTED IN ACCORDANCE WITH AS/NZS 1428.4:12009.

**BWARE!**  
DEVELOPMENT VICTORIA FTTH OPTIC FIBRE CABLES IN THE VICINITY OF WORKS.  
TEL: 03 9311 4575.

**BWARE!**  
NBN OPTIC FIBRE CABLES IN THE VICINITY OF WORKS. TEL: 1800 687 626.

**BWARE!**  
TELSTRA OPTIC FIBRE CABLES IN THE VICINITY OF WORKS. TEL: 9253 8263.

**CAUTION!**  
TELSTRA MAJOR CABLES ARE IN THE VICINITY OF WORKS.

**DANGER!**  
OVERHEAD ELECTRICITY TRANSMISSION LINES. CONTRACTOR TO EXERCISE EXTREME CAUTION WHEN OPERATING IN THE VICINITY OF THESE LINES. THE CONTRACTOR MUST ADHERE TO ALL "NO GO ZONE" REQUIREMENTS OF THE POWER AUTHORITY.

**WARNING!**  
NO DRAINAGE WORKS SHALL COMMENCE UNTIL THE CONTRACTOR CONFIRMS THE I.L. OF ALL EXISTING DRAINS, AND CONFIRMS IN WRITING WITH THE ENGINEERING SUPERVISOR.

**WARNING!**  
THE LOCATION OF EXISTING SERVICES SHOWN ON THESE PLANS MUST BE PROVEN ON SITE, THE APPROPRIATE AUTHORITY MUST BE CONTACTED AND THE SERVICES LOCATED PRIOR TO COMMENCEMENT OF ANY WORKS.

**WARNING!**  
**BWARE OF ASBESTOS!**  
SOME UNDERGROUND SERVICES MAY BE CONSTRUCTED FROM ASBESTOS CONTAINING MATERIAL. CONTACT THE SUPERINTENDENT FOR INSTRUCTIONS ON HOW TO MANAGE ANY POTENTIAL ASBESTOS HAZARD.

REV	DESCRIPTION	DATE	AMEND	APPD
0	CONSTRUCTION ISSUE	13/04/22	SR/MM	TL

Drawn: B. SHADE  
Date: 18/03/21  
AN: 1271316  
Designed: K. LIM WAN  
Date: 09/12/20  
AN: 2861068  
Checked: J. HOLLAND  
Date: 22/01/21  
AN: 972433  
Approved: T. LIKOPPOULOS  
Date: 13/04/22  
AN: 889339

**LEGEND**

-Ex W-	EX. WATER MAIN	-E-	ELECTRICITY	SW DRAIN & PIT	SW DRAIN & PIT
-Ex RW-	EX. REC. WATER MAIN	-OF-	OPTIC FIBRE	H	HOUSE DRN   PROP. INLET
-Ex G-	EX. GAS MAIN	-G-	GAS	FS21.650	FINISHED SURFACE LEVEL
-Ex E-	EX. ELECTRICAL CABLE	-W-	WATER	ES20.06	EX. SURFACE LEVEL
-Ex D-	EX. DRAIN & PIT	-RW-	RECYCLED WATER	TOB21.650	TOP OF BATTER LEVEL
-Ex OF-	EX. OPTIC FIBRE	-GC-	DW/NDW/GAS CONDUITS	○	LIMIT OF WORKS
-Ex S-	EX. SEWER MAIN & MH	←	REGRADE LOT AT MIN 1 IN 150	▲	SIGNAGE
-S-	SEWER MAIN & MANHOLE	→	OVERLAND FLOW	▲	PSM   TBM

EX. TREE TO REMAIN  
ACOUSTIC WALL (BY OTHERS)  
TURN AREA  
FILLING OVER 300mm  
ASPHALT PAVEMENT  
CONCRETE SHARED PATH  
CONCRETE PATH | D'WAY  
CONCRETE PARKING BAY

Coords: MGA Levels: AHD  
**DIAL BEFORE YOU DIG**  
www.1100.com.au

**DEVELOPMENT VICTORIA**  
Scale @ A1/A3 1:500 / 1:1000

**RIVERWALK STAGE 33**  
GEELONG ROAD, WERRIBEE  
WYNDHAM CITY COUNCIL  
DETAIL PLAN  
SHEET 02 OF 03  
Drawing No. 10933DP02  
Sheet No. 07 of 52

**DALTON CONSULTING ENGINEERS**  
VICTORIA  
T 61 3 9813 7400  
W dceng.com.au  
QUEENSLAND  
T 61 7 3374 9000  
E info@dceng.com.au  
**CONSTRUCTION**

Drawing File: C:\124\_Synergy\delta\delta\ENERGY-ME\10933-Afterwork - Stage 33\_17186\1\_DESIGN\01\_ACAD\04-ROJ...  
Date/Time: Wed Apr 13, 2022 - 12:59pm - msh...

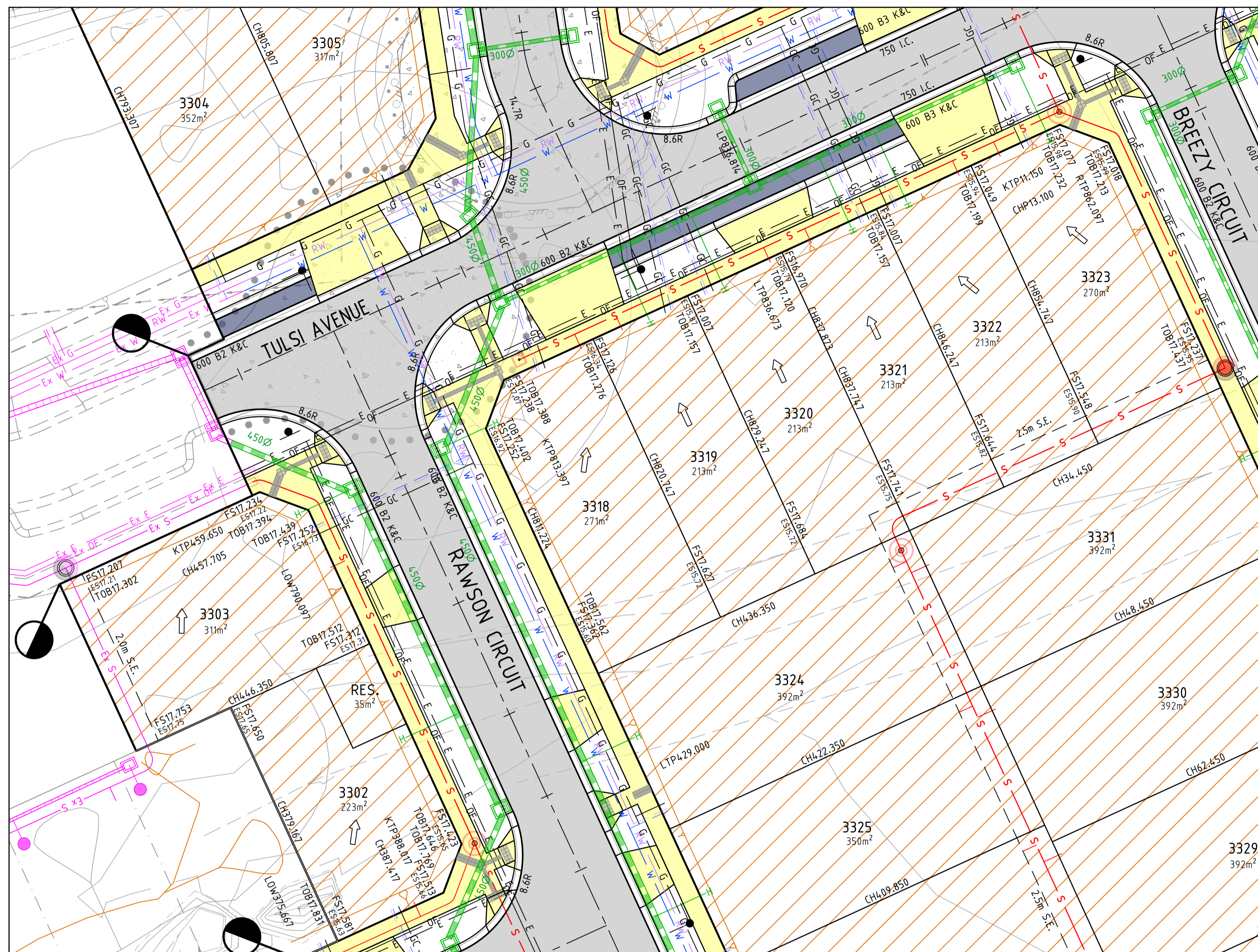

**INSET A**  
 LOTS 3302 TO 3303 AND 3318 TO 3323  
 SCALE @ A1/A3 1:250/1:500

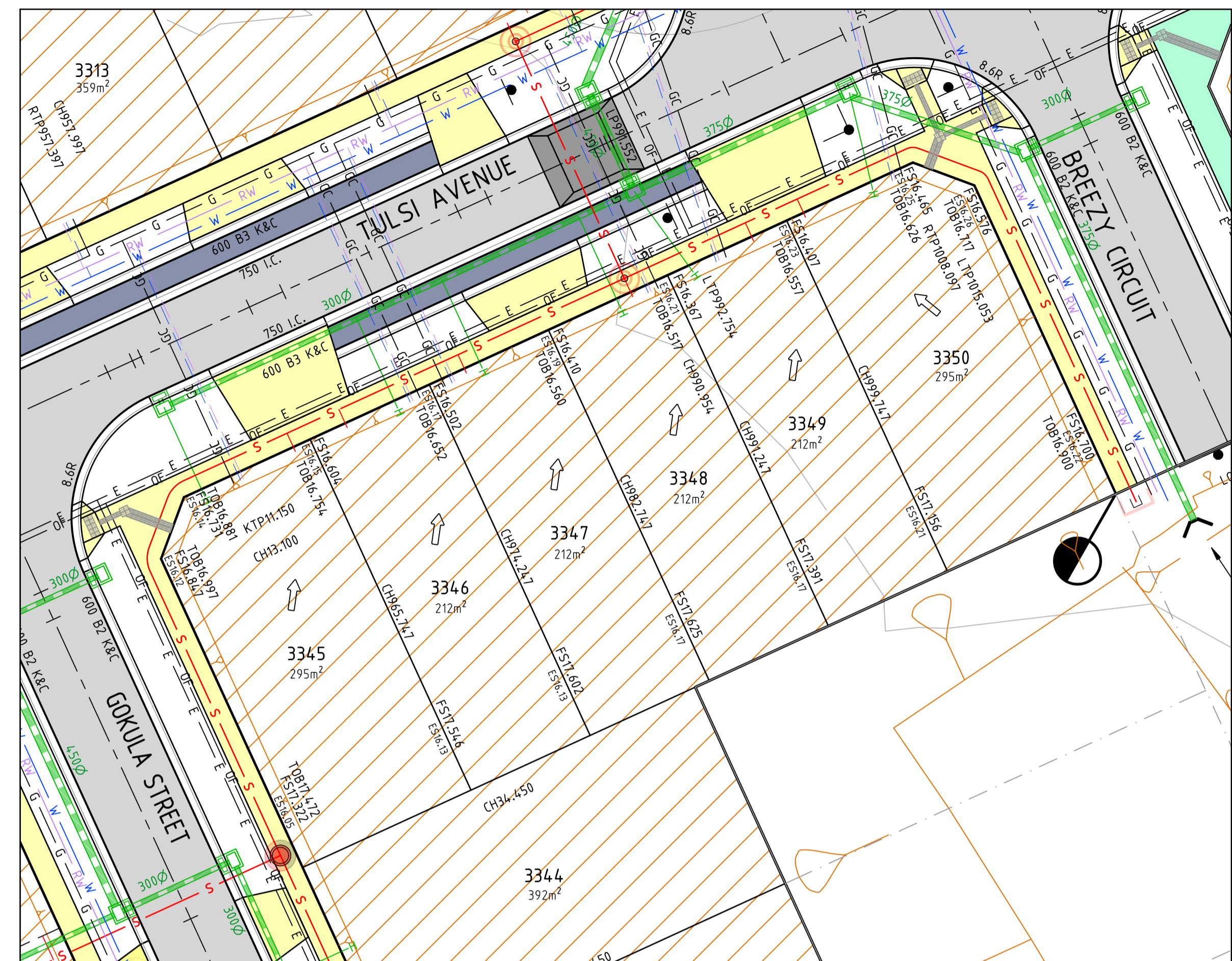

**INSET B**  
 LOTS 3345 TO 3350  
 SCALE @ A1/A3 1:250/1:500

**TABLE OF SERVICE LOCATIONS**

STREET NAME	SEW	DW	NDW	GAS	COMS	ELEC	POLES	BOK
BONANG ROAD	-	3.15 E	2.675 E	2.25 E	1.775 W	2.20 W	+0.80 W	3.95 W/4.25 E
BREEZY CCT. LOT 3323	1.00 W	2.90 E	2.50 E	2.10 E	1.775 W	2.20 W	+0.80 W	4.35
BREEZY CCT. LOT 3328-3331	-	2.90 E	2.50 E	2.10 E	1.775 W	2.20 W	+0.80 W	4.35
BREEZY CCT. LOT 3350	-	2.90 W	2.50 W	2.10 W	2.275 E	2.70 E	+0.80 E	4.35 W/ 4.85 E
DISTRICT AVENUE	1.00 E	3.15 W	2.675 W	2.25 W	1.775 E	2.60 E	+0.80 E	4.35
GOKULA ST. LOT 3345	1.00 E	2.90 W	2.50 W	2.10 W	1.775 E	2.20 E	+0.80 E	4.35
MOYNE ROAD	1.00 W	3.15 E	2.675 E	2.25 E	1.775 W	2.20 W	+0.80 W	3.95 W/4.25 E
PRANA WAY	-	2.90 S	2.50 S	2.10 S	1.775 N	2.20 N	+0.80 N	4.35
RAWSON CIRCUIT	1.00 W	2.95 E	2.50 E	2.10 E	1.775 W	2.20 W	+0.80 W	4.35
TULSI AVE. LOTS 3304-3307, 3312-3315	1.00 N/S	3.40 N	2.70 N	2.10 N	1.775 S	2.20 S	+0.80 S	6.30
TULSI AVE. LOTS 3316-3317	-	3.40 N	2.70 N	2.10 N	1.775 S	2.20 S	+0.80 S	6.30

\* FROM BACK OF KERB

**TBM SCHEDULE**

I.D.	TYPE	EASTING	NORTHING	LEVEL
243	ROD	292970.124	5800172.240	16.17
247	PM 32	293136.811	5800075.951	22.20
6002	ROD	293152.965	5800132.136	19.94

**NOTE: PARKING BAYS**  
 WHERE APPLICABLE PARKING BAYS TO NEATLY MATCH AND TRANSITION INTO CROSSOVERS AS NOMINATED ON DP01-DP03. ALL OTHER PARKING BAYS ARE TO BE CONSTRUCTED IN ACCORDANCE WITH TD02.

**NOTE:**  
 TBM'S No. 6002 & 247 ARE SHOWN IN DRG. No. 10933SP01, SHEET No. 05.

**NOTE: EXISTING SURFACE LEVELS**  
 ALL EXISTING SURFACE LEVELS SHOWN ON THIS PLAN ARE PRIOR TO THE COMMENCEMENT OF PERMIT & BULK EARTHWORKS DCE JOB NUMBER 108681.

**NOTE: END OF PAVEMENT WORKS**  
 CONCRETE EDGE STRIP AND AG DRAIN TO BE INSTALLED TO THE END OF ALL PAVEMENT WORKS.

**NOTE: EXISTING SERVICES**  
 ALL EXISTING SERVICES UNDER NEW AND PROPOSED ROAD PAVEMENT, FOOTPATH AND DRIVEWAYS TO BE FCR BACKFILLED.

**NOTE: EXISTING STRUCTURES**  
 ALL EXISTING DRAINAGE PITS AND SEWER STRUCTURES WITHIN NEW WORKS ARE TO BE ADJUSTED TO MATCH NEW FINISHED SURFACE LEVELS.

**NOTE: TACTILE PAVING**  
 TACTILE GROUND SURFACE INDICATORS (TGS'IS) ARE SHOWN INDICATIVELY AND SHOULD BE CONSTRUCTED IN ACCORDANCE WITH AS/NZS 1428.4:2009.

**BEWARE!**  
 NBN OPTIC FIBRE CABLES IN THE VICINITY OF WORKS. TEL: 1800 687 626.

**BEWARE!**  
 TELSTRA OPTIC FIBRE CABLES IN THE VICINITY OF WORKS. TEL: 9253 8263.

**WARNING!**  
 THE LOCATION OF EXISTING SERVICES SHOWN ON THESE PLANS MUST BE PROVEN ON SITE, THE APPROPRIATE AUTHORITY MUST BE CONTACTED AND THE SERVICES LOCATED PRIOR TO COMMENCEMENT OF ANY WORKS.

**DANGER!**  
 OVERHEAD ELECTRICITY TRANSMISSION LINES. CONTRACTOR TO EXERCISE EXTREME CAUTION WHEN OPERATING IN THE VICINITY OF THESE LINES. THE CONTRACTOR MUST ADHERE TO ALL "NO GO ZONE" REQUIREMENTS OF THE POWER AUTHORITY.

**CAUTION!**  
 TELSTRA MAJOR CABLES ARE IN THE VICINITY OF WORKS.

**BEWARE!**  
 DEVELOPMENT VICTORIA FTTH OPTIC FIBRE CABLES IN THE VICINITY OF WORKS. TEL: 03 9311 4575.

**WARNING!**  
 NO DRAINAGE WORKS SHALL COMMENCE UNTIL THE CONTRACTOR CONFIRMS THE I.L. OF ALL EXISTING DRAINS, AND CONFIRMS IN WRITING WITH THE ENGINEERING SUPERVISOR.

**WARNING!**  
**BEWARE OF ASBESTOS!**  
 SOME UNDERGROUND SERVICES MAY BE CONSTRUCTED FROM ASBESTOS CONTAINING MATERIAL. CONTACT THE SUPERINTENDENT FOR INSTRUCTIONS ON HOW TO MANAGE ANY POTENTIAL ASBESTOS HAZARD.

Drawing File: C:\124\_Synergy\delta\delta\ENERGY-ME\10933-Afterwork - Stage 33\_1786\1\_DESIGN\01\_ACAD\04\_A1A3\_10933DP01.dwg - DP03  
 Date/Time: Wed Apr 13, 2022 - 1:00pm - mrdm--

Drawn: B. SHADE  
 Date: 18/03/21  
 AN 1271316  
 Designed: K. LIM WAN  
 Date: 09/12/20  
 AN 2861068  
 Checked: J. HOLLAND  
 Date: 22/01/21  
 AN 972433  
 Approved: T. LIAKOPOULOS  
 Date: 13/04/22  
 AN 889339  
 © Dalton Consulting Engineers Pty Ltd

**LEGEND**

— Ex W —	EX. WATER MAIN	— E —	ELECTRICITY	— SW —	SW DRAIN & PIT	— EX. TREE TO REMAIN	ACQUATIC WALL (BY OTHERS)
— Ex RW —	EX. REC. WATER MAIN	— OF —	OPTIC FIBRE	— H —	HOUSE DRN   PROP. INLET	— TURN AREA	
— Ex G —	EX. GAS MAIN	— G —	GAS	— FS21.650 —	FINISHED SURFACE LEVEL	— FILLING OVER 300mm	
— Ex E —	EX. ELECTRICAL CABLE	— W —	WATER	— ES20.06 —	EX. SURFACE LEVEL	— ASPHALT PAVEMENT	
— Ex D —	EX. DRAIN & PIT	— RW —	RECYCLED WATER	— TOB21.650 —	TOP OF BATTER LEVEL	— CONCRETE SHARED PATH	
— Ex OF —	EX. OPTIC FIBRE	— GC —	DW/NDW/GAS CONDUITS	— L —	LIMIT OF WORKS	— CONCRETE PATH   D'WAY	
— Ex S —	EX. SEWER MAIN & MH	— R —	REGRADE LOT AT MIN 1 IN 150	— S —	SIGNAGE	— CONCRETE PARKING BAY	
— S —	SEWER MAIN & MANHOLE	— O —	OVERLAND FLOW	— PSM   TBM			

Coords: MGA Levels: AHD  
  
  
 Scale @ A1/A3 1:250 / 1:500

**RIVERWALK**  
 STAGE 33  
 GEELONG ROAD, WERRIBEE  
 WYNDHAM CITY COUNCIL  
 DETAIL PLAN  
 SHEET 03 OF 03  
 Drawing No. 10933DP03  
 Sheet No. 08 of 52

**DALTON CONSULTING ENGINEERS**  
 VICTORIA  
 T 61 3 9813 7400  
 W dceng.com.au  
 QUEENSLAND  
 T 61 7 3374 9000  
 E info@dceng.com.au  
**CONSTRUCTION**