

STREET NAME	GAS		WATER (NDW)		WATER (DW)		OPTIC FIBRE (DS)		ELECTRICITY		EXISTING SEWER	
	SIDE	OFFSET	SIDE	OFFSET	SIDE	OFFSET	SIDE	OFFSET	SIDE	OFFSET	SIDE	OFFSET
COLDSTREAM AVENUE (EAST)	N	2.25	N	2.75	N	3.25	S	1.90	S	2.40	-	-
COLDSTREAM AVENUE (WEST)	N	2.75	N	3.25	N	3.75	S	2.40	S	2.90	S	1.00
DISTRICT AVENUE	W	2.10	W	2.60	W	3.10	E	0.60	E	1.10	W	1.00
TIMBARRA DRIVE (NORTH)	E	2.10	E	2.60	E	3.10	W	2.40	W	2.90	W	1.00
TIMBARRA DRIVE (SOUTH)	E	2.30	E	2.80	E	3.30	W	2.40	W	2.90	W	1.00
CHARTER ROAD	E	2.25	E	2.75	E	3.25	W	1.90	W	2.40	-	-
ADVENT ROAD	E	2.10	E	2.60	E	3.10	W	1.90	W	2.40	-	-

NOTE:
EXISTING SURFACE LEVELS ARE
PRIOR TO FILL PLACED. SURVEY
FILES TO BE PROVIDED.

BEWARE!!!
TELSTRA OPTIC FIBRE
CABLES IN THE VICINITY
OF WORKS. TEL: 9253 8263

NOTE:
ALL EXISTING SERVICES UNDER NEW
AND PROPOSED ROAD PAVEMENT,
FOOTPATH AND DRIVEWAYS TO BE
FCR BACKFILLED.

WARNING!
THE LOCATION OF EXISTING SERVICES SHOWN
ON THESE PLANS MUST BE PROVEN ON SITE,
THE APPROPRIATE AUTHORITY MUST BE
CONTACTED AND THE SERVICES LOCATED PRIOR
TO COMMENCEMENT OF ANY WORKS.

NOTE:
ALL EX PIT & MH WITHIN NEW WORKS
TO BE ADJUSTED TO MATCH NEW
FINISHED SURFACE LEVELS

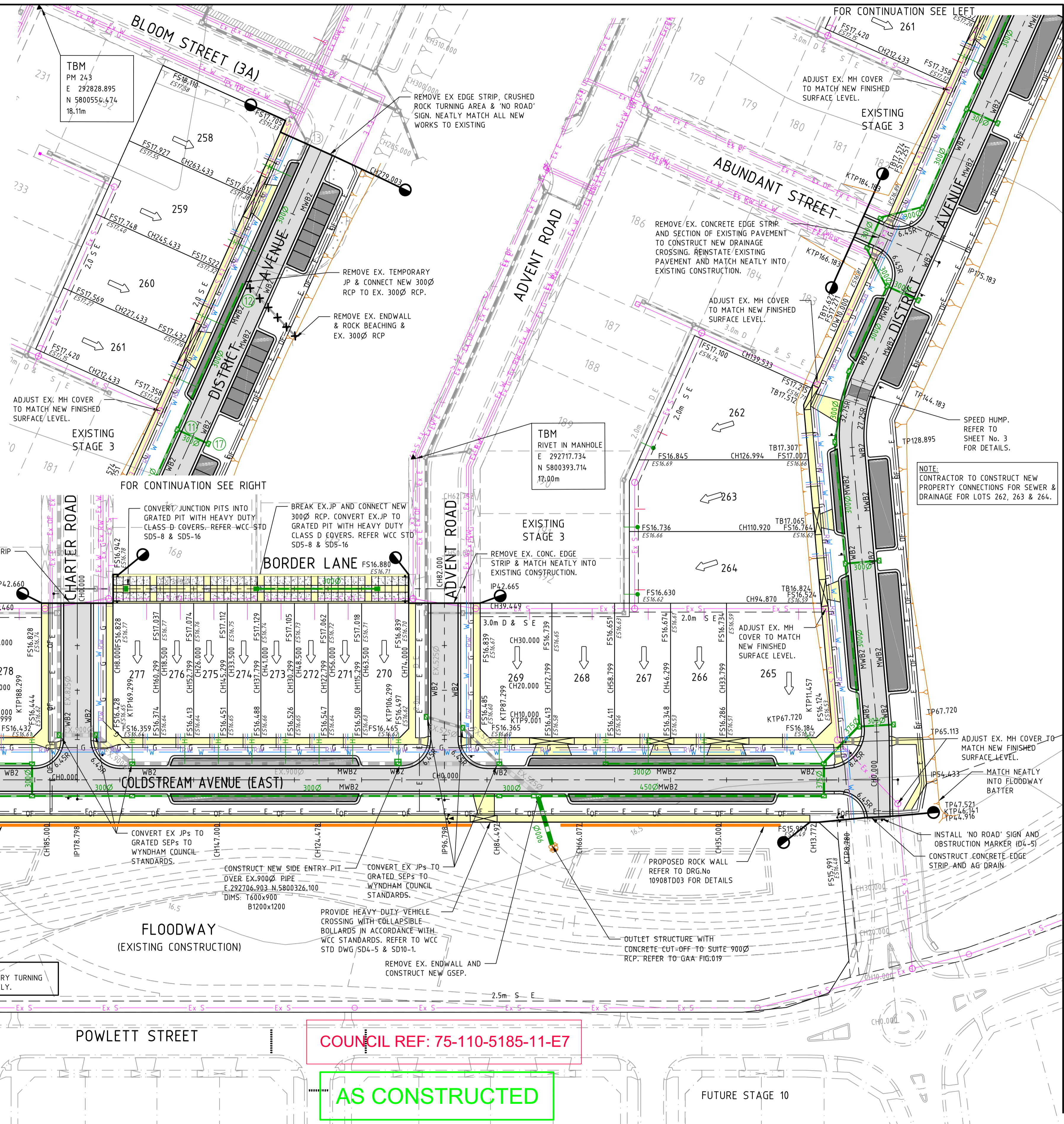

COUNCIL REF: 75-110-5185-11-E7

AS CONSTRUCTED

Drawing File: C:\projects\10908DP01\10908DP01-10908DP01-riverwalk stage 7\Acad\10908DP01.dwg - 10/08/2015 1:58pm - Byron Shire

REV	AMENDMENTS	DATE	APP'D
3	AS CONSTRUCTED	27/03/15	TL
2	PORPHYRY STONE ADDED	25/11/14	TL
1	CONSTRUCTION ISSUE	30/06/14	TL
0	CONSTRUCTION ISSUE	13/06/14	TL

Drawn MR Date 03/06/13
Designed JB
Date 03/06/13
AN 341029
Verified LT
Date 04/06/13
AN 431122
Audited RCM
Date 19/05/14
AN 641914
Approved TL
Date 13/06/14
AN 882751
Written dimensions to take precedence over scale.
Contractor shall check and verify all dimensions on site.
Discrepancies to be brought to the attention of the Superintendent.

- Ex W - EXISTING WATER MAIN
- Ex G - EXISTING GAS MAIN
- Ex E - EXISTING ELECTRICAL CABLE
- Ex S - EXISTING SEWER MAIN & MANHOLE
- Ex T - EXISTING TELECOMM. CABLE AND PIT
- H - HOUSE DRAIN
- GC - GAS CONDUIT
- W - WATER CONDUIT
- RW - RECYCLED WATER CONDUIT
- TC - TELECOMM. CONDUIT
- OF - OPTIC FIBRE
- PM - PERMANENT SURVEY MARK
- TB - TEMPORARY BENCH MARK
- S - SEWER MAIN AND MANHOLE
- SD - STORMWATER DRAIN & PIT
- SW - SW DRAIN & PIT CONSTRUCTED IN PREVIOUS STAGES
- PI - PROPERTY INLETS
- H - HOUSE DRAIN
- GC - GAS CONDUIT
- W - WATER CONDUIT
- RW - RECYCLED WATER CONDUIT
- TC - TELECOMM. CONDUIT
- OF - OPTIC FIBRE
- PM - PERMANENT SURVEY MARK
- TB - TEMPORARY BENCH MARK
- S - SEWER MAIN AND MANHOLE
- SD - STORMWATER DRAIN & PIT
- SW - SW DRAIN & PIT CONSTRUCTED IN PREVIOUS STAGES
- PI - PROPERTY INLETS
- H - HOUSE DRAIN
- GC - GAS CONDUIT
- W - WATER CONDUIT
- RW - RECYCLED WATER CONDUIT
- TC - TELECOMM. CONDUIT
- OF - OPTIC FIBRE
- PM - PERMANENT SURVEY MARK
- TB - TEMPORARY BENCH MARK
- S - SEWER MAIN AND MANHOLE
- SD - STORMWATER DRAIN & PIT
- SW - SW DRAIN & PIT CONSTRUCTED IN PREVIOUS STAGES
- PI - PROPERTY INLETS
- H - HOUSE DRAIN
- GC - GAS CONDUIT
- W - WATER CONDUIT
- RW - RECYCLED WATER CONDUIT
- TC - TELECOMM. CONDUIT
- OF - OPTIC FIBRE
- PM - PERMANENT SURVEY MARK
- TB - TEMPORARY BENCH MARK
- S - SEWER MAIN AND MANHOLE
- SD - STORMWATER DRAIN & PIT
- SW - SW DRAIN & PIT CONSTRUCTED IN PREVIOUS STAGES
- PI - PROPERTY INLETS
- H - HOUSE DRAIN
- GC - GAS CONDUIT
- W - WATER CONDUIT
- RW - RECYCLED WATER CONDUIT
- TC - TELECOMM. CONDUIT
- OF - OPTIC FIBRE
- PM - PERMANENT SURVEY MARK
- TB - TEMPORARY BENCH MARK
- S - SEWER MAIN AND MANHOLE
- SD - STORMWATER DRAIN & PIT
- SW - SW DRAIN & PIT CONSTRUCTED IN PREVIOUS STAGES
- PI - PROPERTY INLETS
- H - HOUSE DRAIN
- GC - GAS CONDUIT
- W - WATER CONDUIT
- RW - RECYCLED WATER CONDUIT
- TC - TELECOMM. CONDUIT
- OF - OPTIC FIBRE
- PM - PERMANENT SURVEY MARK
- TB - TEMPORARY BENCH MARK

- W - WATER
- RW - RECYCLED WATER
- T - TELECOMMUNICATIONS
- E - ELECTRICITY
- G - GAS
- R - REGRADE LOT AT MIN 1 IN 150 ASPHALT PAVEMENT
- C - CHARCOAL COLOURED PAVEMENT
- P - PORPHYRY STONE PAVEMENT
- F - CONC FOOTPATH / DRIVEWAY
- L - LANDSCAPING
- F - FILLING OVER 300mm
- S - FINISHED SURFACE CONTOUR

- S - SEWER MAIN AND MANHOLE
- SD - STORMWATER DRAIN & PIT
- SW - SW DRAIN & PIT CONSTRUCTED IN PREVIOUS STAGES
- PI - PROPERTY INLETS
- H - HOUSE DRAIN
- GC - GAS CONDUIT
- W - WATER CONDUIT
- RW - RECYCLED WATER CONDUIT
- TC - TELECOMM. CONDUIT
- OF - OPTIC FIBRE
- PM - PERMANENT SURVEY MARK
- TB - TEMPORARY BENCH MARK
- S - SEWER MAIN AND MANHOLE
- SD - STORMWATER DRAIN & PIT
- SW - SW DRAIN & PIT CONSTRUCTED IN PREVIOUS STAGES
- PI - PROPERTY INLETS
- H - HOUSE DRAIN
- GC - GAS CONDUIT
- W - WATER CONDUIT
- RW - RECYCLED WATER CONDUIT
- TC - TELECOMM. CONDUIT
- OF - OPTIC FIBRE
- PM - PERMANENT SURVEY MARK
- TB - TEMPORARY BENCH MARK

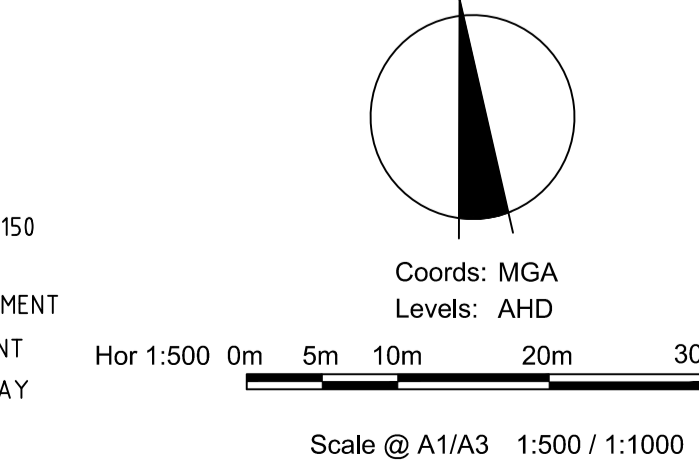

Places Victoria
RIVERWALK - STAGE 7
GEELONG ROAD
DETAIL PLAN
Drawing No. 10908DP01 Rev 3
Sheet No. 05 AS CONSTRUCTED
© Dalton Consulting Engineers Pty Ltd
ABN 78 429 221 048

DCE
dalton consulting engineers
255 Whitehorse Road
PO Box 349
Balwyn Victoria 3103
Australia
T 61 3 9888 6866
F 61 3 9888 6880
E info@dceprofile.com
W www.dceprofile.com