

Memorandum of Common Provisions

Section 91A Transfer of Land Act 1958

AA2463

07/07/2014

\$58.30

MCP



Lodged by

Name: **K&L Gates**
Phone: (613) 9205 2000
Address: Level 25, Rialto South Tower
525 Collins Street
Melbourne VIC 3000
Reference: MMCK.JTL.7380628.01668(RW_s8)
Customer Code: 1255H

This memorandum (containing 17 pages) contains provisions which are intended for inclusion in instruments and plans to be subsequently lodged for registration.

Provisions

1. RECITALS

- 1.1. This MCP has been prepared by Places Victoria in order to regulate the siting, form and design of the residential development in accordance with the requirement to ensure a high level of amenity for owners and residents of the allotments within the Plan of Subdivision.
- 1.2. The provisions of this MCP are incorporated into a restriction created by the Plan of Subdivision.
- 1.3. This MCP provides details of approved building envelopes.
- 1.4. This MCP provides information necessary to interpret the approved building envelopes.
- 1.5. The MCP imposes restrictions on the design and siting of buildings which in some cases may be different to those in the Building Regulations. In some cases the restrictions in this MCP may be stricter than the Building Regulations, and in other cases, the siting restrictions may be contrary to the Building Regulations.
- 1.6. Where the siting restrictions in this MCP are contrary to regulations 409, 411, 414, 415, 416 and 420 of the Building Regulations, no consent and report of the relevant council is required, as this MCP has been prepared with regard to regulation 406 of the Building Regulations.
- 1.7. Some matters addressed in this MCP are not covered by the Building Regulations.

2. DEFINITIONS

- 2.1 'Approved Building Envelope' means the building envelope shown for a particular allotment in the attached Building Envelopes Plan and has the same meaning as in regulation 402 of the Building Regulations.
- 2.2 'Building' has the same meaning as in the Building Act.
- 2.3 'Building Act' means the Building Act 1993 as amended from time to time.
- 2.4 'Building Envelopes Plan' means the plan that forms part of this MCP and which shows the Approved Building Envelopes and other related matters for the lots within the Plan of Subdivision.
- 2.5 'Building Envelope Profiles' means the profile section plans relevant to the Building Envelope. The applicable building envelope profile sections are marked on the Building Envelope Plan.
- 2.6 'Building Permit' means a building permit in terms of the Building Act.

15781210A

MCP

1. The provisions are to be numbered consecutively from number 1.
2. Further pages may be added but each page should be consecutively numbered.
3. To be used for the inclusion of provisions in instruments and plans.

Page 1 of 17

THE BACK OF THIS FORM MUST NOT BE USED

AA2463

07/07/2014

\$58.30

MCP



-
- 2.7 **'Building Regulations'** means the Building Regulations 2006 or any subsequent regulations made pursuant to the Building Act which regulate the siting of a Building.
 - 2.8 **'Dwelling'** means a building and any associated outbuildings (including garages and carports) used for the purposes of a single domestic residence.
 - 2.9 **'Finished Surface Level'** means the finished surface level of the ground at the time of registration of the Plan of Subdivision.
 - 2.10 **'Front Street'** means the street or road which forms the frontage to the lot concerned. Where there is more than one road which adjoins a lot or where it may otherwise be unclear, the Front Street is identified by the location of the vehicular crossover to the lot on the building envelope plan.
 - 2.11 **'Garage'** means a domestic garage or a domestic carport constructed primarily for the purpose of storage of motor vehicles, trailers, caravans, campervans, boats and the like.
 - 2.12 **'Habitable Room'** has the same meaning as in the Building Code of Australia.
 - 2.13 **'MCP'** means this Memorandum of Common Provisions.
 - 2.14 **'Places Victoria'** means the Urban Renewal Authority Victoria created pursuant to the Urban Renewal Authority Victoria Act 2003.
 - 2.15 **'Plan of Subdivision'** means the relevant plan of subdivision for a particular allotment which incorporates this MCP.
 - 2.16 **'Riverwalk Residential Design Controls'** means the Riverwalk Design Standards (and associated referenced documents) prepared by Places Victoria, as amended from time to time.
 - 2.17 **'Setback'** means the shortest horizontal distance from a particular boundary or building to another boundary or building (excepting matters specifically referred to in this MCP).
 - 2.18 **'Side Street'** means a street or road which abuts an allotment other than a Front Street.

3. SITING AND DESIGN

3.1 Exemption from the need for the Consent and Report of the relevant Council

The restriction in the Plan of Subdivision which incorporates this MCP exempts a design from requiring the consent and report of the relevant council with regard to a design which does not comply with the Building Regulations in respect of the following:

- 3.1.1 Minimum Street Setback (regulation 409);
- 3.1.2 Site Coverage (regulation 411);
- 3.1.3 Side Setback and rear Setback (regulation 414);
- 3.1.4 Walls on boundaries (regulation 415);
- 3.1.5 Daylight to existing Habitable Room windows (regulation 416); and
- 3.1.5 Daylight to Habitable Room windows (regulation 420).

3.2 Approved Building Envelopes

A Building (other than a boundary fence or other specific tolerable encroachments pursuant to this MCP) must be sited within the Approved Building Envelope and Building Envelope Profiles.

The siting of a building within the Approved Building Envelope is subject to any further restriction or modification imposed by this MCP or any other applicable control.



3.3 Building Envelope Profiles

The heights specified with the Building Envelope Profiles are to be taken from the relevant spot "Finished Surface Level" of the site.

Maximum building heights between specified points on a Setback profile lie on a straight line drawn between two specified points within a profile.

The delineation of the profiles is demonstrated on the Building Envelopes plans.

The Building Envelope Profiles are defined only by means of the side Setbacks of the Building Envelope.

Rear Setback are to accord with the specifications outlined in Table 414 of the Building Regulations.

3.4 Minimum Front and Side Street Setbacks

No Dwelling shall be Setback from the Front Street less than 3.0 metres and Side Street less than 1.0 metre.

3.5 Encroachments into Front Street Setback

The following may impose beyond the Approved Building Envelope and Building Envelope Profiles and encroach in to a Front Setback by not more than 1.50 metres:

- 3.5.1 A porch;
- 3.5.2 A verandah;
- 3.5.3 A portico;
- 3.5.4 A pergola;
- 3.5.5 A masonry chimney;
- 3.5.6 A sunblind;
- 3.5.7 A flue or pipe; and
- 3.5.8 Decks, steps or landings less than 800 millimetres in height.

None of the above structures may be greater than 6.5 metres in height.

Eaves (including fascias and gutter) may encroach into a Front Street or Side Street Setback by not more than 500 millimetres provided a 500 millimetre gap is retained between the boundary and gutter.

Domestic water tanks, domestic fuel storage tanks, hot water storage tanks and heating/cooling equipment may encroach into a Front Street or Side Street Setback by not more than 500 millimetres.

3.6 Encroachments into side and rear Setback

3.6.1 The following may impose beyond the Approved Building Envelope and Building Envelope Profiles and encroach in to a side or rear Setback by not more than 500 millimetres:

- (a) A porch or verandah;
 - (b) A masonry chimney;
 - (c) A sunblind;
 - (d) A screen which prevents direct overlooking;
 - (e) A flue or pipe;
 - (f) A domestic fuel tank;
 - (g) Heating and cooling equipment or other services; and
-

AA2463

07/07/2014 \$58.30 MCP



(h) An eave (including fascias and gutter).

3.6.2 The following may impose beyond the Approved Building Envelope and Building Envelope Profiles and encroach in to a side or rear Setback:

- (a) A landing with an area of not more than 2.0 metres and which is less than 800 millimetres in height above "Finished Surface Level";
- (b) An unroofed stairway or ramp;
- (c) A pergola;
- (d) Shade sails; and
- (e) A domestic watertank.

3.7 Site Coverage

The site coverage of:

3.7.1 front loaded buildings must not occupy more than 70% of an allotment; and

3.7.2 side or rear loaded buildings must not occupy more than 75% of an allotment.

3.8 Walls on boundaries

Where a Building Envelope allows construction of a building on the boundary of the lot, a wall or carport on the boundary may have a maximum length equivalent to the length of the envelope abutting the boundary (subject to the Building providing an adequate Garage Setback as required by Clause 3.12). The height of a wall or carport must not exceed a maximum height of 3.6 metres. The average height of a wall or carport may be a maximum of 3.6 metres.

3.9 Daylight to Habitable Room windows

A Habitable Room window of a Building on an allotment must face an outdoor space or light court with a minimum dimension of 500 millimetres clear to the sky (not encroached by eaves, fascias and gutters), and not including land on an adjoining allotment.

3.10 Daylight to existing Habitable Room windows

Only where a Building Envelope allows construction on or within 150 millimetres of the boundary may a Building (including eaves, fascias and gutter) be constructed on or within 150 millimetres of the boundary.

In this instance only, Buildings do not have to provide a Setback to accommodate a Habitable Room window in an existing Dwelling.

3.11 One Dwelling on a lot

With the exception of those lots identified with a * and + and marked as "Dual Occupancy Site" or "Medium Density Site" on the "Building Envelopes Plan", only one Dwelling may be erected on a lot within the Plan of Subdivision.

3.12 Front Street Setback of Garages

A Garage must have a Front Street setback from the street of not less than 5.5 metres.

AA2463

07/07/2014 \$58.30 MCP



3.13 Location of Crossovers

The locations of the crossovers are fixed and must not be altered unless explicit consent is granted by Places Victoria or proxy.

3.14 Compliance and Discretion

Places Victoria may in its absolute discretion authorize in writing the siting of a Building which does not comply with the restriction created by the Plan of Subdivision which incorporates this MCP, provided that such siting complies with the requirements of the Building Regulations and / or is subject to the report and consent of the relevant reporting authority in terms of the Building Regulations.

Approval by Places Victoria pursuant to this clause shall only be provided in circumstances where Places Victoria in its absolute discretion considers that the siting is desirable in terms of achieving a better planning outcome in terms of the Riverwalk Residential Design Controls that may otherwise be achieved and will not result in any significant detriment to abutting owners or occupiers.

4. APPROVAL OF HOUSE DESIGN

The explicit approval of the design and siting of a Dwelling to be built on any lot on the Plan of Subdivision must be granted by Places Victoria (or proxy) prior to making a formal application for a Building Permit. The design and siting of a Dwelling must be in accordance with and meet the requirements of the Riverwalk Residential Design Controls.

5. INTERPRETATION

In this MCP, unless the contrary intention appears:

- 5.1 The singular includes the plural and vice versa;
- 5.2 A reference to an individual or person includes a partnership, body corporate, government authority or agency and vice versa;
- 5.3 Words importing one gender include other genders;
- 5.4 Other grammatical forms of defined words or expressions have corresponding meanings;
- 5.5 A reference to a statute, code or other law includes regulations and other instruments made under it and includes consolidations, amendments, re-enactments or replacements of any of them;
- 5.6 A reference to the Riverwalk Residential Design Controls is reference to that document or subsequent or amended documents (whether they are named as such) that are prepared to guide and control the development of land within the Plan of Subdivision;
- 5.7 A reference to an authority, institution, association or body ('original entity') that has ceased to exist or been reconstituted, renamed or replaced or whose powers or functions have been transferred to another entity, is reference to the entity that most closely serves the purposes or objects of the original entity;
- 5.8 Headings and the provision of a table of contents are for convenience only and do not affect the interpretation of this MCP.

AA2463

07/07/2014 \$58.30 MCP

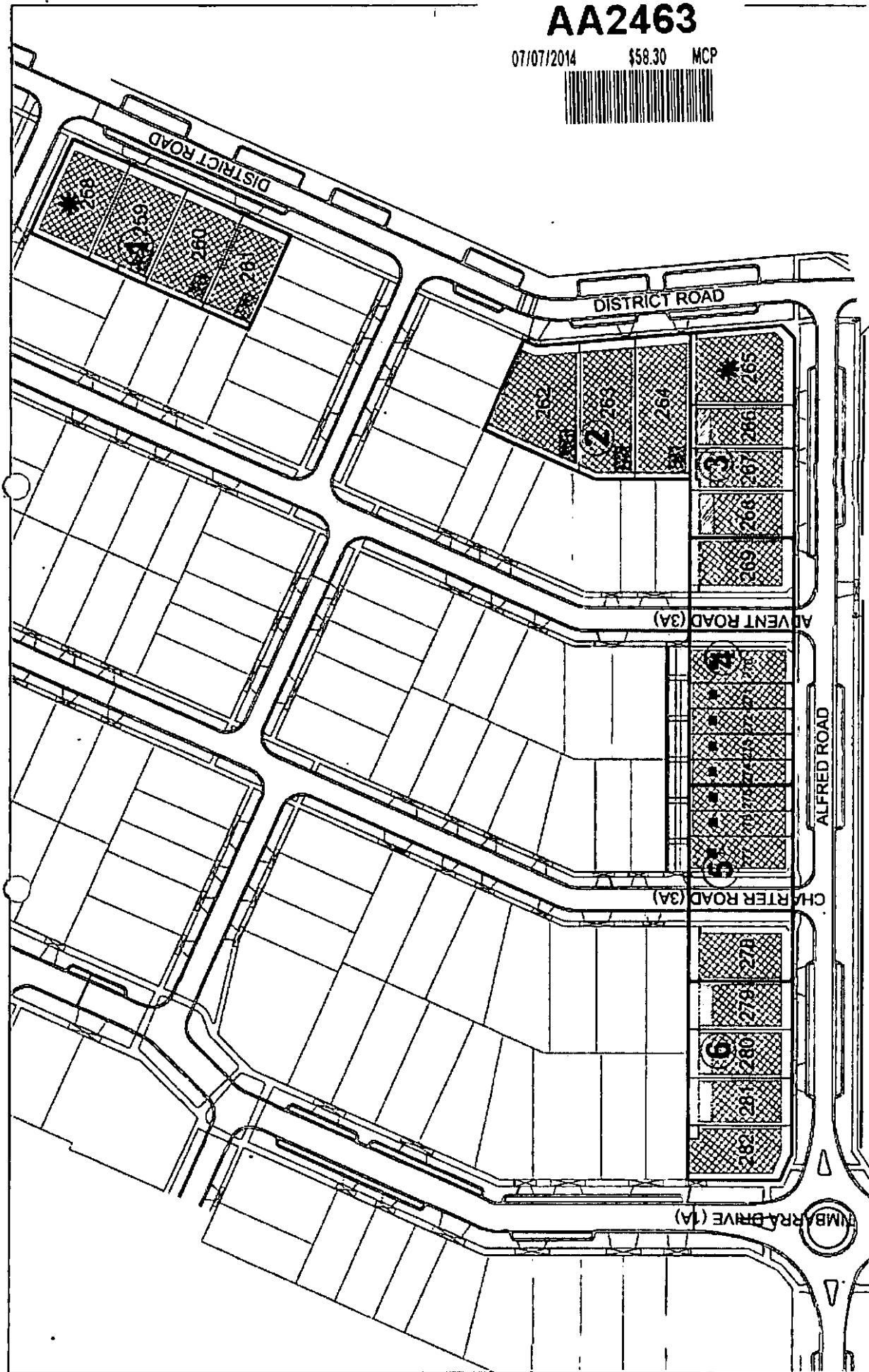

DCE
 DESIGN CONSULTING ENGINEERS
 101 St. James Street
 Melbourne, Victoria 3121
 Australia
 Tel: 03 9594 0000
 Fax: 03 9594 0001
 www.dce.com.au

Places Victoria
 RIVERWALK STAGE 7
 GEELONG ROAD, WERRIBI
 BUILDING ENVELOPE PLANS
 Drawing No. 10888881 Rev B
 Block No. 10888881
 © Design Consulting Engineers Pty Ltd
 All Rights Reserved

Scale: 1:1000
 Date: 07/07/2014
 Author: MCA
 Layout: JAD
 No. 10888881
 Date: 07/07/2014

3
 *
 118

- 3 BUILDING ENVELOPE CORNER PLANS
- * BUILDING ENVELOPE FIRST FLOOR
- 118 BUILDING ENVELOPE FIRST FLOOR RELIEF
- 118 FLOOR AND CEILING
- 118 1:1.5 LATER AND LARGER
- 118 LOT DIMENSIONS

NOT TO BE USED FOR CONSTRUCTION

NO.	REVISIONS	DATE
1	ISSUED FOR CONSTRUCTION	07/07/2014
2	REVISIONS	
3	REVISIONS	

AA2463

07/07/2014 \$58.30 MCP

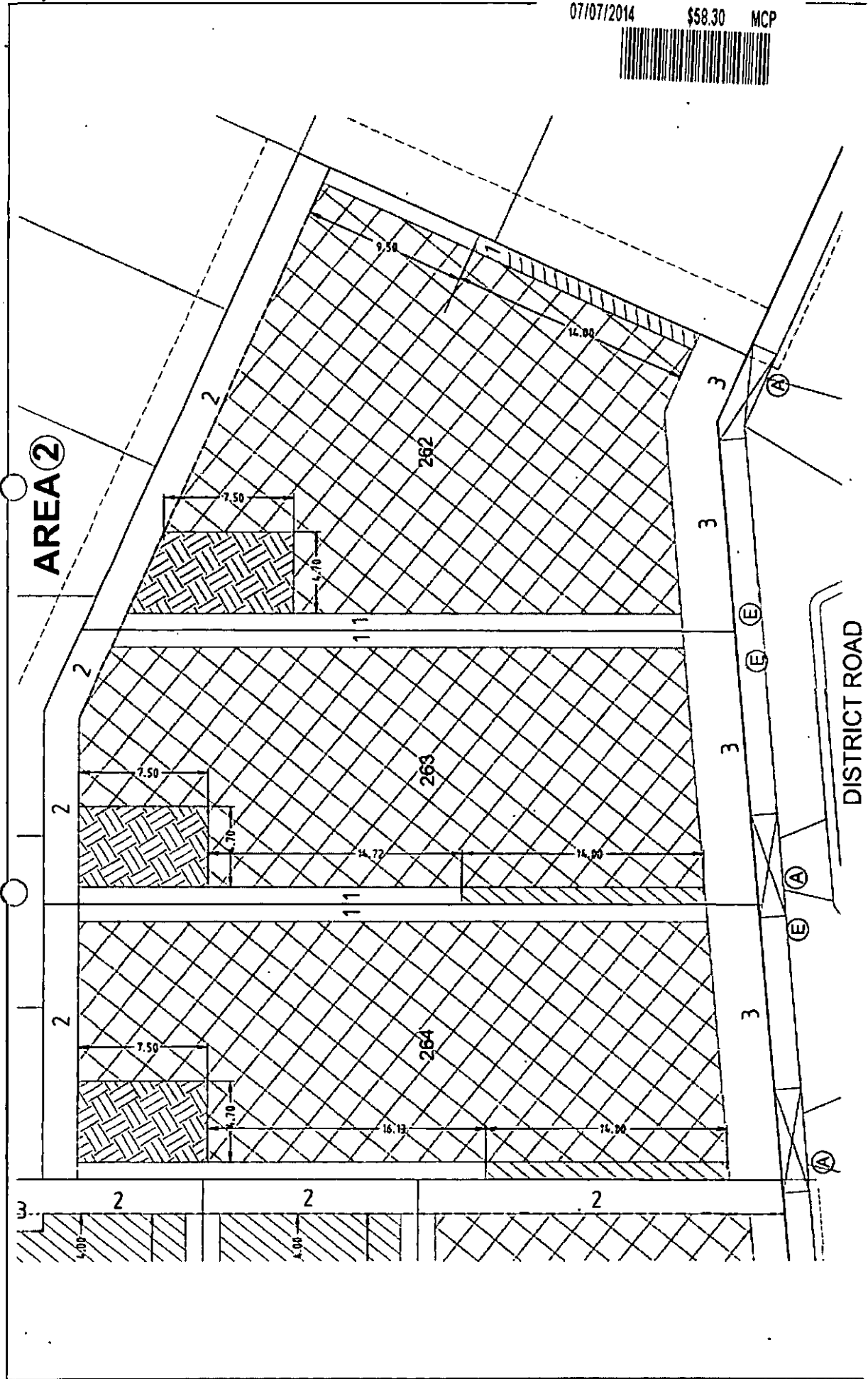

DOE
design consulting engineers

1000 W. Lakeshore Blvd.
Victoria, British Columbia
V8V 1P7
Tel: 250-383-0000
Fax: 250-383-0001
www.doe.ca

Places Victoria
RIVERWALK - STAGE 7
GEOLONG ROAD, WERRIBI
BUILDING ENVELOPE PLANS

Drawing No. 10000103
Sheet No. 03 PRELIMINARY

Scale: 1:100
Date: 07/07/2014

NOT TO BE USED FOR CONSTRUCTION

DATE: 07/07/2014

BY: [Signature]

FOR: [Signature]

LEGEND

- 1. HATCHED AREAS SHALL BE CONSIDERED TO BE AS SHOWN.
- 2. UNHATCHED AREAS SHALL BE CONSIDERED TO BE AS SHOWN.
- 3. UNHATCHED AREAS SHALL BE CONSIDERED TO BE AS SHOWN.
- 4. UNHATCHED AREAS SHALL BE CONSIDERED TO BE AS SHOWN.
- 5. UNHATCHED AREAS SHALL BE CONSIDERED TO BE AS SHOWN.
- 6. UNHATCHED AREAS SHALL BE CONSIDERED TO BE AS SHOWN.
- 7. UNHATCHED AREAS SHALL BE CONSIDERED TO BE AS SHOWN.
- 8. UNHATCHED AREAS SHALL BE CONSIDERED TO BE AS SHOWN.
- 9. UNHATCHED AREAS SHALL BE CONSIDERED TO BE AS SHOWN.
- 10. UNHATCHED AREAS SHALL BE CONSIDERED TO BE AS SHOWN.
- 11. UNHATCHED AREAS SHALL BE CONSIDERED TO BE AS SHOWN.
- 12. UNHATCHED AREAS SHALL BE CONSIDERED TO BE AS SHOWN.
- 13. UNHATCHED AREAS SHALL BE CONSIDERED TO BE AS SHOWN.
- 14. UNHATCHED AREAS SHALL BE CONSIDERED TO BE AS SHOWN.
- 15. UNHATCHED AREAS SHALL BE CONSIDERED TO BE AS SHOWN.
- 16. UNHATCHED AREAS SHALL BE CONSIDERED TO BE AS SHOWN.
- 17. UNHATCHED AREAS SHALL BE CONSIDERED TO BE AS SHOWN.
- 18. UNHATCHED AREAS SHALL BE CONSIDERED TO BE AS SHOWN.
- 19. UNHATCHED AREAS SHALL BE CONSIDERED TO BE AS SHOWN.
- 20. UNHATCHED AREAS SHALL BE CONSIDERED TO BE AS SHOWN.

AA2463

07/07/2014 \$58.30 MCP



AREA 3

DISTRICT ROAD

ALFRED ROAD

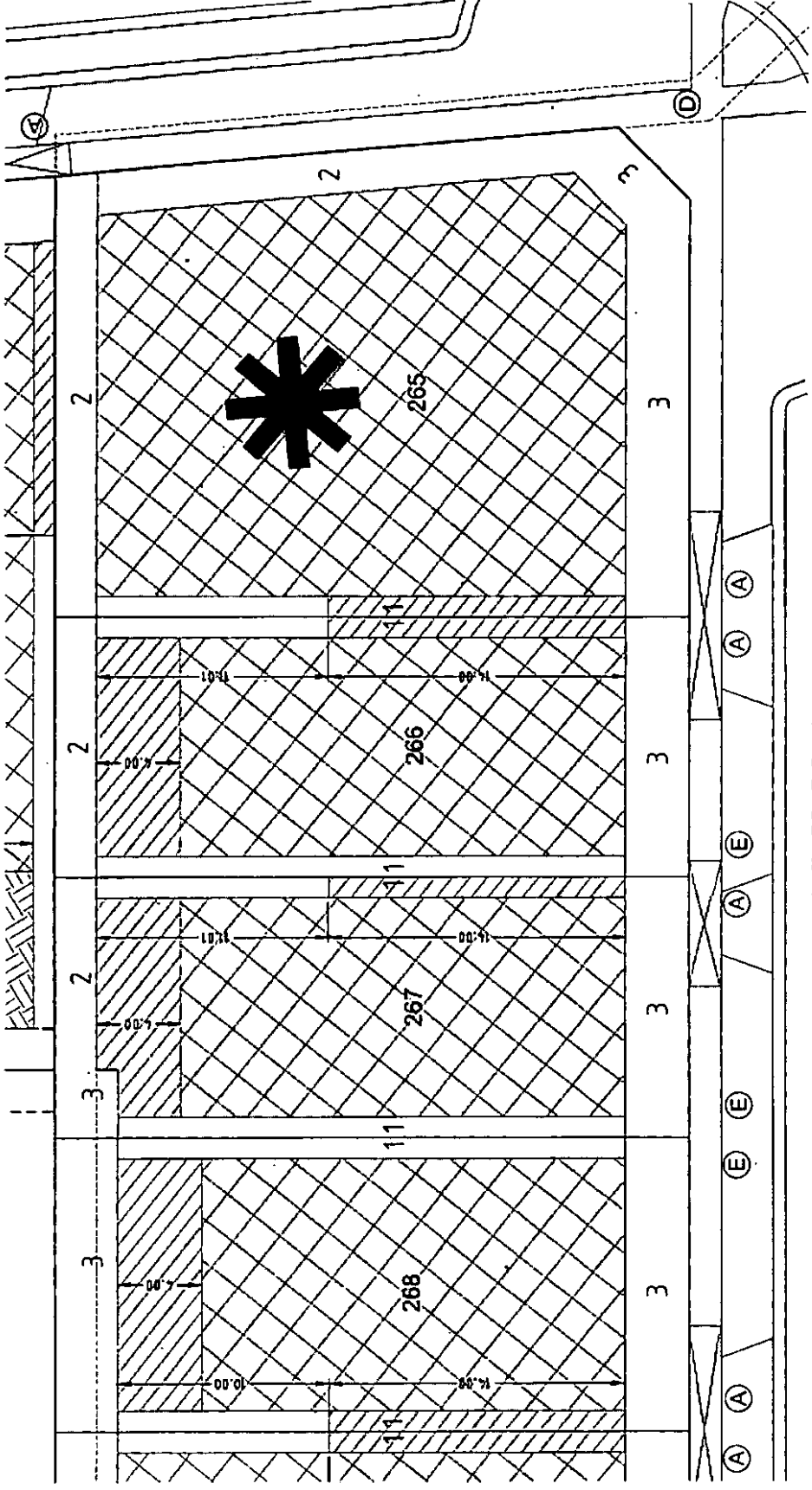

DCE
 DESIGN CONSULTING ENGINEERS
 40 DUNDAS STREET WEST
 SUITE 1000
 TORONTO, ONTARIO M5G 1C5
 TEL: 416-593-8888
 FAX: 416-593-8889
 WWW.DCEENGINEERS.COM

Places Victoria
 RIVERWALK - STAGE 1
 GAZELING ROAD, WERRISBORO
 BUILDING ENVELOPES PLANS
 Drawing No. 10088624
 Scale: As Shown
 Date: 07/07/2014
 Rev: B

North Arrow
 Scale: 1:1000
 Date: 07/07/2014

NOT TO BE USED FOR CONSTRUCTION
 1. MATCH MEMORANDA
 2. ISSUED FOR CONSULTANTS
 3. PRELIMINARY
 4. DESIGN CONSULTING ENGINEERS INC. 10088624

118
 BUILDING ENVELOPE - GENERAL PLANS
 BUILDING ENVELOPE - FRONT ELEVATION
 BUILDING ENVELOPE - REAR ELEVATION
 BUILDING ENVELOPE - SIDE ELEVATION
 1. 1:1 SCALE
 2. 1:1 SCALE
 3. 1:1 SCALE
 4. 1:1 SCALE
 5. 1:1 SCALE
 6. 1:1 SCALE
 7. 1:1 SCALE
 8. 1:1 SCALE
 9. 1:1 SCALE
 10. 1:1 SCALE
 11. 1:1 SCALE
 12. 1:1 SCALE
 13. 1:1 SCALE
 14. 1:1 SCALE
 15. 1:1 SCALE
 16. 1:1 SCALE
 17. 1:1 SCALE
 18. 1:1 SCALE
 19. 1:1 SCALE
 20. 1:1 SCALE
 21. 1:1 SCALE
 22. 1:1 SCALE
 23. 1:1 SCALE
 24. 1:1 SCALE
 25. 1:1 SCALE
 26. 1:1 SCALE
 27. 1:1 SCALE
 28. 1:1 SCALE
 29. 1:1 SCALE
 30. 1:1 SCALE
 31. 1:1 SCALE
 32. 1:1 SCALE
 33. 1:1 SCALE
 34. 1:1 SCALE
 35. 1:1 SCALE
 36. 1:1 SCALE
 37. 1:1 SCALE
 38. 1:1 SCALE
 39. 1:1 SCALE
 40. 1:1 SCALE
 41. 1:1 SCALE
 42. 1:1 SCALE
 43. 1:1 SCALE
 44. 1:1 SCALE
 45. 1:1 SCALE
 46. 1:1 SCALE
 47. 1:1 SCALE
 48. 1:1 SCALE
 49. 1:1 SCALE
 50. 1:1 SCALE
 51. 1:1 SCALE
 52. 1:1 SCALE
 53. 1:1 SCALE
 54. 1:1 SCALE
 55. 1:1 SCALE
 56. 1:1 SCALE
 57. 1:1 SCALE
 58. 1:1 SCALE
 59. 1:1 SCALE
 60. 1:1 SCALE
 61. 1:1 SCALE
 62. 1:1 SCALE
 63. 1:1 SCALE
 64. 1:1 SCALE
 65. 1:1 SCALE
 66. 1:1 SCALE
 67. 1:1 SCALE
 68. 1:1 SCALE
 69. 1:1 SCALE
 70. 1:1 SCALE
 71. 1:1 SCALE
 72. 1:1 SCALE
 73. 1:1 SCALE
 74. 1:1 SCALE
 75. 1:1 SCALE
 76. 1:1 SCALE
 77. 1:1 SCALE
 78. 1:1 SCALE
 79. 1:1 SCALE
 80. 1:1 SCALE
 81. 1:1 SCALE
 82. 1:1 SCALE
 83. 1:1 SCALE
 84. 1:1 SCALE
 85. 1:1 SCALE
 86. 1:1 SCALE
 87. 1:1 SCALE
 88. 1:1 SCALE
 89. 1:1 SCALE
 90. 1:1 SCALE
 91. 1:1 SCALE
 92. 1:1 SCALE
 93. 1:1 SCALE
 94. 1:1 SCALE
 95. 1:1 SCALE
 96. 1:1 SCALE
 97. 1:1 SCALE
 98. 1:1 SCALE
 99. 1:1 SCALE
 100. 1:1 SCALE

AA2463
 07/07/2014 \$58.30 MCP

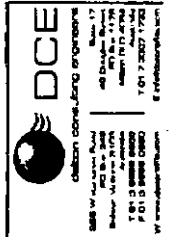
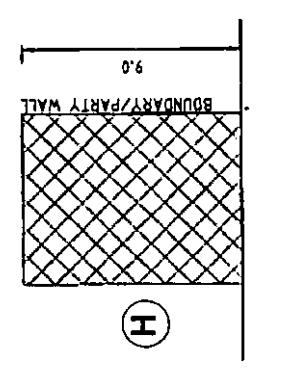
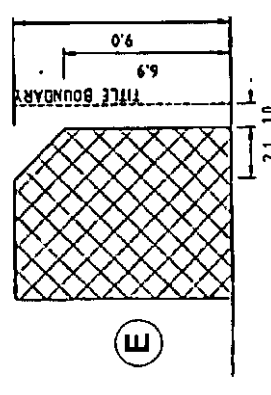
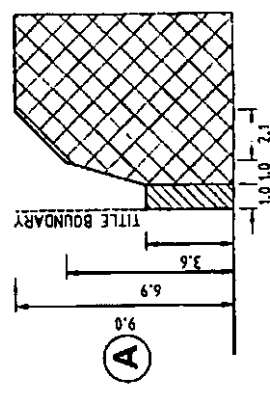
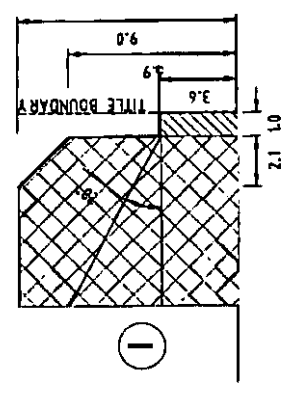
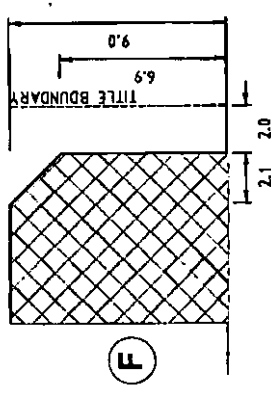
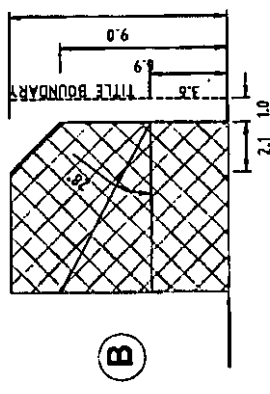
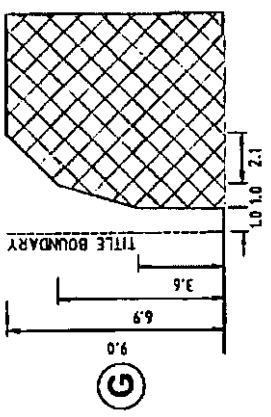
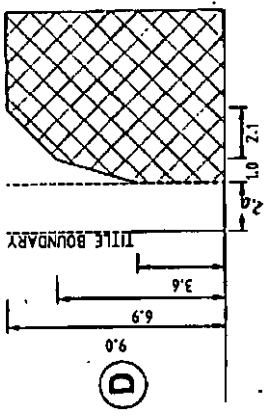

Places Victoria
 RIVERWALK - STAGE 7
 QUEENSLAND ROAD, WERRIBEE
 BUILDING ENVELOPES PLANS

Drawing No. 100000000
 Title No. 000000000
 Drawing Date: 07/07/2014
 Drawing Scale: 1:1000

INDICATE EXISTING BUILDING PLANS
 INDICATE EXISTING EXIST PLANS
 INDICATE EXISTING EXIST PLANS

NOT TO BE USED FOR CONSTRUCTION

REV	DESCRIPTION	DATE	BY
1	ISSUE FOR INFORMATION		
2	ISSUE FOR CONSTRUCTION		

AA2463

07/07/2014

\$58.30

MCP



AREA 1

BENDOC LANE (5A)

TIMBARA DRIVE (1A)

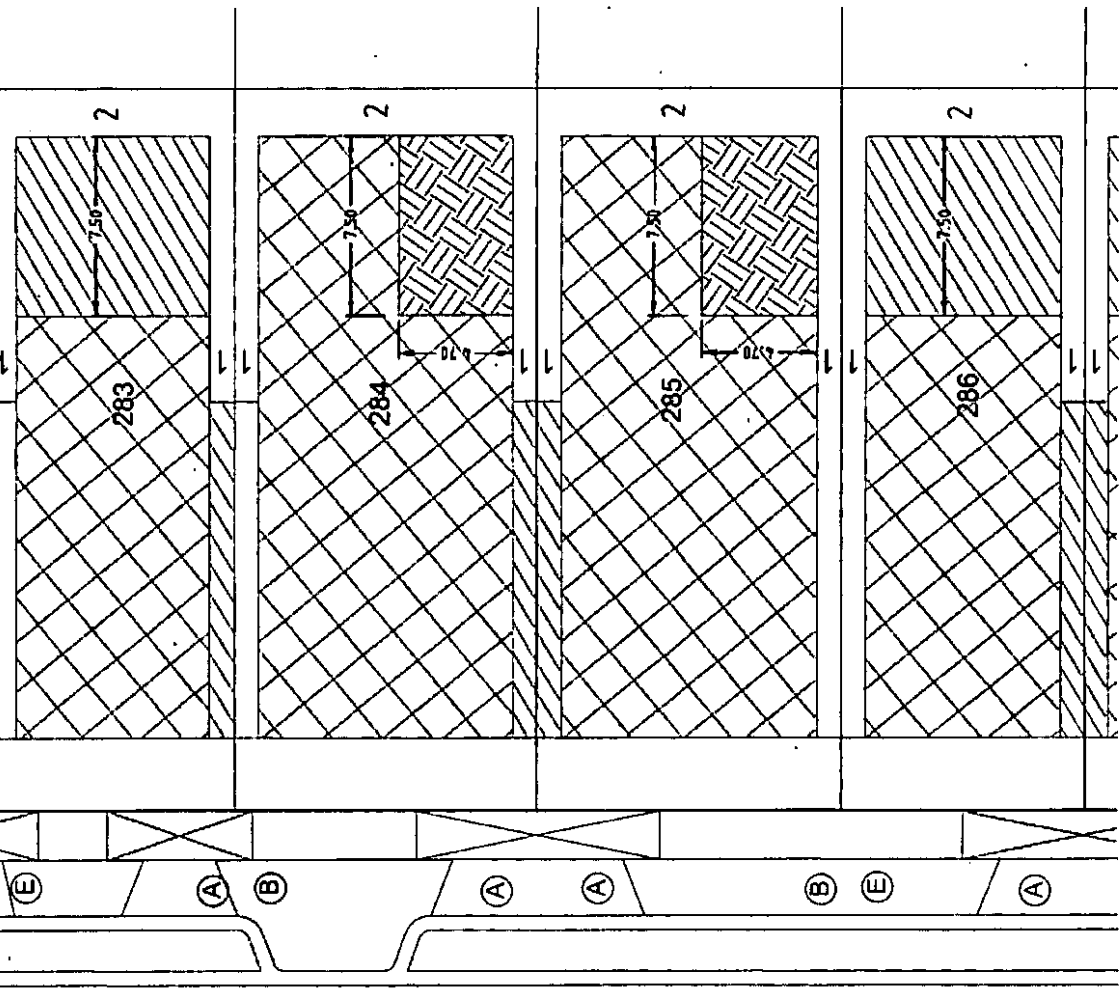

DCE
 DESIGN CONSULTING ENGINEERS
 40 Collins Street
 Melbourne VIC 3000
 T 03 9419 1111
 F 03 9419 1122
 www.dcegroup.com.au

Places Victoria
 RIVERWALK - STAGE 3
 GEELONG ROAD, WERRIBEE
 BUILDING ENVELOPE PLAN
 Drawing No. 16080B02 - Bay B
 Sheet No. 07 - PRELIMINARY
 © Crown Copyright © Geelong Pty Ltd
 10/08/2014

Scale 1:100
 1:100 1:200 1:500 1:1000 1:2000
 North

3
 *
 THESE AREAS SHOWN IN A SHADING ARE TO BE CONSTRUCTED IN THE INSTANTANEOUSLY AVAILABLE MATERIALS AND FINISHES. THE AREA SHALL BE FINISHED TO THE STANDARD OF THE VICITRA CITY COUNCIL.
 1. 1 METRE WIDE LANDSCAPE
 2. 1 METRE WIDE LANDSCAPE
 3. 1 METRE WIDE LANDSCAPE
 4. 1 METRE WIDE LANDSCAPE
 5. 1 METRE WIDE LANDSCAPE
 6. 1 METRE WIDE LANDSCAPE
 7. 1 METRE WIDE LANDSCAPE
 8. 1 METRE WIDE LANDSCAPE
 9. 1 METRE WIDE LANDSCAPE
 10. 1 METRE WIDE LANDSCAPE
 11. 1 METRE WIDE LANDSCAPE
 12. 1 METRE WIDE LANDSCAPE
 13. 1 METRE WIDE LANDSCAPE
 14. 1 METRE WIDE LANDSCAPE
 15. 1 METRE WIDE LANDSCAPE
 16. 1 METRE WIDE LANDSCAPE
 17. 1 METRE WIDE LANDSCAPE
 18. 1 METRE WIDE LANDSCAPE
 19. 1 METRE WIDE LANDSCAPE
 20. 1 METRE WIDE LANDSCAPE
 21. 1 METRE WIDE LANDSCAPE
 22. 1 METRE WIDE LANDSCAPE
 23. 1 METRE WIDE LANDSCAPE
 24. 1 METRE WIDE LANDSCAPE
 25. 1 METRE WIDE LANDSCAPE
 26. 1 METRE WIDE LANDSCAPE
 27. 1 METRE WIDE LANDSCAPE
 28. 1 METRE WIDE LANDSCAPE
 29. 1 METRE WIDE LANDSCAPE
 30. 1 METRE WIDE LANDSCAPE
 31. 1 METRE WIDE LANDSCAPE
 32. 1 METRE WIDE LANDSCAPE
 33. 1 METRE WIDE LANDSCAPE
 34. 1 METRE WIDE LANDSCAPE
 35. 1 METRE WIDE LANDSCAPE
 36. 1 METRE WIDE LANDSCAPE
 37. 1 METRE WIDE LANDSCAPE
 38. 1 METRE WIDE LANDSCAPE
 39. 1 METRE WIDE LANDSCAPE
 40. 1 METRE WIDE LANDSCAPE
 41. 1 METRE WIDE LANDSCAPE
 42. 1 METRE WIDE LANDSCAPE
 43. 1 METRE WIDE LANDSCAPE
 44. 1 METRE WIDE LANDSCAPE
 45. 1 METRE WIDE LANDSCAPE
 46. 1 METRE WIDE LANDSCAPE
 47. 1 METRE WIDE LANDSCAPE
 48. 1 METRE WIDE LANDSCAPE
 49. 1 METRE WIDE LANDSCAPE
 50. 1 METRE WIDE LANDSCAPE
 51. 1 METRE WIDE LANDSCAPE
 52. 1 METRE WIDE LANDSCAPE
 53. 1 METRE WIDE LANDSCAPE
 54. 1 METRE WIDE LANDSCAPE
 55. 1 METRE WIDE LANDSCAPE
 56. 1 METRE WIDE LANDSCAPE
 57. 1 METRE WIDE LANDSCAPE
 58. 1 METRE WIDE LANDSCAPE
 59. 1 METRE WIDE LANDSCAPE
 60. 1 METRE WIDE LANDSCAPE
 61. 1 METRE WIDE LANDSCAPE
 62. 1 METRE WIDE LANDSCAPE
 63. 1 METRE WIDE LANDSCAPE
 64. 1 METRE WIDE LANDSCAPE
 65. 1 METRE WIDE LANDSCAPE
 66. 1 METRE WIDE LANDSCAPE
 67. 1 METRE WIDE LANDSCAPE
 68. 1 METRE WIDE LANDSCAPE
 69. 1 METRE WIDE LANDSCAPE
 70. 1 METRE WIDE LANDSCAPE
 71. 1 METRE WIDE LANDSCAPE
 72. 1 METRE WIDE LANDSCAPE
 73. 1 METRE WIDE LANDSCAPE
 74. 1 METRE WIDE LANDSCAPE
 75. 1 METRE WIDE LANDSCAPE
 76. 1 METRE WIDE LANDSCAPE
 77. 1 METRE WIDE LANDSCAPE
 78. 1 METRE WIDE LANDSCAPE
 79. 1 METRE WIDE LANDSCAPE
 80. 1 METRE WIDE LANDSCAPE
 81. 1 METRE WIDE LANDSCAPE
 82. 1 METRE WIDE LANDSCAPE
 83. 1 METRE WIDE LANDSCAPE
 84. 1 METRE WIDE LANDSCAPE
 85. 1 METRE WIDE LANDSCAPE
 86. 1 METRE WIDE LANDSCAPE
 87. 1 METRE WIDE LANDSCAPE
 88. 1 METRE WIDE LANDSCAPE
 89. 1 METRE WIDE LANDSCAPE
 90. 1 METRE WIDE LANDSCAPE
 91. 1 METRE WIDE LANDSCAPE
 92. 1 METRE WIDE LANDSCAPE
 93. 1 METRE WIDE LANDSCAPE
 94. 1 METRE WIDE LANDSCAPE
 95. 1 METRE WIDE LANDSCAPE
 96. 1 METRE WIDE LANDSCAPE
 97. 1 METRE WIDE LANDSCAPE
 98. 1 METRE WIDE LANDSCAPE
 99. 1 METRE WIDE LANDSCAPE
 100. 1 METRE WIDE LANDSCAPE

118
 119
 120
 121
 122
 123
 124
 125
 126
 127
 128
 129
 130
 131
 132
 133
 134
 135
 136
 137
 138
 139
 140
 141
 142
 143
 144
 145
 146
 147
 148
 149
 150
 151
 152
 153
 154
 155
 156
 157
 158
 159
 160
 161
 162
 163
 164
 165
 166
 167
 168
 169
 170
 171
 172
 173
 174
 175
 176
 177
 178
 179
 180
 181
 182
 183
 184
 185
 186
 187
 188
 189
 190
 191
 192
 193
 194
 195
 196
 197
 198
 199
 200

NOT TO BE USED FOR CONSTRUCTION

REV	DESCRIPTION	DATE
1	ISSUED FOR CONSTRUCTION	07/07/2014
2	REVISIONS	
3	REVISIONS	

AA2463

07/07/2014

\$58.30

MCP



AREA 2

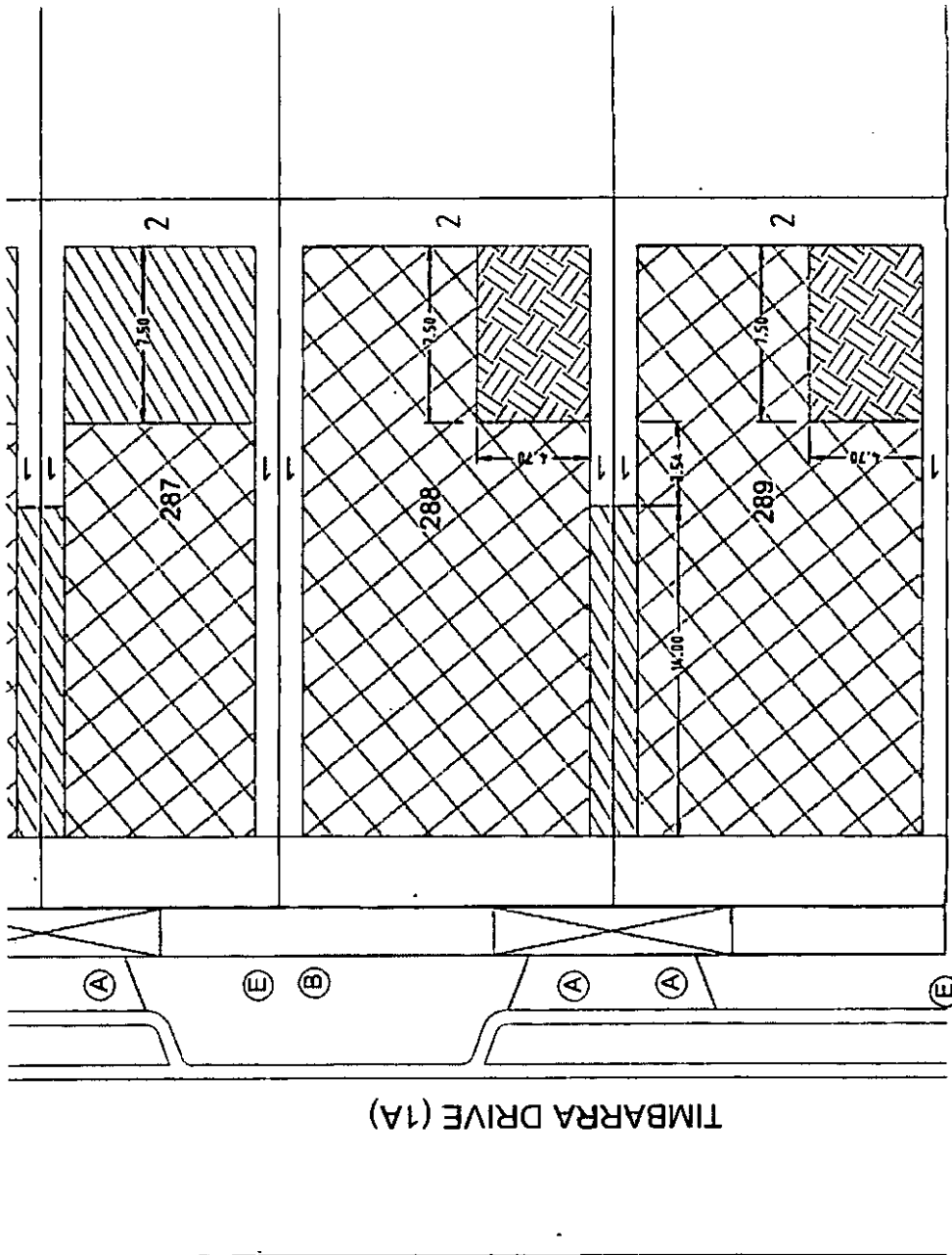

NOT TO BE USED FOR CONSTRUCTION

DATE: 07/07/2014
 DRAWN BY: [Name]
 CHECKED BY: [Name]
 DATE: [Date]
 SCALE: 1:1000
 PROJECT: [Project Name]

LEGEND

- [Hatched Pattern] BUILDING ENVELOPE
- [Cross-hatch Pattern] BUILDING ENVELOPE FIRST FLOOR
- [Diagonal Lines] BUILDING ENVELOPE FIRST FLOOR WALKWAY
- [Dotted Pattern] 1. SITE AND LANDSCAPE
- [Horizontal Lines] 2. SITE AND LANDSCAPE
- [Vertical Lines] 3. SITE AND LANDSCAPE

118

Placed Victoria
 RIVERWALK - STAGE 4
 QUEENSLAND ROAD, WERRIBEE
 BUILDING ENVELOPES PLAN

Drawing No. 100000000
 Sheet No. 05 PRELIMINARY REV B

DCE
 DESIGN CONSULTANTS ENGINEERS
 45 CHURCH STREET
 WERRIBEE VIC 3340
 T 03 9 320 0000
 F 03 9 320 0001
 E info@dce.com.au

3

118

NOT TO BE USED FOR CONSTRUCTION

DATE: 07/07/2014
 DRAWN BY: [Name]
 CHECKED BY: [Name]
 DATE: [Date]
 SCALE: 1:1000
 PROJECT: [Project Name]

LEGEND

- [Hatched Pattern] BUILDING ENVELOPE
- [Cross-hatch Pattern] BUILDING ENVELOPE FIRST FLOOR
- [Diagonal Lines] BUILDING ENVELOPE FIRST FLOOR WALKWAY
- [Dotted Pattern] 1. SITE AND LANDSCAPE
- [Horizontal Lines] 2. SITE AND LANDSCAPE
- [Vertical Lines] 3. SITE AND LANDSCAPE

118

Placed Victoria
 RIVERWALK - STAGE 4
 QUEENSLAND ROAD, WERRIBEE
 BUILDING ENVELOPES PLAN

Drawing No. 100000000
 Sheet No. 05 PRELIMINARY REV B

DCE
 DESIGN CONSULTANTS ENGINEERS
 45 CHURCH STREET
 WERRIBEE VIC 3340
 T 03 9 320 0000
 F 03 9 320 0001
 E info@dce.com.au

AA2463

07/07/2014 \$58.30 MCP

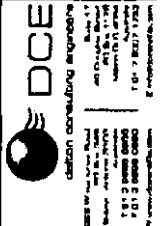

Places Victoria
 RIVERWALK - STAGE 8
 GEELONG ROAD, WERRIBEE
 BUILDING ENVELOPE PLAN

Drawing No. 188828M Rev D
 Sheet No. 18 PRELIMINARY
 © Urban Connections Engineering Pty Ltd
 10/10/2014 11:07:30

Scale: 1:100
 Date: 10/10/2014
 Project: RIVERWALK - STAGE 8
 Drawing: BUILDING ENVELOPE PLAN
 Sheet: 18 PRELIMINARY

INCLUDE EXTERIOR FINISHES
 INCLUDE EXTERIOR FLOOR FINISHES
 INCLUDE EXTERIOR FLOOR FINISHES

NOT TO BE USED FOR CONSTRUCTION

DATE: 10/10/2014
 DRAWN BY: [Name]
 CHECKED BY: [Name]
 APPROVED BY: [Name]

DATE	10/10/2014
DRAWN BY	[Name]
CHECKED BY	[Name]
APPROVED BY	[Name]
PROJECT	RIVERWALK - STAGE 8
DRAWING	BUILDING ENVELOPE PLAN
SHEET	18 PRELIMINARY

