

TABLE OF SERVICES LOCATIONS							
STREET NAME	WATER	ND-WATER	GAS	COMMS	ELEC.	POLES	BOK
GIRI WAY	3.00 N	2.55 N	2.10 N	1.725 S	2.15 S	*0.80 S	4.35
KALINDI STREET	3.00 W	2.55 W	2.10 W	1.725 E	2.15 E	*0.80 E	4.35
RADHIKA STREET	3.00 N	2.55 N	2.10 N	1.725 S	2.15 S	*0.80 S	4.35
PANDAVA ROAD	3.65 N	2.95 N	2.30 N	2.225 S	2.65 S	*0.80 S	4.35

\*BEHIND BACK OF KERB

REFER SHEET No.05 FOR INSET

**WARNING**

**BEWARE OF ASBESTOS**

SOME UNDERGROUND SERVICES MAYBE CONSTRUCTED FROM ASBESTOS CONTAINING MATERIAL. CONTACT THE SUPERINTENDENT FOR INSTRUCTIONS ON HOW TO MANAGE ANY POTENTIAL ASBESTOS HAZARD

**WARNING!** THE LOCATION OF EXISTING SERVICES SHOWN ON THESE PLANS MUST BE PROVEN ON SITE. THE APPROPRIATE AUTHORITY MUST BE CONTACTED AND THE SERVICES LOCATED PRIOR TO COMMENCEMENT OF ANY WORKS.

**NOTE:** ALL EX PIT & MH WITHIN NEW WORKS TO BE ADJUSTED TO MATCH NEW FINISHED SURFACE LEVELS

**BEWARE!!!** TELSTRA OPTIC FIBRE CABLES IN THE VICINITY OF WORKS. TEL: 9253 8263

**CAUTION!!!** TELSTRA MAJOR CABLES ARE IN THE VICINITY OF WORKS

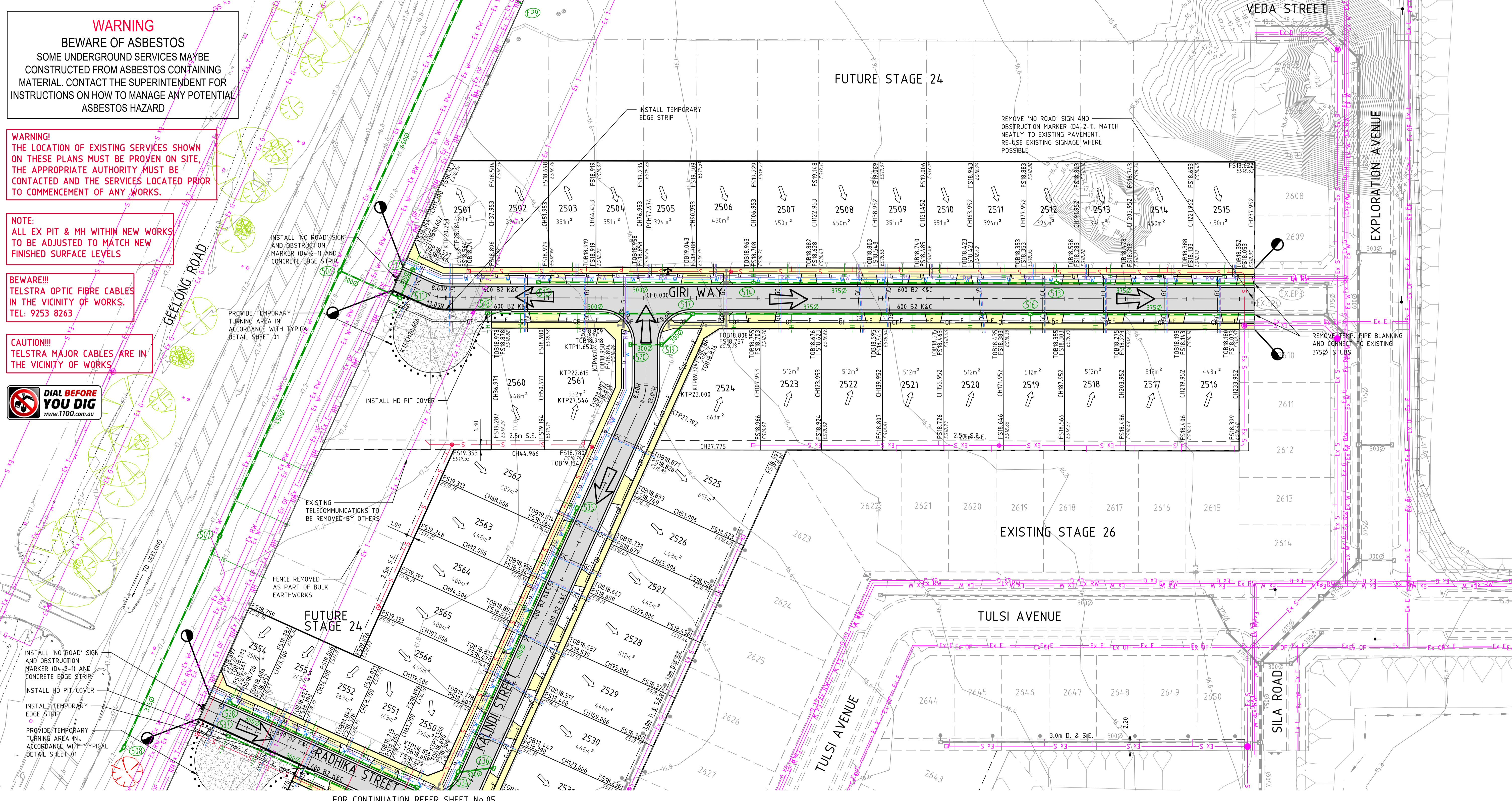

FOR CONTINUATION REFER SHEET No.05

**NOT TO BE USED FOR CONSTRUCTION**

REV	AMENDMENTS	DATE	APPD.
E	COUNCIL COMMENTS (14/12/18)	09/01/18	TL
D	SERVICE ROAD SERVING AMENDMENTS	27/11/18	TL
C	AMENDED PERMIT PLAN	19/10/18	TL
B	STAGING ORDER CHANGED	30/08/18	TL
A	PRELIMINARY ISSUE	20/11/17	TL

Drawn R.YOUNG  
Date 02/08/18  
AN 1991113  
Designed C.LOWE  
Date 30/08/18  
AN 1961199  
Verified R.MONKHOUSE  
Date 24/09/17  
AN 644590  
Approved T.LIAKOPOULOS  
Date 01/10/18  
AN 888445

- LIMIT OF WORKS
- Ex W — EXISTING WATER MAIN
- Ex G — EXISTING GAS MAIN
- Ex E — EXISTING ELECTRICAL CABLE
- Ex S — EXISTING SEWER MAIN & MANHOLE
- Ex T — EXISTING TELECOMM. CABLE AND PIT
- V — EXISTING ELEC. POLE & O'HEAD LINES
- H — EXISTING STORMWATER DRAIN & PIT
- GC — EXISTING CONCRETE PRE DEVELOPMENT
- T — EXISTING TREES
- T — EXISTING TREES TO BE REMOVED
- T — EXISTING TREES REMOVED IN PREVIOUS STAGE
- T — EXISTING SURFACE LEVEL
- T — FINISHED SURFACE LEVEL

**LEGEND**

- S — SEWER MAIN AND MANHOLE
- S — STORMWATER DRAIN & PIT
- S — SW DRAIN & PIT CONSTRUCTED IN PREVIOUS STAGES
- S — PROPERTY INLETS
- H — HOUSE DRAIN
- GC — GAS CONDUIT
- W — WATER CONDUIT
- W — RECYCLED WATER CONDUIT
- T — TELECOMM. CONDUIT
- T — PERMANENT SURVEY MARK
- T — TEMPORARY BENCH MARK
- T — OPEN EARTH DRAIN (O.E.D.)

- W — WATER
- RW — RECYCLED WATER
- T — TELECOMMUNICATIONS
- E — ELECTRICITY
- G — GAS
- S — STREET NAME SIGN
- S — REGRADE LOT AT MIN 1 IN 150
- S — ASPHALT PAVEMENT
- S — CONC FOOTPATH / DRIVEWAY
- S — GEELONG RD ASPHALT PAVEMENT
- S — FILLING OVER 300mm
- S — FINISHED SURFACE CONTOUR

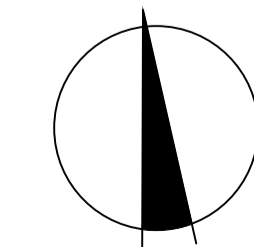

Coords: MGA  
Levels: AHD

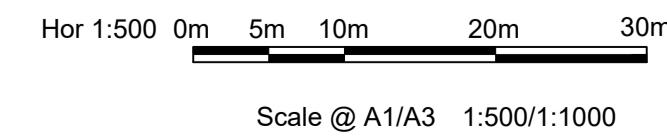

Scale @ A1/A3 1:500/1:1000

**RIVERWALK**  
**STAGE 25**  
**GEELONG ROAD, WERRIBEE**  
**DETAIL PLAN**  
**SHEET 01 OF 02**  
**Drawing No. 10925DP01** Rev E  
Sheet No. 04 **PRELIMINARY**  
© Dalton Consulting Engineers Pty Ltd



**DALTON CONSULTING ENGINEERS**  
ABN 78 429 221 049  
QUEENSLAND  
T 61 7 3374 9000  
E info@dceng.com.au

VICTORIA  
T 61 3 9813 7400  
W dceng.com.au

Drawing File: C:\Users\k103001\OneDrive - merrill\_williams\stage 25\Knot\001  
 Drawing No: 10925DP01 - SHEET 01 OF 02  
 Date/Time: Wed Jan 03, 2019 - 9:38am - Commercial

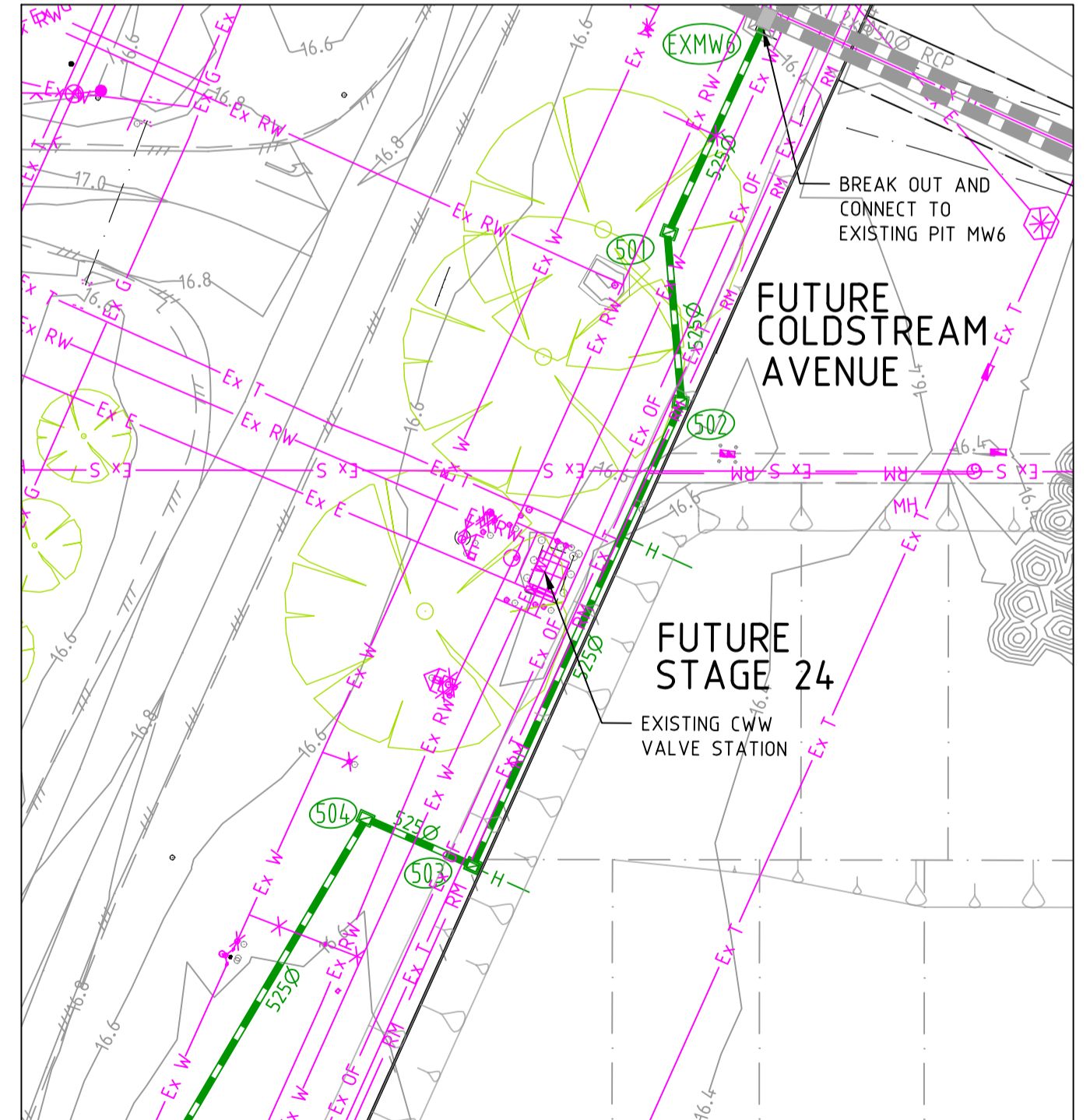

INSTALL 'NO ROAD' SIGN AND OBSTRUCTION MARKER (D4-2-1) AND CONCRETE EDGE STRIP

INSTALL HD PIT COVER

INSTALL TEMPORARY EDGE STRIP

PROVIDE TEMPORARY TURNING AREA IN ACCORDANCE WITH TYPICAL DETAIL SHEET 01

FOR ULTIMATE ALFRED ROAD/GEELONG ROAD INTERSECTION DESIGN REFER DCE PROJECT NO. 10848

INSTALL 'NO ROAD' SIGN AND OBSTRUCTION MARKER (D4-2-1) AND CONCRETE EDGE STRIP

PROVIDE TEMPORARY TURNING AREA IN ACCORDANCE WITH TYPICAL DETAIL SHEET 01

INSTALL CONCRETE EDGE STRIP

TRANSITION FROM SM2 K&C TO 600 BZ K&C OVER 3m

INSTALL HD PIT COVER

CONSTRUCT CUT OFF DRAIN IN ACCORDANCE WITH DETAIL ON SHEET 02.

EXISTING TELECOMMUNICATIONS TO BE REMOVED BY OTHERS

FENCE REMOVED AS PART OF BULK EARTHWORKS

REMOVE EXISTING TEMPORARY TURNING AREA & CONCRETE EDGE STRIP. MATCH NEATLY TO EXISTING PAVEMENT. RE-USE EXISTING BOLLARDS/ AND SIGNAGE WHERE POSSIBLE

REMOVE TEMP. PIPE BLANKING AND CONNECT TO EXISTING PIPE STUB

REMOVE TEMP. PIPE BLANKING AND CONNECT TO EXISTING S250 STUB

TABLE OF SERVICES LOCATIONS

STREET NAME	WATER	ND-WATER	GAS	COMMS	ELEC.	POLES	BOK
GIRI WAY	3.00 N	2.55 N	2.10 N	1.725 S	2.15 S	*0.80 S	4.35
KALINDI STREET	3.00 W	2.55 W	2.10 W	1.725 E	2.15 E	*0.80 E	4.35
RADHIKA STREET	3.00 N	2.55 N	2.10 N	1.725 S	2.15 S	*0.80 S	4.35
PANDAVA ROAD	3.65 N	2.95 N	2.30 N	2.225 S	2.65 S	*0.80 S	4.35

\*BEHIND BACK OF KERB

**CAUTION!!!**  
TELSTRA MAJOR CABLES ARE IN THE VICINITY OF WORKS

**NOTE:**  
ALL EX PIT & MH WITHIN NEW WORKS TO BE ADJUSTED TO MATCH NEW FINISHED SURFACE LEVELS

**WARNING!**  
THE LOCATION OF EXISTING SERVICES SHOWN ON THESE PLANS MUST BE PROVEN ON SITE, THE APPROPRIATE AUTHORITY MUST BE CONTACTED AND THE SERVICES LOCATED PRIOR TO COMMENCEMENT OF ANY WORKS.

**BEWARE!!!**  
TELSTRA OPTIC FIBRE CABLES IN THE VICINITY OF WORKS. TEL: 9253 8263

**WARNING**  
**BEWARE OF ASBESTOS**  
SOME UNDERGROUND SERVICES MAYBE CONSTRUCTED FROM ASBESTOS CONTAINING MATERIAL. CONTACT THE SUPERINTENDENT FOR INSTRUCTIONS ON HOW TO MANAGE ANY POTENTIAL ASBESTOS HAZARD



**NOT TO BE USED FOR CONSTRUCTION**

REV	AMENDMENTS	DATE	APPD.
E	COUNCIL COMMENTS (14/12/18)	09/01/18	TL
D	SERVICE ROAD SERVICING AMENDMENTS	27/11/18	TL
C	AMENDED PERMIT PLAN	19/10/18	TL
B	STAGING ORDER CHANGED	30/08/18	TL
A	PRELIMINARY ISSUE	20/11/17	TL

Drawn R.YOUNG  
Date 02/08/18  
AN 1991113  
Designed C.LOWE  
Date 30/08/18  
AN 1961199  
Verified R.MONKHOUSE  
Date 24/09/17  
AN 644590  
Approved T.LIAKOPOULOS  
Date 01/10/18  
AN 888445

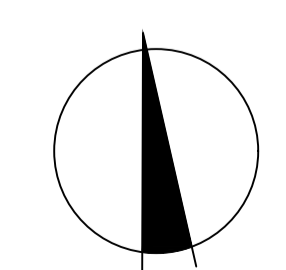
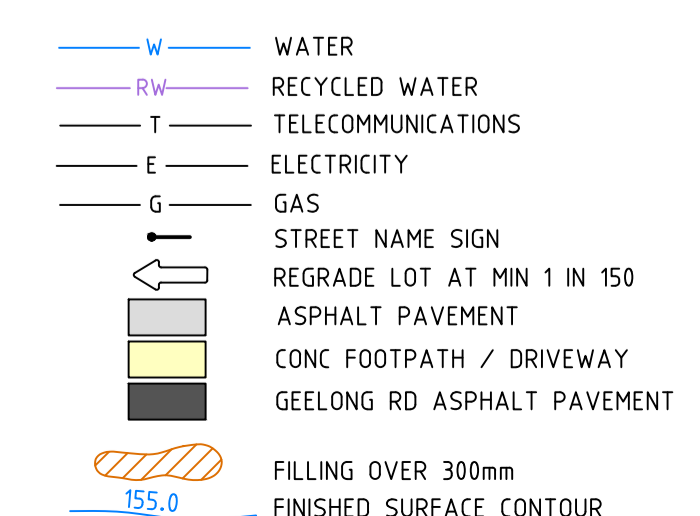
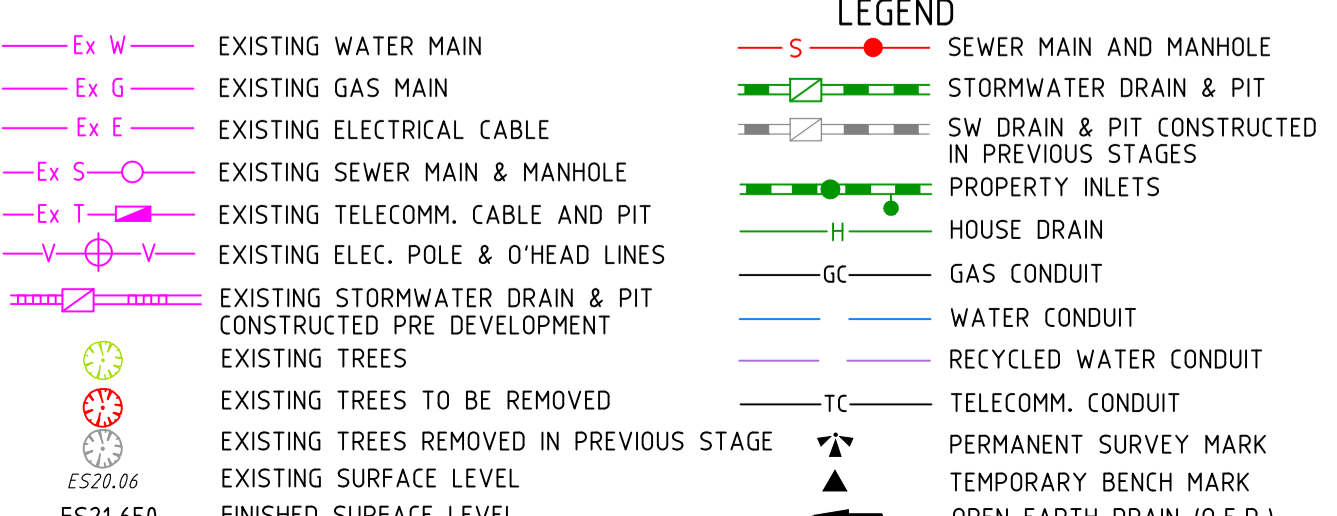
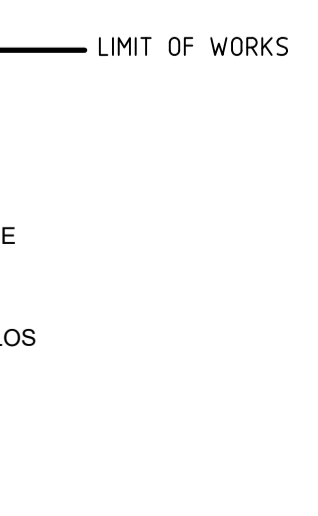

Coords: MGA  
Levels: AHD

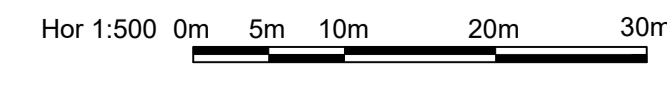

Scale @ A1/A3 1:500/1:1000

**RIVERWALK**  
**STAGE 25**  
**GEELONG ROAD, WERRIBEE**  
**DETAIL PLAN**  
**SHEET 02 OF 02**  
**Drawing No. 10925DP02** Rev E  
Sheet No. **PRELIMINARY**  
© Dalton Consulting Engineers Pty Ltd



VICTORIA  
T 61 3 9813 7400  
W dceng.com.au

QUEENSLAND  
T 61 7 3374 9000  
E info@dceng.com.au

ABN 78 429 221 049

Drawing File: C:\Users\j10900\10925-riverwalk\_stage\_25\Area01\01  
 Drawing Title: Riverwalk Stage 25 Geelong Road  
 Date/Time: Wed Jun 08 2018 9:38am  
 Comment: