

Riverwalk

Stage 12

Wyndham City Council

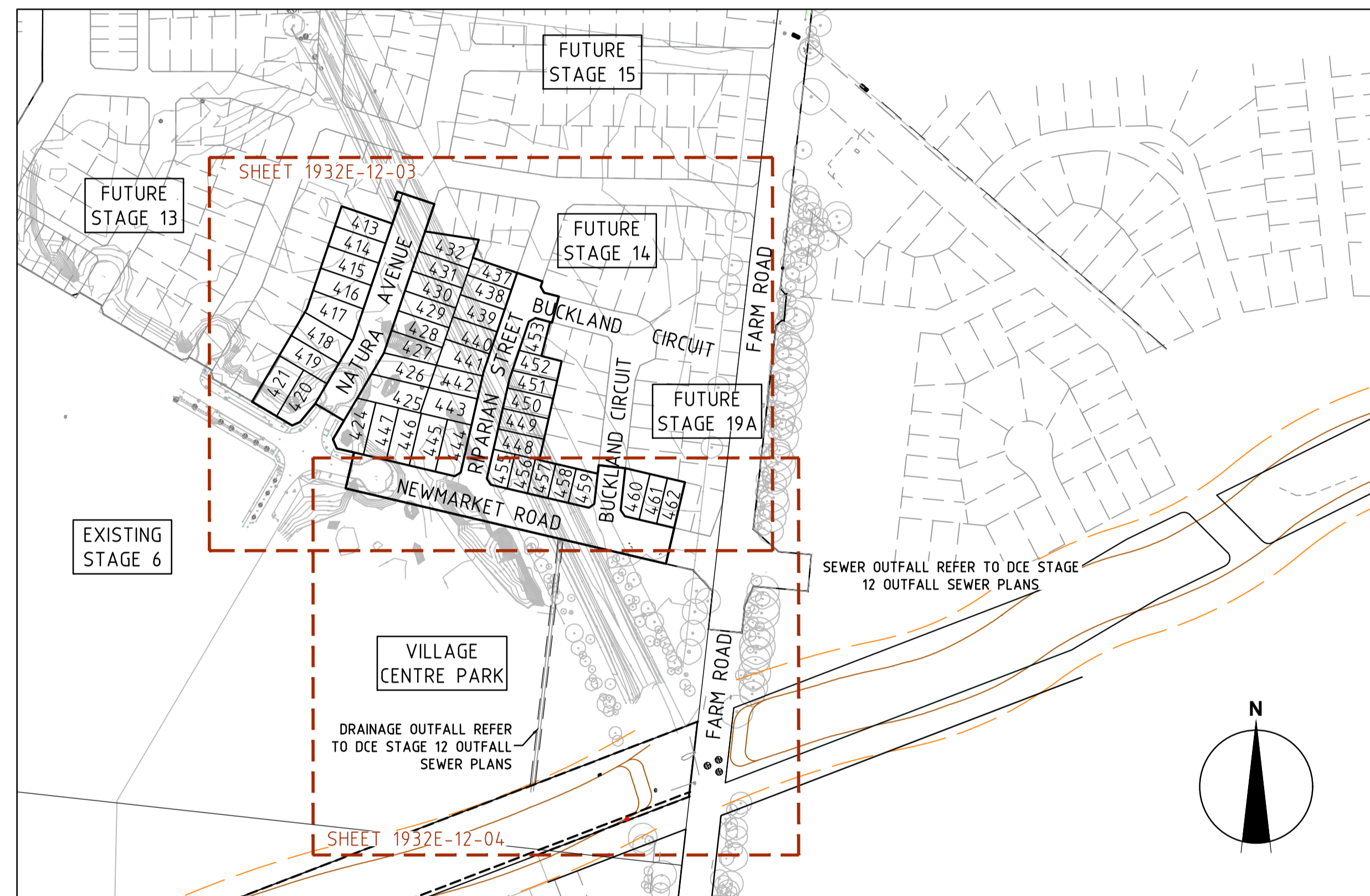

LOCALITY PLAN
MELWAYS REF. 244 F2

Places Victoria

Principal

Places Victoria
710 Collins Street
Docklands, VIC - 3008

Drawing Index

- 1932E-12-01 Cover Plan
- 1932E-12-02 Demolition Plan
- 1932E-12-03 Layout Plan - 1
- 1932E-12-04 Layout Plan - 2
- 1932E-12-05 Earthworks Plan
- 1932E-12-06 Signs & Linemarking Plan
- 1932E-12-07 Intersection Detail Plan
- 1932E-12-08 Lip Profiles - 1
- 1932E-12-09 Lip Profiles - 2
- 1932E-12-10 Setout Information - 1
- 1932E-12-11 Setout Information - 2
- 1932E-12-12 Longitudinal Sections - 1
- 1932E-12-13 Longitudinal Sections - 2
- 1932E-12-14 Cross Sections: Natura Avenue : Ch 29.143 - Ch 100.224
- 1932E-12-15 Cross Sections: Natura Avenue : Ch 112.724 - Ch 167.364
- 1932E-12-16 Cross Sections: Riparian Street : Ch 14.067 - Ch 81.236
- 1932E-12-17 Cross Sections: Riparian Street : Ch 93.836 - Ch 137.242
- 1932E-12-18 Cross Sections: Buckland Circuit
- 1932E-12-19 Cross Sections: Newmarket Road : Ch 610.774 - Ch 644.540
- 1932E-12-20 Cross Sections: Newmarket Road : Ch 660.540 - Ch 695.180
- 1932E-12-21 Cross Sections: Newmarket Road : Ch 704.541 - Ch 742.041
- 1932E-12-22 Cross Sections: Newmarket Road : Ch 753.920 - Ch 807.109
- 1932E-12-23 Drainage Longitudinal Sections - 1
- 1932E-12-24 Drainage Longitudinal Sections - 2
- 1932E-12-25 Drainage Longitudinal Sections - 3
- 1932E-12-26 Drainage Longitudinal Sections - 3
- 1932E-12-27 Pit Schedule
- 1932E-12-28 General Notes & Details
- 1932E-12-85 Safety In Design Information



Level 10, 71 Queens Rd,
Melbourne, VIC, 3004
Tel: +61 3 9514 1500
Fax: +61 3 9514 1502

A.B.N. 47 065 475 149

AS CONSTRUCTED PLANS
The purpose of these as-constructed plans is to update the design drawings to show significant changes which occurred during construction. Note that the levels shown on these plans are design levels, and have not been verified by survey. All information shown on these plans should be verified on site.
SMEC accept no responsibility for loss or damages resulting from the inappropriate usage of these plans.

WARNING
SAFETY MEASURES REQUIRED
Please note there are risks attached to the construction of this project, and any ongoing maintenance of structures. Consider the safety of all. For potential risks, consequences and controls refer to Safety In Design Risk Register SID P4.E6. 1932E-12-85
ASSESS THE RISK - STAY SAFE

NOTES :

- ASPHALT TO BE REMOVED FROM NEW FARM ROAD FROM THE INTERSECTION OF FARM ROAD THE NORTHERN MOST BOUNDARY OF STAGE 17.
- SERVICES WITHIN THE DEVELOPMENT AREA TO BE PROVED, RELOCATED OR REMOVED TO THE SATISFACTION OF THE SERVICE AUTHORITY.
- ALL TREES INCLUDING THEIR ROOTS WITHIN THE BOUNDARY OF STAGES 12,13 & 14 TO BE REMOVED. ALL DISTURBED AREAS TO BE BACKFILLED TO LEVEL 1 SPECIFICATIONS TO THE SATISFACTION OF THE SUPERINTENDENT.

LEGEND

- EXISTING ROAD TO HAVE ASPHALT REMOVED TO FIRM CRUSHED ROCK BASE TO THE SATISFACTION OF THE SUPERINTENDENT
- TREES TO BE REMOVED (ALL TREES REQUIRED TO BE REMOVED AS PART OF THE DEVELOPMENT ARE SHOWN IN RED.)
- AN EXISTING SERVICE TO BE EITHER ABANDONED OR RELOCATED AS PER SERVICE AUTHORITY REQUIREMENTS.

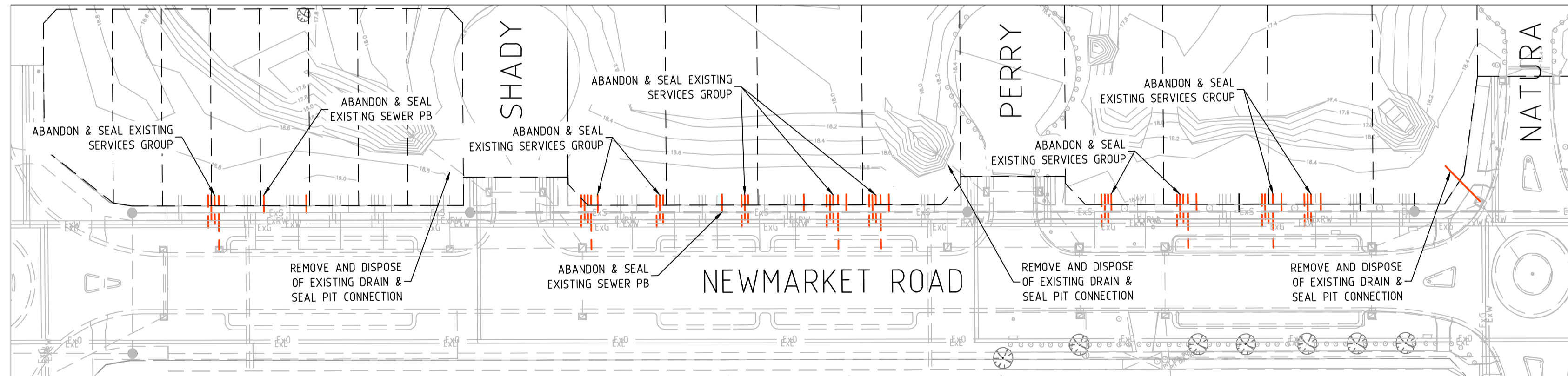
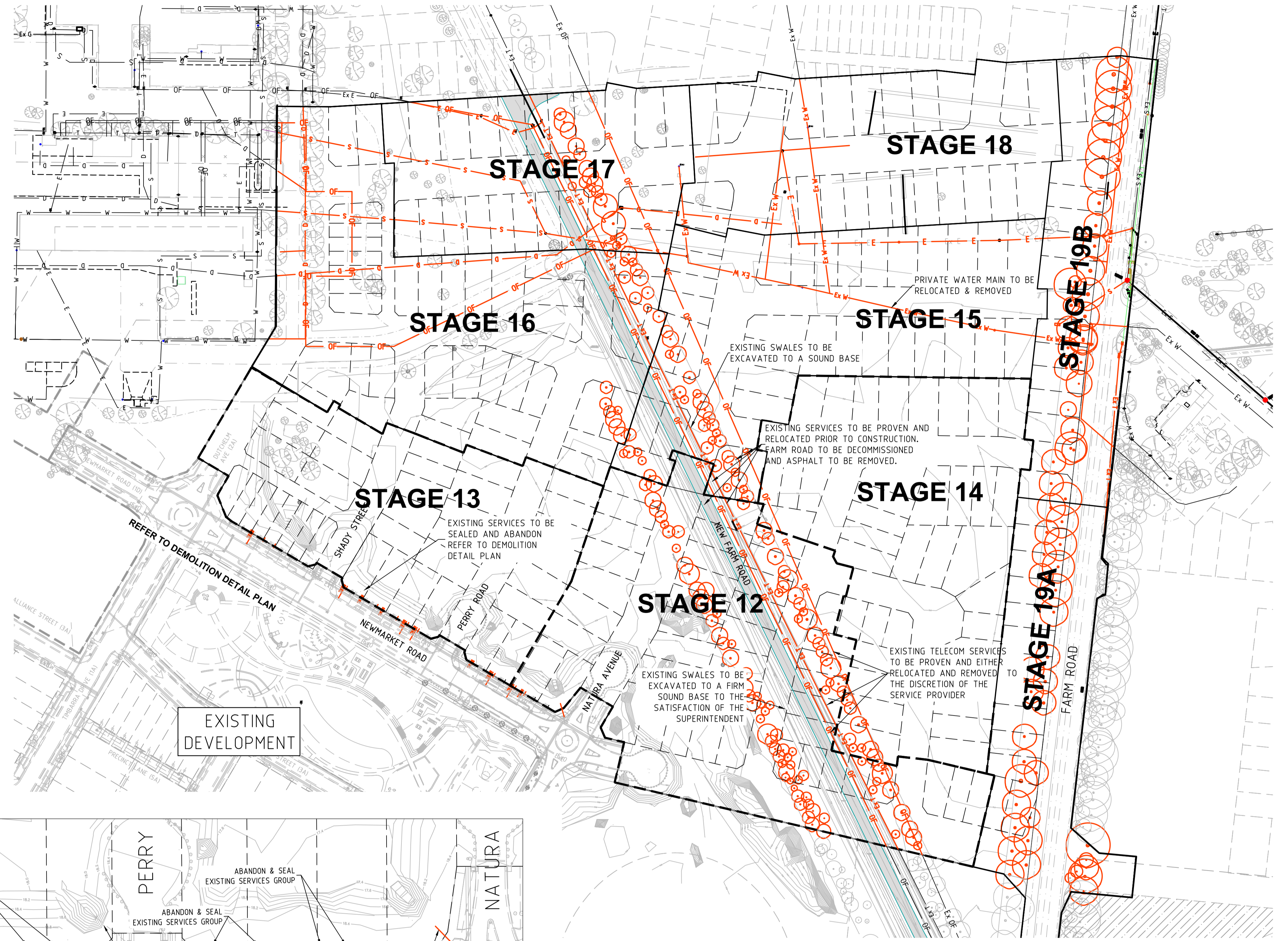

DEMOLITION DETAIL PLAN
SCALE 1:250

AS CONSTRUCTED PLANS
The purpose of these as-constructed plans is to update the design drawings to show significant changes which occurred during construction. Note that the levels shown on these plans are design levels, and have not been verified by survey. All information shown on these plans should be verified on site.
SMEC accept no responsibility for loss or damages resulting from the inappropriate usage of these plans.

WARNING
BEWARE OF UNDERGROUND SERVICES
The locations of underground services are approximate only and their exact position should be proven on site.
No guarantee is given that all existing services are shown. Locate all underground services before commencement of works
DIAL 1100 BEFORE YOU DIG
www.1100.com.au

U:\work\1932e - riverwalk\1932e - 12\drawing\1932e-12-02

REVISION	DATE	DES/DFT	APPD
1	04.05.17	AM/AM	MB
0	23.06.16	BC/NS	MB



Principal
Places Victoria
710 Collins Street
Docklands, VIC - 3008

All setting out should be carried out in accordance with GAA/Council's standard drawings or as nominated on hard copy plans provided by SMEC. Any digital information supplied by this office is for information only. Any discrepancies should be discussed with the superintendent.

Designed
B.Cheung
Drawn
N.Shrestha
Checked
L.Vieyra
Authorised
S.Tsialtas
Date
November 2015

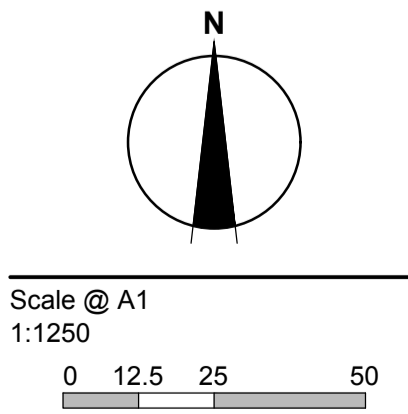

© SMEC Australia Pty Ltd
ABN 47 065 475 149
These designs and drawings are the copyright of SMEC Australia Pty Ltd.
The drawing shall not be reproduced or copied, in whole or part, without the written permission of SMEC Australia Pty Ltd.
The contents of this drawing are electronically generated, are confidential and may only be used for the purpose for which they are intended.

URBAN DEVELOPMENT
Level 10, 71 Queens Road, Melbourne VIC 3004
p +61 3 9514 1500 | f +61 3 9514 1502 | www.smec.com

Riverwalk
Stage 12
Wyndham City Council
Roadworks and Drainage
Demolition Plan

Drawing No. 1932E-12-02
Sheet No. 2 of 29

Rev 1

As Constructed

LEGEND - LAYOUT PLAN

Symbol	Description
Symbol	STORMWATER DRAIN, PIT & PROPERTY INLET
Symbol	SWALE DRAIN
Symbol	SEWER & MAINTENANCE STRUCTURES
Symbol	HOUSE DRAIN
Symbol	ELECTRICITY (U.GROUND) (INDICATIVE ONLY)
Symbol	ELECTRICITY (O.HEAD) (INDICATIVE ONLY)
Symbol	GAS (INDICATIVE ONLY)
Symbol	TELSTRA (INDICATIVE ONLY)
Symbol	WATER (INDICATIVE ONLY)
Symbol	RECYCLED WATER (INDICATIVE ONLY)
Symbol	AG. DRAIN (INDICATIVE ONLY)
Symbol	OPTIC FIBRE (INDICATIVE ONLY)
Symbol	SERVICE CONDUITS
Symbol	TACTILE PAVERS
Symbol	EXISTING ELECTRICITY (UNDERGROUND) (INDICATIVE ONLY)
Symbol	EXISTING ELECTRICITY (OVERHEAD) (INDICATIVE ONLY)
Symbol	EXISTING GAS (INDICATIVE ONLY)
Symbol	EXISTING TELSTRA (INDICATIVE ONLY)
Symbol	EXISTING OPTIC FIBRE (INDICATIVE ONLY)
Symbol	EXISTING WATER (INDICATIVE ONLY)
Symbol	EXISTING RECYCLED WATER (INDICATIVE ONLY)
Symbol	EXISTING STORMWATER DRAIN (INDICATIVE ONLY)
Symbol	EXISTING SEWER (INDICATIVE ONLY)
Symbol	EXISTING HOUSE DRAIN
Symbol	EXISTING SWALE DRAIN
Symbol	FUTURE AG DRAIN (INDICATIVE ONLY)
Symbol	FUTURE ELECTRICITY (UNDERGROUND) (INDICATIVE ONLY)
Symbol	FUTURE ELECTRICITY (OVERHEAD) (INDICATIVE ONLY)
Symbol	FUTURE GAS (INDICATIVE ONLY)
Symbol	FUTURE TELSTRA (INDICATIVE ONLY)
Symbol	FUTURE OPTIC FIBRE (INDICATIVE ONLY)
Symbol	FUTURE WATER (INDICATIVE ONLY)
Symbol	FUTURE RECYCLED WATER (INDICATIVE ONLY)
Symbol	FUTURE STORMWATER DRAIN (INDICATIVE ONLY)
Symbol	FUTURE SEWER (INDICATIVE ONLY)
Symbol	FUTURE HOUSE DRAIN
Symbol	FUTURE SWALE DRAIN
Symbol	EXISTING SURFACE LEVEL
Symbol	FINISHED BUILDING LINE LEVEL
Symbol	FINISHED RIDGE LINE LEVEL
Symbol	TOP OF RETAINING WALL
Symbol	BOTTOM OF RETAINING WALL
Symbol	RETAINING WALL
Symbol	ZERO LOT LINES
Symbol	PAVEMENT TREATMENT
Symbol	STRUCTURAL FILL > 200mm DEEP
Symbol	EX. STRUCTURAL FILL > 200mm DEEP
Symbol	DIRECTION OF FALL
Symbol	OVERLAND FLOW
Symbol	ALLOTMENT TO BE GRADED EVENLY IN DIRECTION OF FALL TO LEVELS INDICATED
Symbol	CONCRETE EDGE STRIP WITH SUBSOIL DRAIN, "NO ROAD" SIGN & BARRIER
Symbol	LIMIT OF WORKS
Symbol	EXISTING TREE TO BE REMOVED
Symbol	EXISTING TREE TO BE RETAINED
Symbol	PERMANENT SURVEY MARK
Symbol	TEMPORARY BENCH MARK
Symbol	PROPOSED DRIVEWAY



SERVICES OFFSET SCHEDULE

ROAD NAME	GAS		WATER		RECYCLED WATER		ELECTRICITY		OPTIC FIBRE		TELSTRA		SEWER	
	SIDE	OFFSET (m)	SIDE	OFFSET (m)	SIDE	OFFSET (m)	SIDE	OFFSET (m)	SIDE	OFFSET (m)	SIDE	OFFSET (m)	SIDE	OFFSET (m)
RIPARIAN STREET	EAST	2.25	EAST	3.25	EAST	2.75	WEST	2.60	SOUTH	1.85				
BUCKLAND CIRCUIT (LOT 453)	NORTH	2.25	NORTH	3.25	NORTH	2.75	SOUTH	2.60	SOUTH	1.85				WEST 1.00
BUCKLAND CIRCUIT (LOT 459 - 460)	EAST	2.25	EAST	3.25	EAST	2.75	WEST	2.60	WEST	1.85				
NEWMARKET ROAD	NORTH	2.55	NORTH	3.55	NORTH	3.05	SOUTH	3.70	SOUTH	3.00	SOUTH	0.50		NORTH 1.00
NATURA AVENUE	EAST	5.75	EAST	6.75	EAST	6.25	EAST	2.50	EAST	1.60				EAST 1.00

ROAD LAYOUT TABLE

ROAD NAME	ROAD CLASSIFICATION	RESERVE WIDTH (m)	ROAD WIDTH (m)				KERB TYPE		VERGE WIDTH (m)	
			LIP to LIP	INV to INV	BACK to BACK	NTH/WEST	STH/EAST	NTH/WEST	STH/EAST	
RIPARIAN STREET	AS1	16.00	6.40	7.00	7.30	B2	B2	4.35	4.35	
BUCKLAND CIRCUIT	AS1	16.00	6.40	7.00	7.30	B2	B2	4.35	4.35	
NEWMARKET ROAD	CS	22.00	7.50	8.40	8.70	B2/M2	B2/M2	4.35/6.65	4.35/6.65	
NATURA AVENUE	AS1	20.00	6.40	7.00	7.30	B2	B2	4.35	8.35	

- NOTES:**
- REFER TO SHEET 02 DEMOLITION PLAN FOR DETAILS REGARDING THE REMOVAL AND RELOCATION OF EXISTING ROAD AND TELECOMS INFRASTRUCTURE.
 - REFER TO STAGE 12 - OUTFALL SEWER PLANS (DWG No. 10913.2STD) FOR SEWER OUTFALL INFORMATION.
 - REFER TO STAGE 12 DRAINAGE OUTFALL (DWG NO. 10913.1DP) FOR OUTFALL WORKS DETAILS.
 - ALL TREES, EXISTING ROAD, FIBRE OPTIC & TELECOMS TO BE DECOMMISSIONED REMOVED OR RELOCATED AS FOR THE REQUIREMENTS OF THE SERVICE AUTHORITY
 - NEW KERB TO TIE INTO EXISTING LEVELS AND TRANSITION TO GAA STANDARDS AS SPECIFIED
 - REFER TO SHEET 28 FOR PARKING BAY DETAILS
 - ALL CURVED PIPES TO BE ACHIEVED BY USING MELBOURNE WATER STANDARD STD 7251/8/308 CONCRETE MAKE UP JOINTS ON CURVED PIPELINES.

AS CONSTRUCTED PLANS
 The purpose of these as-constructed plans is to update the design drawings to show significant changes which occurred during construction. Note that the levels shown on these plans are design levels, and have not been verified by survey. All information shown on these plans should be verified on site.
 SMEC accept no responsibility for loss or damages resulting from the inappropriate usage of these plans.

WARNING
BEWARE OF UNDERGROUND SERVICES
 The locations of underground services are approximate only and their exact position should be proven on site.
 No guarantee is given that all existing services are shown. Locate all underground services before commencement of works.
DIAL 1100 BEFORE YOU DIG
 www.1100.com.au

Places Victoria

Principal
 Places Victoria
 710 Collins Street
 Docklands, VIC - 3008

All setting out should be carried out in accordance with GAA/Council's standard drawings or as nominated on hard copy plans provided by SMEC. Any digital information supplied by this office is for information only. Any discrepancies should be discussed with the superintendent.

Designed
 B.Cheung
 Drawn
 N.Shrestha
 Checked
 L.Vieyra
 Authorised
 S.Tsialtas
 Date
 November 2015

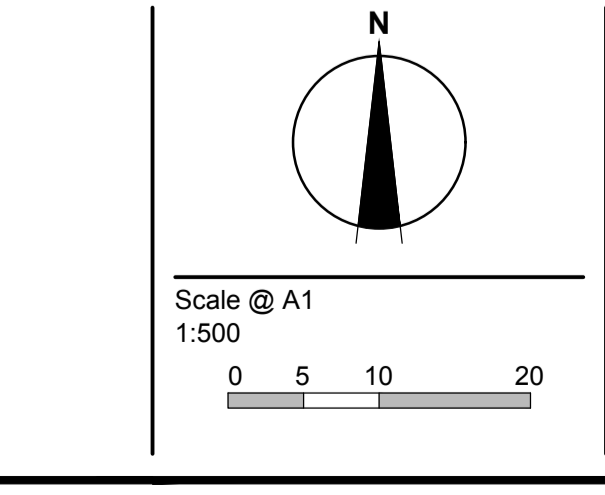

© SMEC Australia Pty Ltd
 ABN 47 065 475 148
 These designs and drawings are the copyright of SMEC Australia Pty Ltd.
 The drawing shall not be reproduced or copied, in whole or part, without the written permission of SMEC Australia Pty Ltd.
 The contents of this drawing are electronically generated, are confidential and may only be used for the purpose for which they are intended.

URBAN DEVELOPMENT
 Level 10, 71 Queens Road, Melbourne VIC 3004
 p +61 3 9514 1500 | f +61 3 9514 1502 | www.smec.com

Riverwalk
 Stage 12
 Wyndham City Council
 Roadworks and Drainage
 Layout Plan - 1

Drawing No. 1932E-12-03 Rev 3
 Sheet No. 3 of 29
As Constructed

I:\work\1932e - riverwalk\1932e - 2d\1932e-12-03

- LEGEND - LAYOUT PLAN**
- STORMWATER DRAIN, PIT & PROPERTY INLET
 - SWALE DRAIN
 - SEWER & MAINTENANCE STRUCTURES
 - HOUSE DRAIN
 - ELECTRICITY (U.GROUND) (INDICATIVE ONLY)
 - ELECTRICITY (O.HEAD) (INDICATIVE ONLY)
 - GAS (INDICATIVE ONLY)
 - TELSTRA (INDICATIVE ONLY)
 - WATER (INDICATIVE ONLY)
 - RECYCLED WATER (INDICATIVE ONLY)
 - AG. DRAIN (INDICATIVE ONLY)
 - OPTIC FIBRE (INDICATIVE ONLY)
 - SERVICE CONDUITS
 - TACTILE PAVERS
 - EXISTING ELECTRICITY (UNDERGROUND) (INDICATIVE ONLY)
 - EXISTING ELECTRICITY (OVERHEAD) (INDICATIVE ONLY)
 - EXISTING GAS (INDICATIVE ONLY)
 - EXISTING TELSTRA (INDICATIVE ONLY)
 - EXISTING OPTIC FIBRE (INDICATIVE ONLY)
 - EXISTING WATER (INDICATIVE ONLY)
 - EXISTING RECYCLED WATER (INDICATIVE ONLY)
 - EXISTING STORMWATER DRAIN (INDICATIVE ONLY)
 - EXISTING SEWER (INDICATIVE ONLY)
 - EXISTING HOUSE DRAIN
 - EXISTING SWALE DRAIN
 - FUTURE AG DRAIN (INDICATIVE ONLY)
 - FUTURE ELECTRICITY (UNDERGROUND) (INDICATIVE ONLY)
 - FUTURE ELECTRICITY (OVERHEAD) (INDICATIVE ONLY)
 - FUTURE GAS (INDICATIVE ONLY)
 - FUTURE TELSTRA (INDICATIVE ONLY)
 - FUTURE OPTIC FIBRE (INDICATIVE ONLY)
 - FUTURE WATER (INDICATIVE ONLY)
 - FUTURE RECYCLED WATER (INDICATIVE ONLY)
 - FUTURE STORMWATER DRAIN (INDICATIVE ONLY)
 - FUTURE SEWER (INDICATIVE ONLY)
 - FUTURE HOUSE DRAIN
 - EXISTING SURFACE LEVEL
 - FINISHED BUILDING LINE LEVEL
 - FINISHED RIDGE LINE LEVEL
 - TOP OF RETAINING WALL
 - BOTTOM OF RETAINING WALL
 - RETAINING WALL
 - ZERO LOT LINES
 - PAVEMENT TREATMENT
 - STRUCTURAL FILL > 200mm DEEP
 - EX. STRUCTURAL FILL > 200mm DEEP
 - DIRECTION OF FALL
 - OVERLAND FLOW
 - ALLOTMENT TO BE GRADED EVENLY IN DIRECTION OF FALL TO LEVELS INDICATED
 - CONCRETE EDGE STRIP WITH SUBSOIL DRAIN, "NO ROAD" SIGN & BARRIER
 - LIMIT OF WORKS
 - EXISTING TREE TO BE REMOVED
 - EXISTING TREE TO BE RETAINED
 - PERMANENT SURVEY MARK
 - TEMPORARY BENCH MARK
 - PROPOSED DRIVEWAY

WARNING

- OPTIC FIBRE IN VICINITY OF WORKS
- TEL 8317 3685 (PLACES VICTORIA)
- 9253 8263 (TELSTRA)

WARNING

BEWARE OF UNDERGROUND SERVICES

The locations of underground services are approximate only and their exact position should be proven on site. No guarantee is given that all existing services are shown. Locate all underground services before commencement of works

DIAL 1100 BEFORE YOU DIG

www.1100.com.au

AS CONSTRUCTED PLANS

The purpose of these as-constructed plans is to update the design drawings to show significant changes which occurred during construction. Note that the levels shown on these plans are design levels, and have not been verified by survey. All information shown on these plans should be verified on site. SMEC accept no responsibility for loss or damages resulting from the inappropriate usage of these plans.

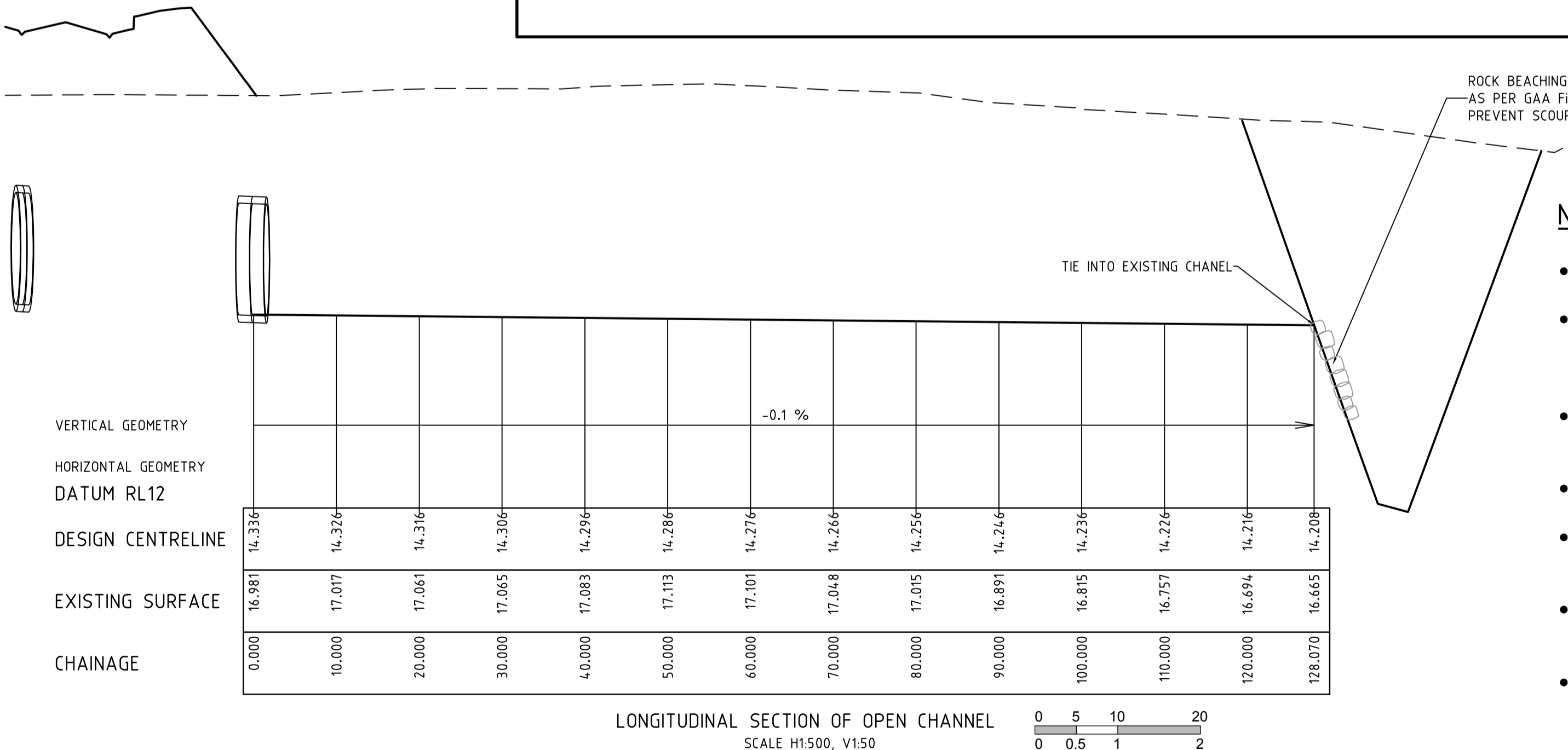
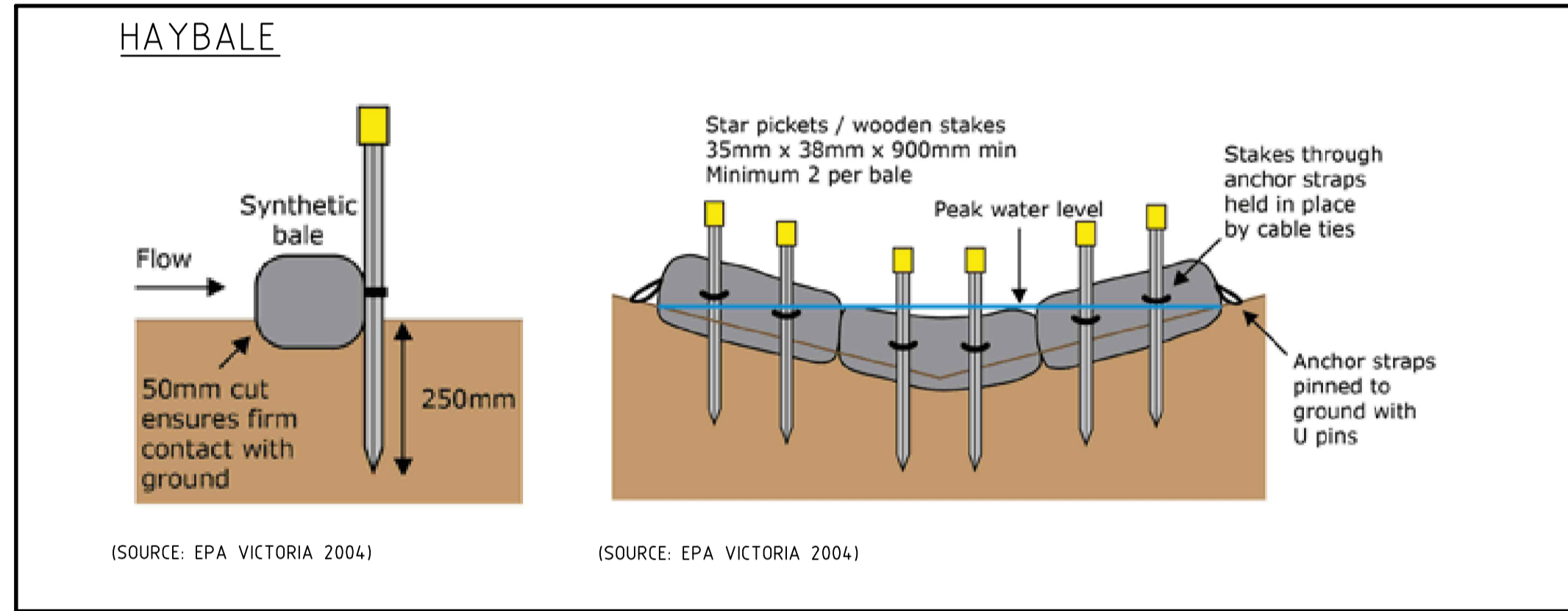
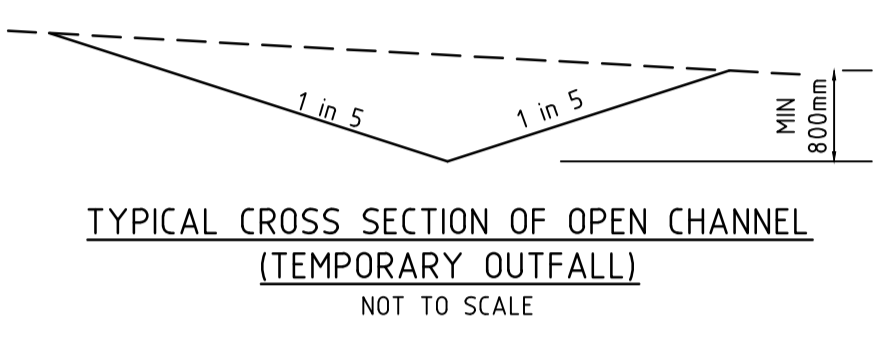

- NOTES:**
- ALL EXISTING PITS & MANHOLES WITHIN NEW WORKS TO BE ADJUSTED TO MATCH NEW FINISHED SURFACE LEVELS.
 - THE LOCATION OF EXISTING SERVICES SHOWN ON THESE PLANS MUST BE PROVEN ON SITE, THE APPROPRIATE AUTHORITY MUST BE CONTACTED AND THE SERVICES LOCATED PRIOR TO COMMENCEMENT OF ANY WORKS.
 - ALL EXISTING SERVICES UNDER NEW AND PROPOSED ROAD PAVEMENT, FOOTPATH AND DRIVEWAYS TO BE FCR BACKFILLED.
 - REFER TO DRAWING 1932E.12.28 FOR PARKING BAY DETAILS.
 - REFER TO SHEET 02 DEMOLITION PLAN FOR DETAILS REGARDING THE REMOVAL AND RELOCATION OF EXISTING ROAD AND TELECOMS INFRASTRUCTURE.
 - ALL TREES, EXISTING ROAD, FIBRE OPTIC & TELECOMS TO BE DECOMMISSIONED & REMOVED AS FOR THE REQUIREMENTS OF THE SERVICE AUTHORITY.
 - REFER TO STAGE 12 DRAINAGE OUTFALL (DC E DWG NO. 10913.1DP) FOR OUTFALL WORK DETAILS.

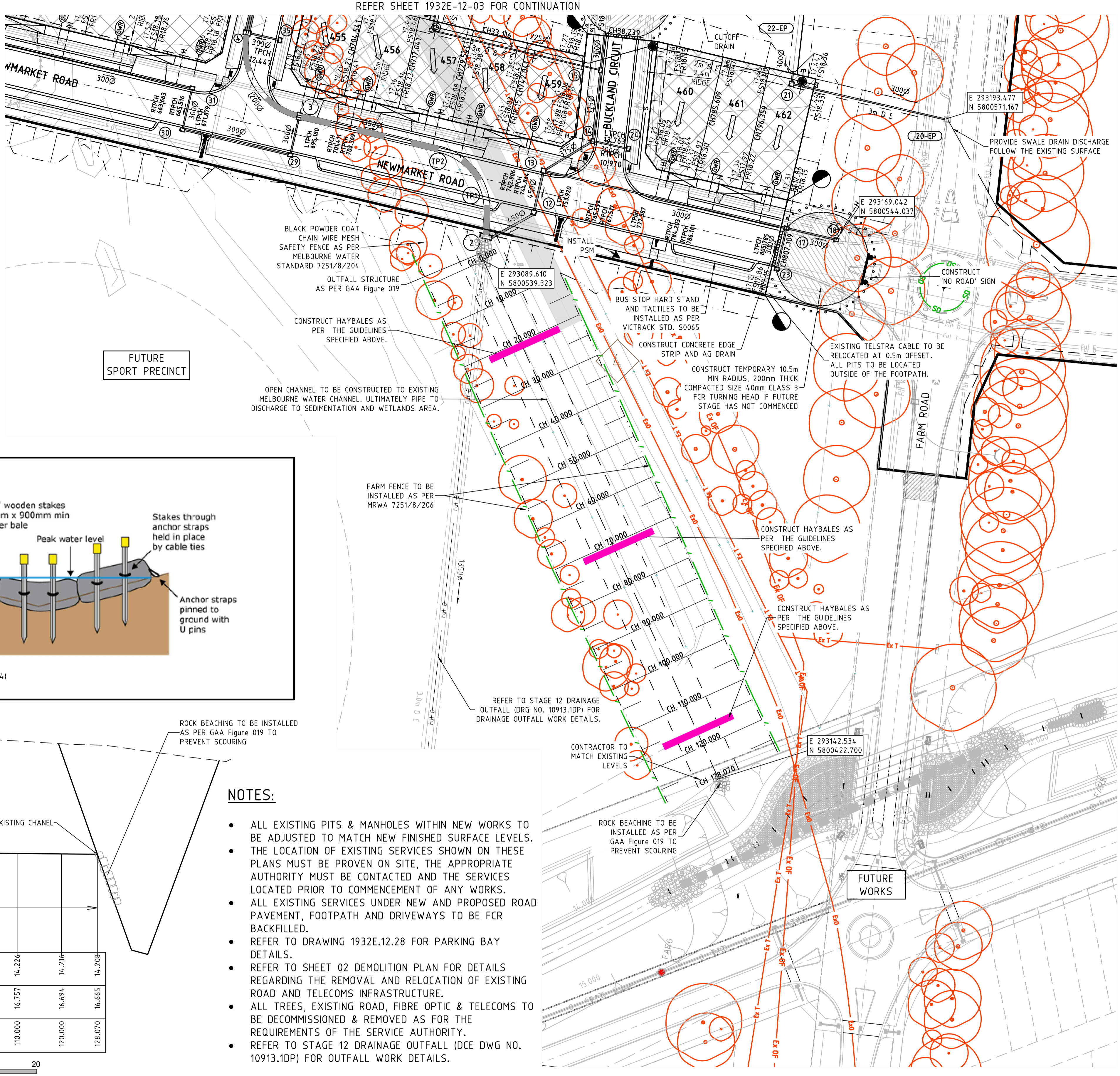

REVISION	DATE	DES/DFT	APPD
6	18.05.17	LV	MB
5	04.05.17	AM/AM	MB
4	22.02.17	LV/MR	MB
3	13.12.16	LV	MB
2	02.12.16	LV	MB
1	14.09.16	LV	MB
0	23.06.16	BC/NS	MB
ISSUED FOR CONSTRUCTION			

Places Victoria

Principal
Places Victoria
710 Collins Street
Docklands, VIC - 3008

All setting out should be carried out in accordance with GAA/Council's standard drawings or as nominated on hard copy plans provided by SMEC. Any digital information supplied by this office is for information only. Any discrepancies should be discussed with the superintendent.

Designed
B.Cheung
Drawn
N.Shrestha
Checked
L.Vieyra
Authorised
S.Tsialtas
Date
November 2015

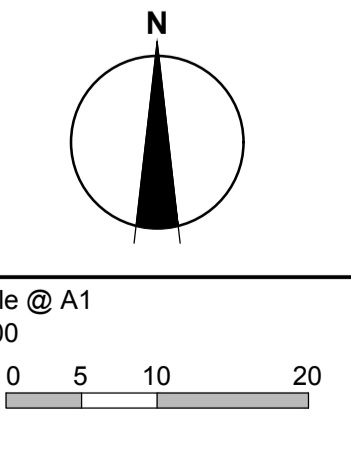

© SMEC Australia Pty Ltd
ABN 47 065 475 148
These designs and drawings are the copyright of SMEC Australia Pty Ltd.
The drawing shall not be reproduced or copied, in whole or part, without the written permission of SMEC Australia Pty Ltd.
The contents of this drawing are electronically generated, are confidential and may only be used for the purpose for which they are intended.

URBAN DEVELOPMENT
Level 10, 71 Queens Road, Melbourne VIC 3004
p +61 3 9514 1500 | f +61 3 9514 1502 | www.smec.com

Riverwalk
Stage 12
Wyndham City Council
Roadworks and Drainage
Layout Plan - 2

Drawing No. 1932E-12-04 **Rev 6**

Sheet No. 4 of 29

As Constructed

I:\work\1932e - riverwalk\1932e - 12.dwg 1932e - 12-04