

Drawing File: G:\Projects\10904-Riverwalk-Stage 3\Acad\Rev1
 10904SP01.dwg - 10904SP01
 Date/Time: Thu, Mar 29, 2012 - 8:57:00 AM -- Helen --

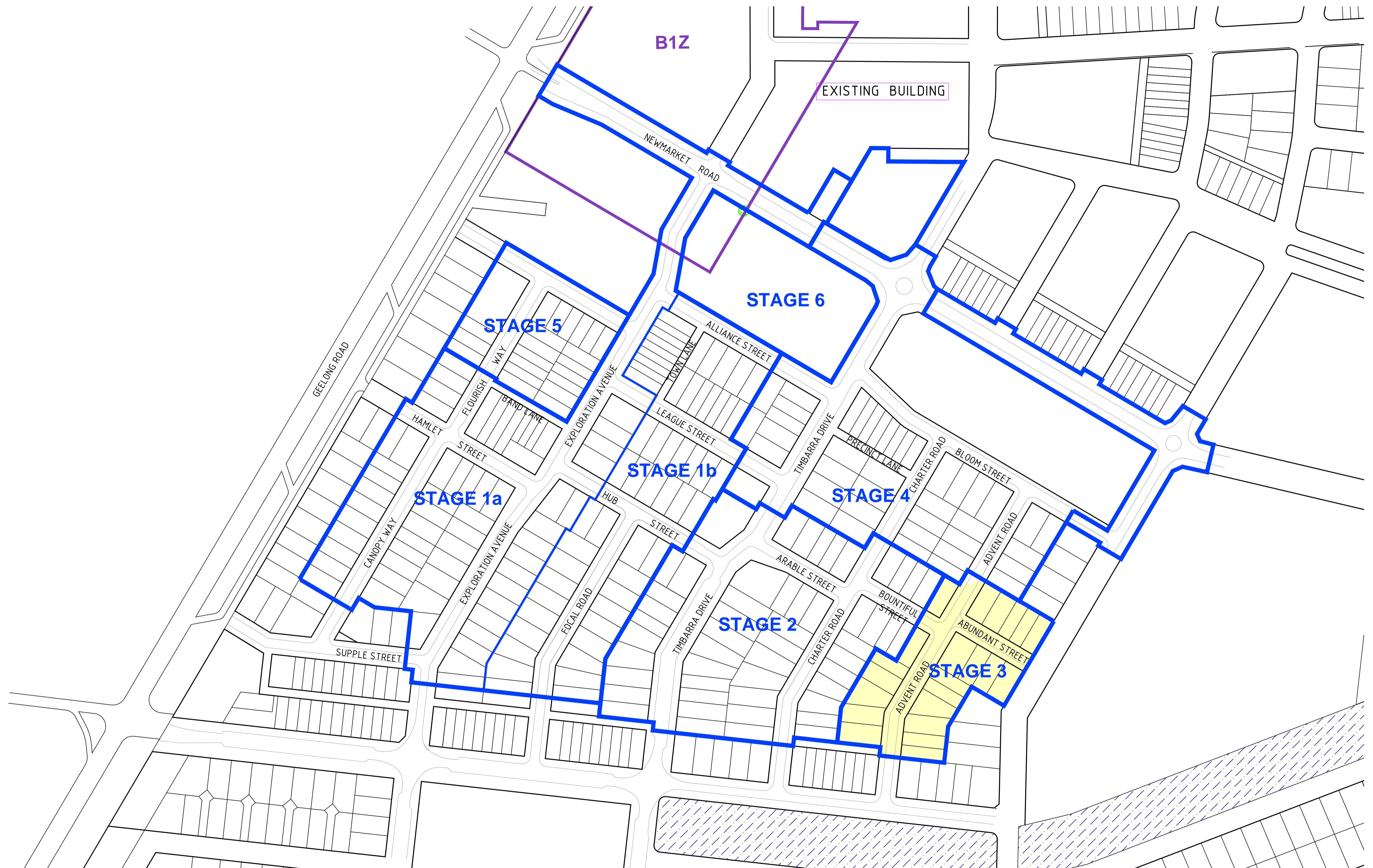

COUNCIL REF 75/110/4474/10/E3

AS CONSTRUCTED

REV	AMENDMENTS	DATE	APP'D.
1	AS CONSTRUCTED	28/03/12	TL
0	CONSTRUCTION ISSUE	05/12/11	TL
D	RE-ISSUED TO COUNCIL FOR APPROVAL	10/11/11	TL
C	ISSUED FOR TENDER	17/06/11	TL
B	COUNCIL COMMENTS 26/05/11	15/06/11	TL
A	ISSUED FOR COUNCIL APPROVAL	23/02/11	TL

Drawn JB Date 18/11/10
 Designed JB
 Date 18/11/10
 AN 25694
 Verified BG
 Date 23/02/11
 AN 5455
 Audited AO
 Date 02/08/11
 AN 6465
 Approved TL
 Date 04/08/11
 AN 7324
 Written dimensions to take precedence over scale.
 Contractor shall check and verify all dimensions on site.
 Discrepancies to be brought to the attention of the Superintendent.

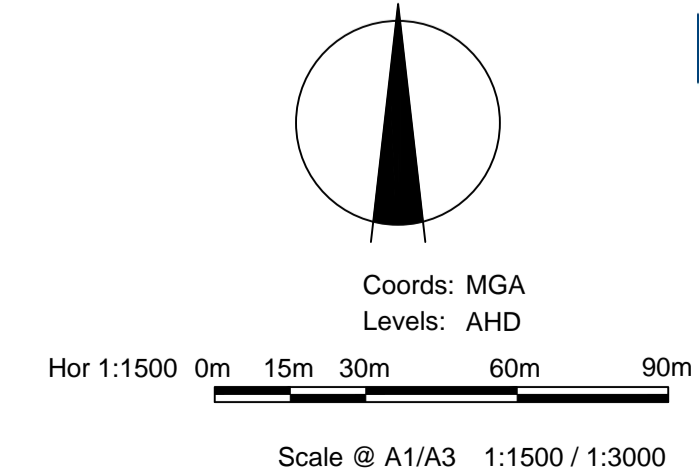

Places Victoria
 RIVERWALK - STAGE 3
 GEELONG ROAD, WERRIBEE
 STAGING PLAN

Drawing No. **10904SP01** Rev **1**
 Sheet No. 02 **AS CONSTRUCTED**
 © Dalton Consulting Engineers Pty Ltd
 ABN 78 429 221 049



255 Whitehorse Road
 PO Box 349
 Baiwyn Victoria 3103
 Australia
 T 61 3 9888 6866
 F 61 3 9888 6880
 E info@dceprofile.com
 W www.dceprofile.com

NOTE:
EXISTING SURFACE LEVELS ARE PRIOR
TO FILL PLACED. SURVEY FILES TO
BE PROVIDED.

BEWARE!!!
TELSTRA OPTIC FIBRE
CABLES IN THE VICINITY
OF WORKS. TEL: 9253 8263

WARNING!
THE LOCATION OF EXISTING SERVICES SHOWN
ON THESE PLANS MUST BE PROVEN ON SITE,
THE APPROPRIATE AUTHORITY MUST BE
CONTACTED AND THE SERVICES LOCATED PRIOR
TO COMMENCEMENT OF ANY WORKS.

TABLE OF SERVICES LOCATIONS

STREET NAME	GAS		WATER		ND WATER		OPTIC FIBRE NDS		OPTIC FIBRE DS		ELECTRICITY		SEWER	
	SIDE	OFFSET	SIDE	OFFSET	SIDE	OFFSET	SIDE	OFFSET	SIDE	OFFSET	SIDE	OFFSET	SIDE	OFFSET
ADVENT ROAD	E	2.10	E	3.10	E	2.60	E	1.825	W	1.90	W	2.40	W	1.00
BOUNTIFUL STREET	S	2.10	S	3.10	S	2.60	S	1.825	N	1.90	N	2.40	N/A	N/A
ABUNDANT STREET	S	2.10	S	3.10	S	2.60	S	1.825	N	1.90	N	2.40	N/A	N/A

*NOTE: ELECTRICITY POLES 0.8m MIN FROM BOK AS PER COUNCIL STANDARD DWG SD 8-1
*NOTE: STREET TREES AS PER COUNCIL STANDARD DWG SD8-1

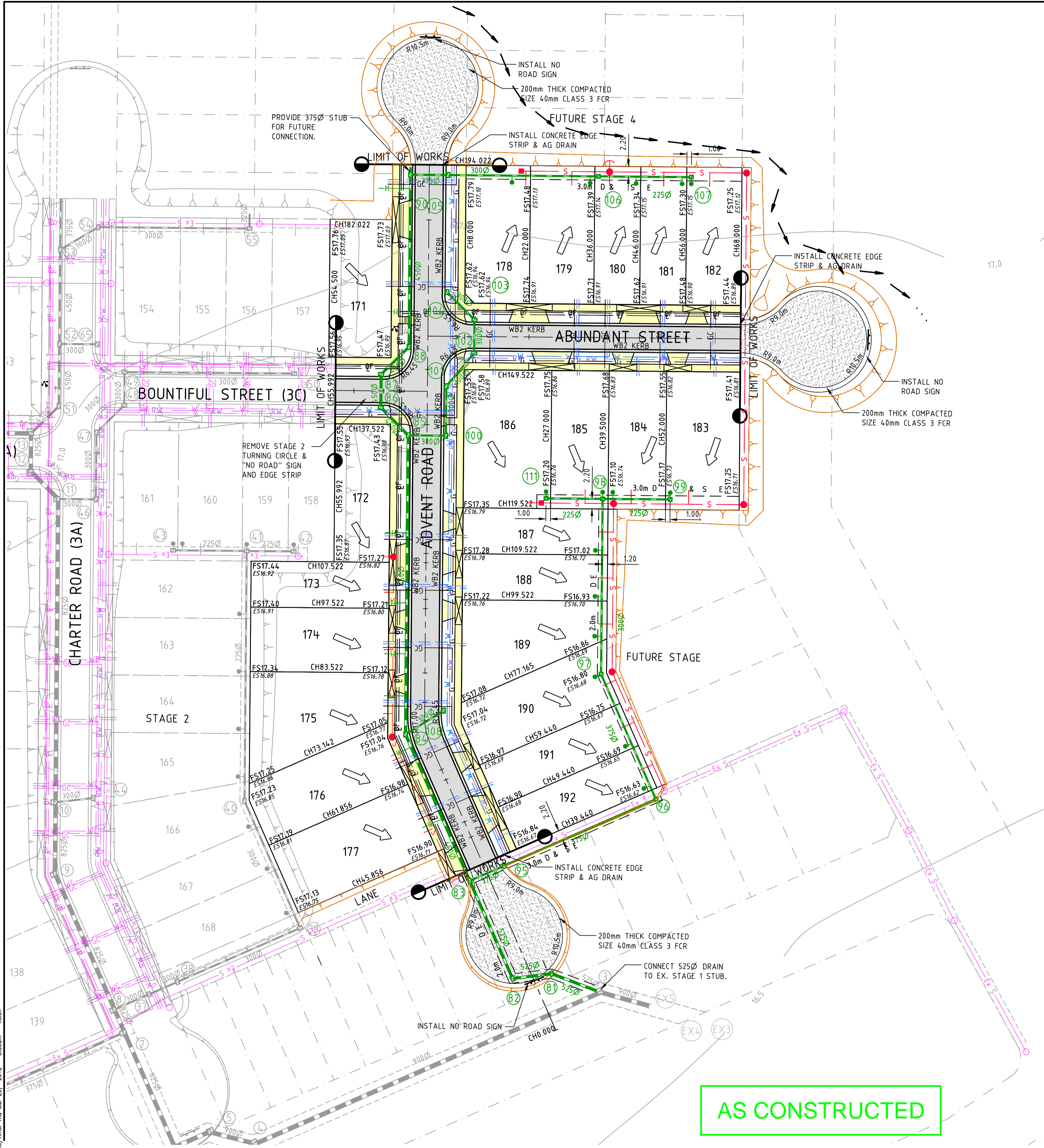

AS CONSTRUCTED

COUNCIL REF 75/110/4474/10/E3

Drawing File: G:\Design\10904-Riverwalk_Stage_3\Acad\Rev\10904DP01.dwg - 10904DP01
Date/Time: Thu, Mar 29, 2012 - 8:58:20m - Helen

REV	AMENDMENTS	DATE	APP'D.
1	AS CONSTRUCTED	28/03/12	TL
0	CONSTRUCTION ISSUE	05/12/11	TL
E	RE-ISSUED TO COUNCIL FOR APPROVAL	10/11/11	TL
D	COUNCIL COMMENTS 29/06/11	30/06/11	TL
C	ISSUED FOR TENDER	17/06/11	TL
B	COUNCIL COMMENTS 26/05/11	15/06/11	TL
A	ISSUED FOR COUNCIL APPROVAL	23/02/11	TL

Drawn JB Date 08/11/10
Designed JB
AN 25695
Verified BG
Date 23/02/11
AN 5456
Audited AO
Date 02/08/11
AN 6466
Approved TL
Date 04/08/11
AN 7325
Written dimensions to take precedence over scale.
Contractor shall check and verify all dimensions on site.
Discrepancies to be brought to the attention of the Superintendent.

- LEGEND**
- Ex W - EXISTING WATER MAIN
 - Ex G - EXISTING GAS MAIN
 - Ex E - EXISTING ELECTRICAL CABLE
 - Ex S - EXISTING SEWER MAIN & MANHOLE
 - Ex T - EXISTING TELECOMM. CABLE AND PIT
 - Ex P - EXISTING ELEC. POLE & O'HEAD LINES
 - Ex D - EXISTING STORMWATER DRAIN & PIT
 - X - EXISTING TREES TO BE REMOVED
 - X - EXISTING SURFACE LEVEL
 - X - FINISHED SURFACE LEVEL
 - X - OPEN EARTH DRAIN (O.E.D.)
 - S - SEWER MAIN AND MANHOLE
 - SD - STORMWATER DRAIN & PIT
 - SW - PREVIOUS STAGE SW DRAIN & PIT
 - P - PROPERTY INLETS
 - H - HOUSE DRAIN
 - GC - GAS CONDUIT
 - W - WATER CONDUIT
 - RW - RECYCLED WATER CONDUIT
 - TC - TELECOMM. CONDUIT
 - OF - OPTIC FIBRE
 - W - WATER
 - RW - RECYCLED WATER
 - T - TELECOMMUNICATIONS
 - E - ELECTRICITY
 - G - GAS
 - S - STREET NAME SIGN
 - R - REGRADE LOT AT MIN 1 IN 150
 - A - ASPHALT PAVEMENT
 - F - CONC FOOTPATH / DRIVEWAY
 - L - LANDSCAPING
 - P - PERMANENT SURVEY MARK
 - T - TEMPORARY BENCH MARK
 - S - FINISHED SURFACE CONTOUR

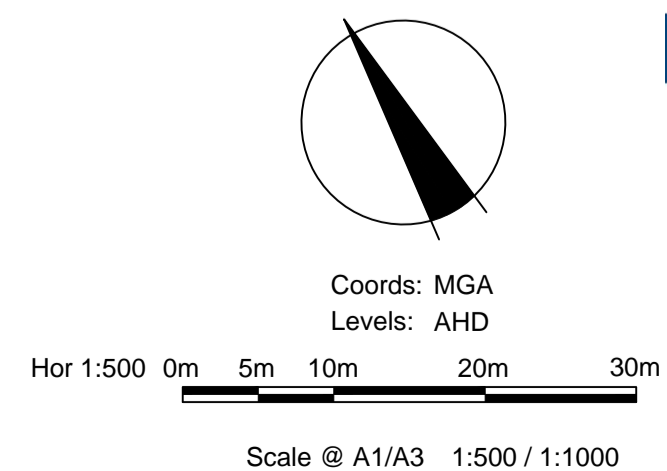

Places Victoria
RIVERWALK - STAGE 3
GEELONG ROAD, WERRIBEE
DETAIL PLAN

Drawing No. 10904DP01 Rev 1
Sheet No. 03 **AS CONSTRUCTED**
© Dalton Consulting Engineers Pty Ltd
ABN 78 429 221 049



255 Whitehorse Road
PO Box 349
Bairwyn Victoria 3103
Australia
T 61 3 9888 6886
F 61 3 9888 6880
E info@dceprofile.com
W www.dceprofile.com

Drawing File: G:\DesignData\10904-Riverwalk_Stage_3\Acad\Rev1
 10904EF01.dwg - 10904EF01
 Date/Time: Thu, Mar 29, 2012 - 8:58am - Helen-

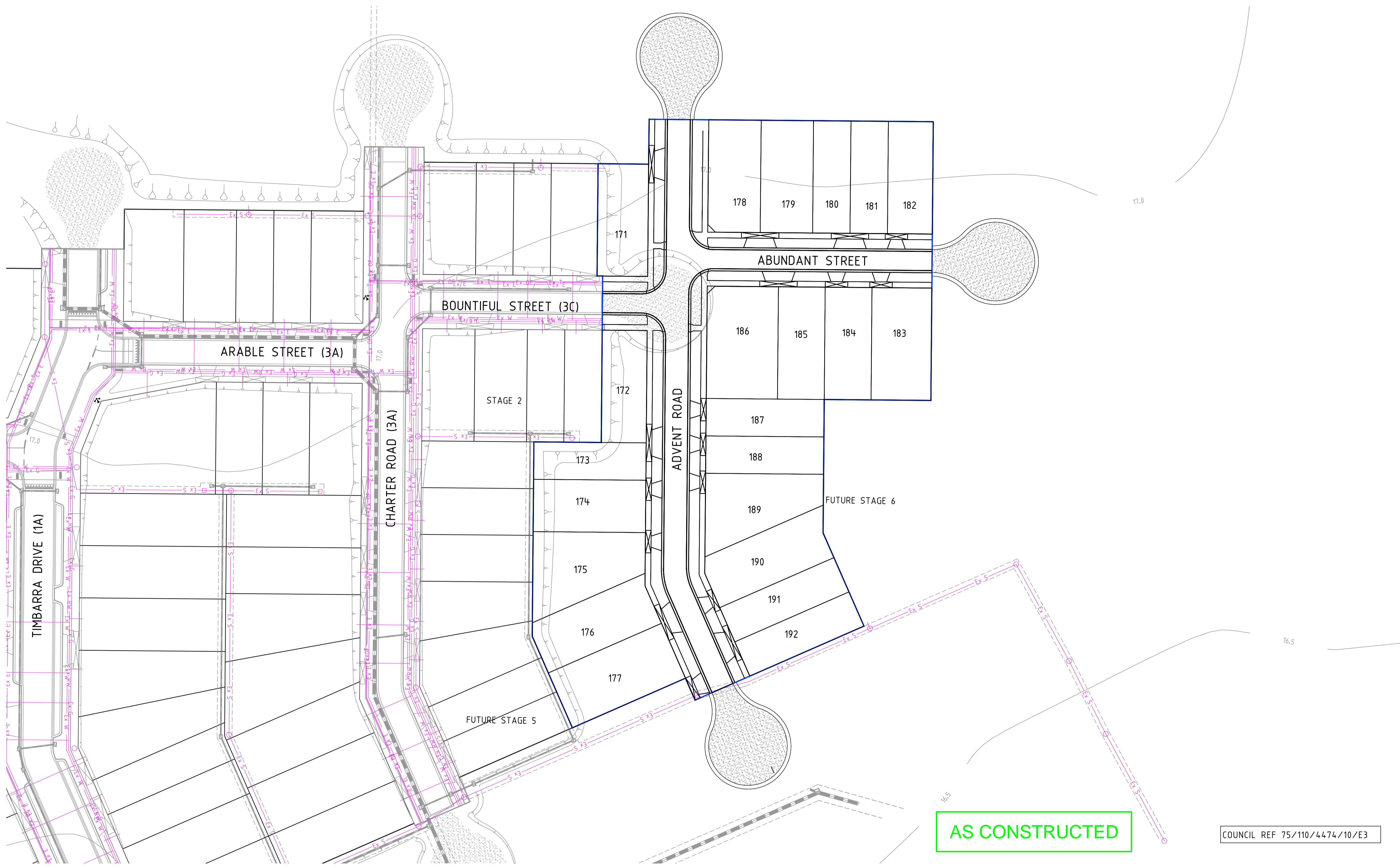

AS CONSTRUCTED

COUNCIL REF 75/110/4474/10/E3

REV	AMENDMENTS	DATE	APPD.
1	AS CONSTRUCTED	28/03/12	TL
0	CONSTRUCTION ISSUE	05/12/11	TL
E	RE-ISSUED TO COUNCIL FOR APPROVAL	10/11/11	TL
D	COUNCIL COMMENTS 29/06/11	30/06/11	TL
C	ISSUED FOR TENDER	17/06/11	TL
B	COUNCIL COMMENTS 26/05/11	15/06/11	TL
A	ISSUED FOR COUNCIL APPROVAL	23/02/11	TL

Drawn JB Date 18/11/10
 Designed JB
 Date 18/11/10
 AN 25705
 Verified BG
 Date 23/02/11
 AN 5466
 Audited AO
 Date 02/08/11
 AN 6476
 Approved TL
 Date 04/08/11
 AN 7335
 Written dimensions to take precedence over scale.
 Contractor shall check and verify all dimensions on site.
 Discrepancies to be brought to the attention of the Superintendent.

- LEGEND**
- Ex W EXISTING WATER MAIN
 - Ex RW EXISTING RECYCLED WATER MAIN
 - Ex G EXISTING GAS MAIN
 - Ex E EXISTING ELECTRICAL CABLE
 - Ex S EXISTING SEWER MAIN & MANHOLE
 - Ex T EXISTING TELECOMM. CABLE AND PIT
 - PREVIOUS STAGE SW DRAIN & PIT
 - ▲ PERMANENT SURVEY MARK

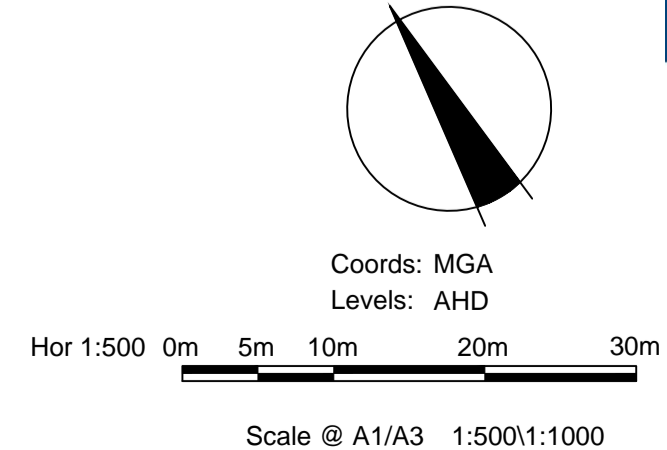

Places Victoria
 RIVERWALK - STAGE 3
 GEELONG ROAD, WERRIBEE
 EXISTING FEATURES PLAN

Drawing No. 10904EF01 Rev 1
 Sheet No. 14 **AS CONSTRUCTED**
 © Dalton Consulting Engineers Pty Ltd
 ABN 78 429 221 049



255 Whitehorse Road
 PO Box 349
 Bialwyn Victoria 3103
 Australia
 T 61 3 9888 6886
 F 61 3 9888 6880
 E info@dceprofile.com
 W www.dceprofile.com