

FOR CONTINUATION REFER BELOW LEFT

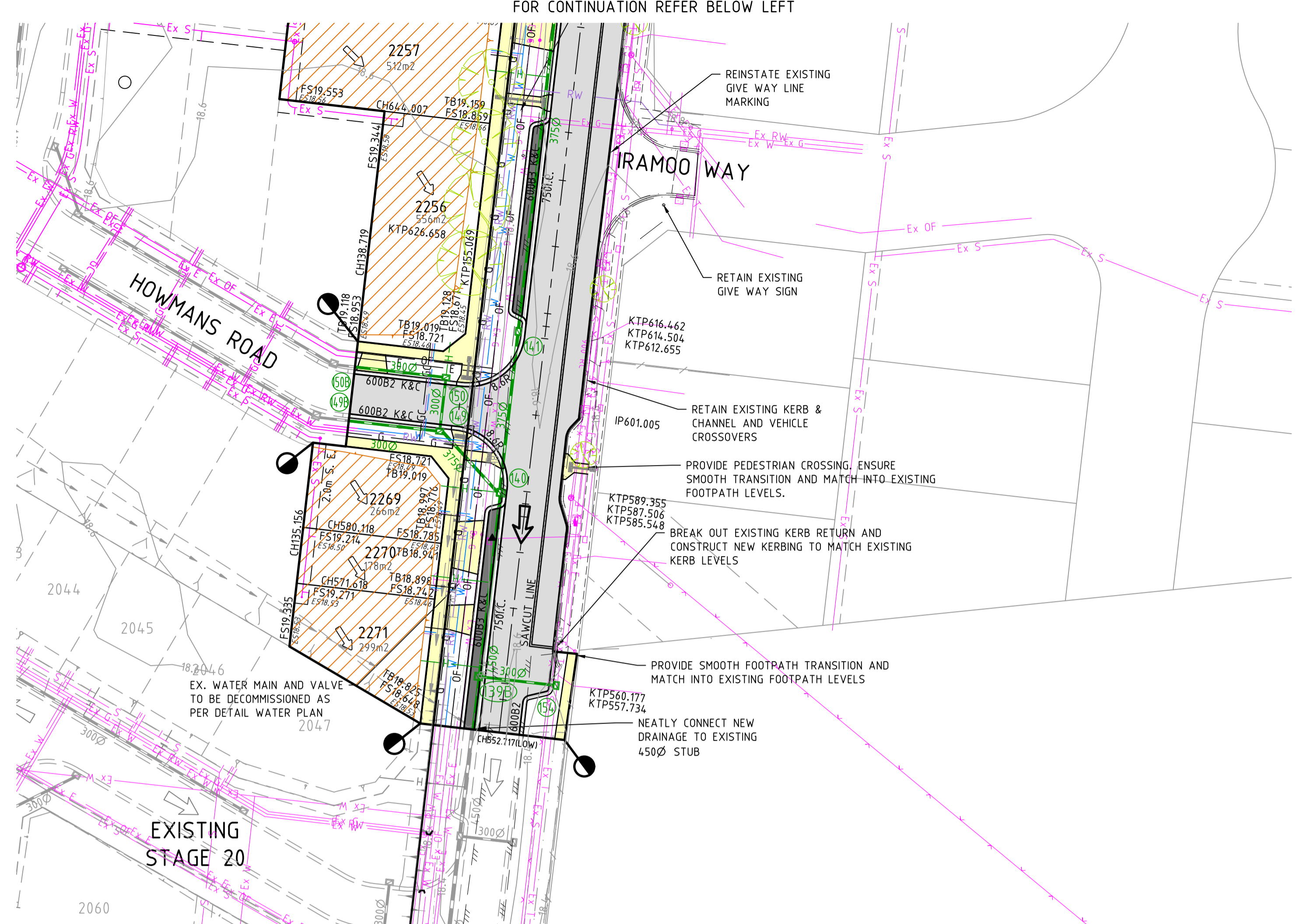
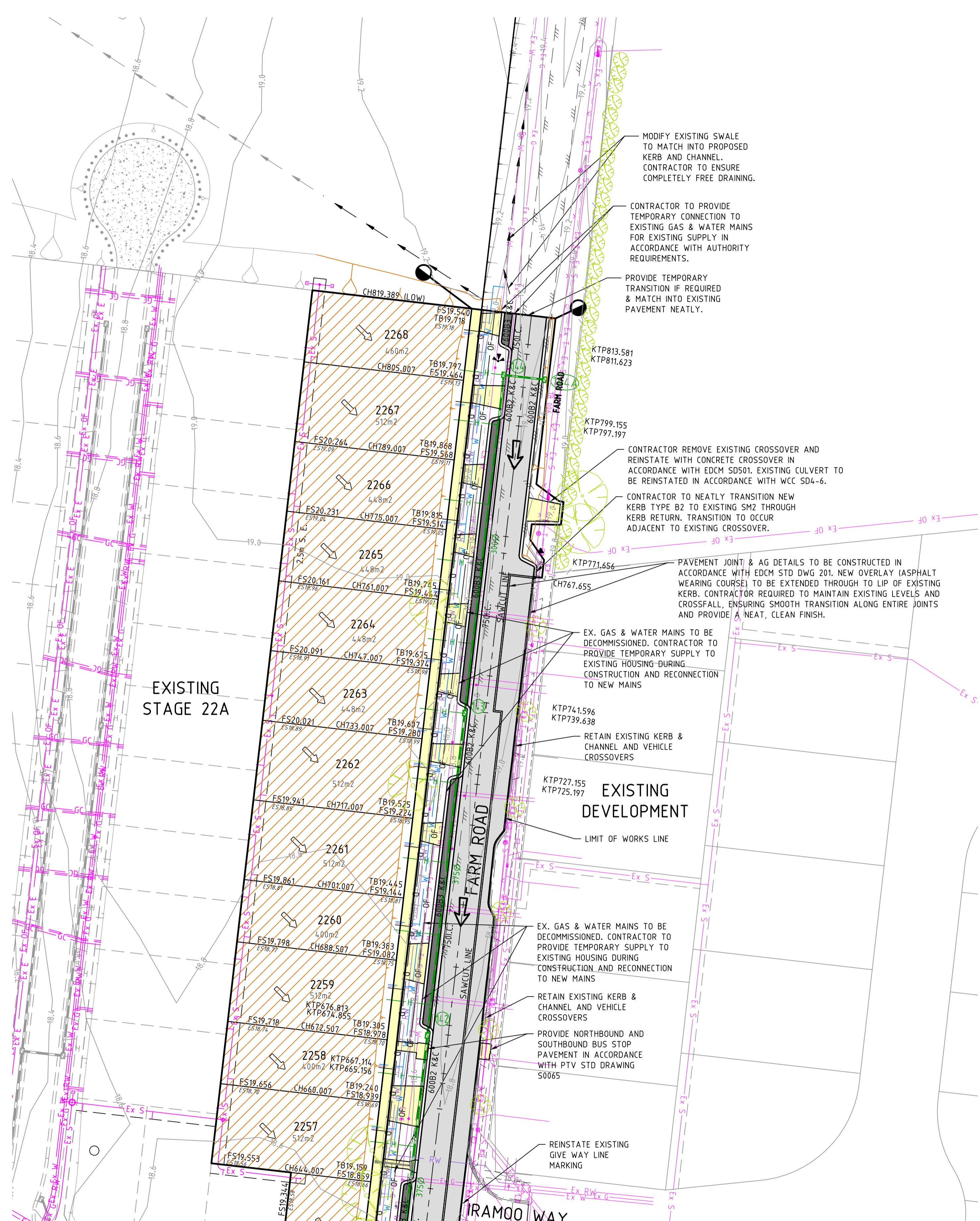

- NOTE**  
ALL EXISTING SERVICES UNDER NEW AND PROPOSED ROAD PAVEMENT, FOOTPATH AND DRIVEWAYS TO BE FCR BACKFILLED.
- NOTE**  
CONCRETE EDGE STRIP AND A.G. DRAIN TO BE INSTALLED AT THE END OF ALL PAVEMENT WORKS.
- NOTE**  
CONSTRUCT TEMPORARY TURNING AREA TO DRAIN FREELY.
- NOTE**  
ALL EX PIT & MH WITHIN NEW WORKS TO BE ADJUSTED TO MATCH NEW FINISHED SURFACE LEVELS.

**BEWARE!**  
TELSTRA OPTIC FIBRE CABLES IN THE VICINITY OF WORKS. TEL: 9253 8263

**DANGER!**  
OVERHEAD ELECTRICITY TRANSMISSION LINES. CONTRACTOR TO EXERCISE EXTREME CAUTION WHEN OPERATING IN THE VICINITY OF THESE LINES. THE CONTRACTOR MUST ADHERE TO ALL "NO GO ZONE" REQUIREMENTS OF THE POWER AUTHORITY.

**WARNING!**  
THE LOCATION OF EXISTING SERVICES SHOWN ON THESE PLANS MUST BE PROVEN ON SITE, THE APPROPRIATE AUTHORITY MUST BE CONTACTED AND THE SERVICES LOCATED PRIOR TO COMMENCEMENT OF ANY WORKS.

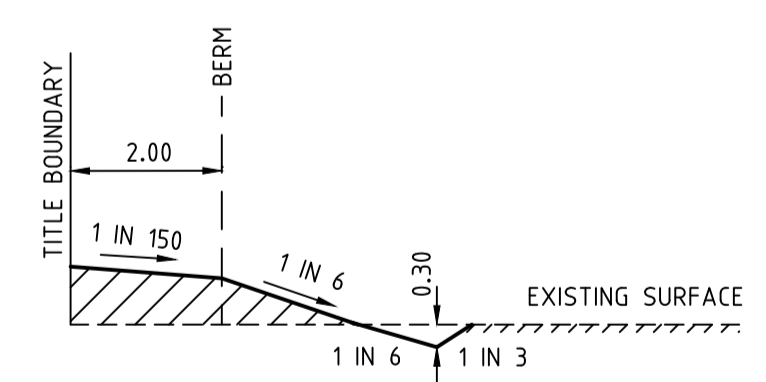

TYPICAL OPEN EARTH DRAIN DETAIL

TABLE OF SERVICES LOCATIONS

STREET NAME	WATER	ND-WATER	GAS	COMMS	ELEC.	POLES	BOK
HOWMANS ROAD	2.90 S	2.50 S	2.10 S	1.725 N	2.50 N	*0.80 N	4.35
FARM ROAD	3.80 W	3.05 W	2.35 W	4.65 W	5.55 W	*0.80 W	8.35 W VARIES

\* FROM BACK OF KERB



**NOT TO BE USED FOR CONSTRUCTION**

Drawn A. WILKINS  
Date 08/03/19  
AN 3341001  
Designed T. HOI  
Date 08/03/19  
AN 2411226  
Verified J. HOLLAND  
Date 08/03/19  
AN 972339  
Approved T. LIAKOPOULOS  
Date 08/03/19  
AN 888557

REV	COUNCIL ISSUE	AMENDMENTS	DATE	APPD.
A			08/03/19	TL

Written dimensions to take precedence over scale. Contractor shall check and verify all dimensions on site. Discrepancies to be brought to the attention of the Superintendent.

- Ex W EXISTING WATER MAIN
- Ex G EXISTING GAS MAIN
- Ex E EXISTING ELECTRICAL CABLE
- Ex S EXISTING SEWER MAIN & MANHOLE
- Ex T EXISTING TELECOMM. CABLE AND PIT
- Ex P EXISTING ELEC. POLE & O'HEAD LINES
- Ex D EXISTING STORMWATER DRAIN & PIT
- Ex C CONSTRUCTED PRE DEVELOPMENT
- Ex T EXISTING TREES TO BE REMOVED
- FS20.06 EXISTING SURFACE LEVEL
- FS21.650 FINISHED SURFACE LEVEL
- Ex S OPEN EARTH DRAIN (O.E.D.)
- BATTER

- LEGEND**
- S SEWER MAIN AND MANHOLE
  - D STORMWATER DRAIN & PIT
  - SW SW DRAIN & PIT CONSTRUCTED IN PREVIOUS STAGES
  - P PROPERTY INLETS
  - H HOUSE DRAIN
  - GC GAS CONDUIT
  - W WATER CONDUIT
  - RW RECYCLED WATER CONDUIT
  - TC TELECOMM. CONDUIT
  - PM PERMANENT SURVEY MARK
  - TM TEMPORARY BENCH MARK

- W WATER
- RW RECYCLED WATER
- OF TELECOMMUNICATIONS
- E ELECTRICITY
- G GAS
- S STREET NAME SIGN
- R REGRADE LOT AT MIN 1 IN 150
- A ASPHALT PAVEMENT
- C CONC FOOTPATH / DRIVEWAY
- O ASPHALT OVERLAY
- F FILLING OVER 200mm
- 155.0 FINISHED SURFACE CONTOUR
- L LIMIT OF WORKS

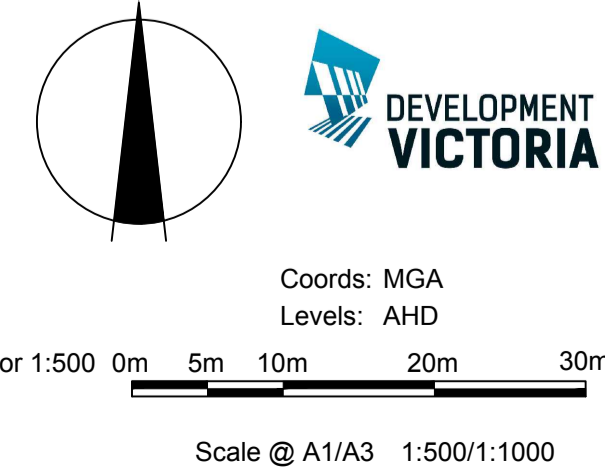

**RIVERWALK**  
STAGE 22B  
GEELONG ROAD, WERRIBEE  
DETAIL PLAN

Drawing No. 10922BDP01 Rev A  
Sheet No. 04 PRELIMINARY



VICTORIA  
T 61 3 9813 7400  
W dceng.com.au

ABN 78 429 221 049  
QUEENSLAND  
T 61 7 3374 9000  
E info@dceng.com.au

© Dalton Consulting Engineers Pty Ltd

Drawing File: C:\124\_Sydney\Drawn\ENERGY-ME\10922-Riverwalk - Stage 22\_BA1 - Stage 22B.rvt  
Date/Time: Fri, 08, 2019 - 11:11am --Andrew--