

ROAD NAME	SERVICES OFFSET SCHEDULE										
	GAS		WATER		RECYCLED WATER		ELECTRICITY		OPTIC FIBRE		SEWER
	SIDE	OFFSET (m)	SIDE	OFFSET (m)	SIDE	OFFSET (m)	SIDE	OFFSET (m)	SIDE	OFFSET (m)	
BLOOM STREET	NORTH	2.05	NORTH	3.05	NORTH	2.55	SOUTH	2.70	SOUTH	2.05	
PERRY STREET	EAST	2.25	EAST	3.25	EAST	2.75	WEST	2.55	WEST	2.05	WEST 0.8
SHADY STREET	EAST	2.25	EAST	3.25	EAST	2.75	WEST	2.55	WEST	2.05	
MURRINDAL STREET	NORTH	2.25	NORTH	3.25	NORTH	2.75	SOUTH	3.10	SOUTH	2.35	
DUTCHELM AVENUE	EAST	2.05	EAST	3.45	EAST	2.70	WEST	3.65	WEST	2.65	FACT 2.8

LEGEND - LAYOUT PLAN

- STORMWATER DRAIN, PIT & PROPERTY INLET
- SWALE DRAIN
- SEWER & MAINTENANCE STRUCTURES
- HOUSE DRAIN
- ELECTRICITY (U.GROUND) (INDICATIVE ONLY)
- ELECTRICITY (O.HEAD) (INDICATIVE ONLY)
- GAS (INDICATIVE ONLY)
- TELSTRA (INDICATIVE ONLY)
- WATER (INDICATIVE ONLY)
- RECYCLED WATER (INDICATIVE ONLY)
- AG. DRAIN (INDICATIVE ONLY)
- OPTIC FIBRE (INDICATIVE ONLY)
- SERVICE CONDUITS
- TACTILE PAVERS
- EXISTING ELECTRICITY (UNDERGROUND) (INDICATIVE ONLY)
- EXISTING ELECTRICITY (OVERHEAD) (INDICATIVE ONLY)
- EXISTING GAS (INDICATIVE ONLY)
- EXISTING TELSTRA (INDICATIVE ONLY)
- EXISTING OPTIC FIBRE (INDICATIVE ONLY)
- EXISTING WATER (INDICATIVE ONLY)
- EXISTING RECYCLED WATER (INDICATIVE ONLY)
- EXISTING STORMWATER DRAIN (INDICATIVE ONLY)
- EXISTING SEWER (INDICATIVE ONLY)
- EXISTING HOUSE DRAIN
- EXISTING SWALE DRAIN
- FUTURE AG DRAIN (INDICATIVE ONLY)
- FUTURE ELECTRICITY (UNDERGROUND) (INDICATIVE ONLY)
- FUTURE ELECTRICITY (OVERHEAD) (INDICATIVE ONLY)
- FUTURE GAS (INDICATIVE ONLY)
- FUTURE TELSTRA (INDICATIVE ONLY)
- FUTURE OPTIC FIBRE (INDICATIVE ONLY)
- FUTURE WATER (INDICATIVE ONLY)
- FUTURE RECYCLED WATER (INDICATIVE ONLY)
- FUTURE STORMWATER DRAIN (INDICATIVE ONLY)
- FUTURE SEWER (INDICATIVE ONLY)
- FUTURE HOUSE DRAIN
- EXISTING SURFACE LEVEL
- FINISHED BUILDING LINE LEVEL
- FINISHED RIDGE LINE LEVEL
- TOP OF RETAINING WALL
- BOTTOM OF RETAINING WALL
- RETAINING WALL
- ZERO LOT LINES
- PAVEMENT TREATMENT
- STRUCTURAL FILL > 200mm DEEP
- EX. STRUCTURAL FILL > 200mm DEEP
- DIRECTION OF FALL
- OVERLAND FLOW
- ALLOTMENT TO BE GRADED EVENLY IN DIRECTION OF FALL TO LEVELS INDICATED
- CONCRETE EDGE STRIP WITH SUBSOIL DRAIN, "NO ROAD" SIGN & BARRIER
- LIMIT OF WORKS
- EXISTING TREE TO BE REMOVED
- EXISTING TREE TO BE RETAINED
- PERMANENT SURVEY MARK
- TEMPORARY BENCH MARK
- PROPOSED DRIVEWAY
- EXISTING GAS (TO BE ABANDONED OR REMOVED)
- EXISTING TELSTRA (TO BE REMOVED)
- EXISTING OPTIC FIBRE (TO BE REMOVED)
- EXISTING WATER (TO BE ABANDONED OR REMOVED)
- EXISTING ELECTRICITY (UNDERGROUND) (TO BE REMOVED)
- EXISTING STORMWATER DRAIN (TO BE REMOVED)
- EXISTING SEWER (TO BE ABANDONED OR REMOVED)
- EXISTING CONTOURS

NOTES:
 ALL EXISTING SERVICES TO BE ABANDONED, REMOVED OR RELOCATED AS PER DISCRETION OF THE RESPONSIBLE AUTHORITY.

WARNING

- OPTIC FIBRE IN VICINITY OF WORKS
- TEL 8317 3685 (PLACES VICTORIA)
- 9253 8263 (TELSTRA)

WARNING
BEWARE OF UNDERGROUND SERVICES
 The locations of underground services are approximate only and their exact position should be proven on site. No guarantee is given that all existing services are shown. Locate all underground services before commencement of works
DIAL 1100 BEFORE YOU DIG
 www.1100.com.au

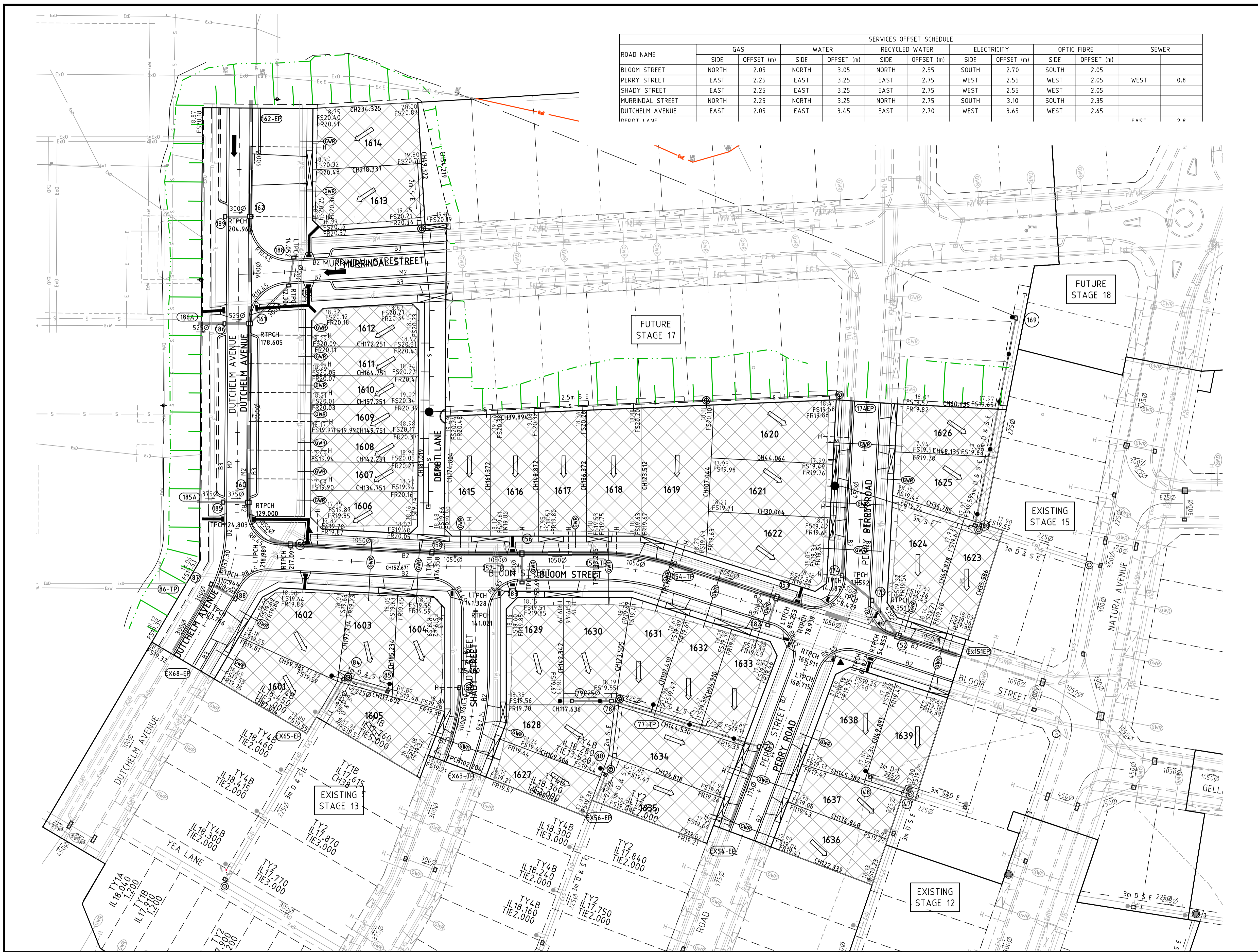

REVISION	DATE	DES/DF	APPD
C	30.11.16	LV	MB
B	09.05.16	LV	ST
A	06.05.16	BC	ST

Principal
 Places Victoria
 710 Collins Street
 Docklands, VIC - 3008

All setting out should be carried out in accordance with GAACouncil's standard drawings or as nominated on hard copy plans provided by SMEC. Any digital information supplied by this office is for information only. Any discrepancies should be discussed with the superintendent.

Designed
 B.Cheung
 Drawn
 S.Sathasivam
 Checked
 L.Vieyra
 Authorised
 S.Sathasivam
 Date
 April 2016

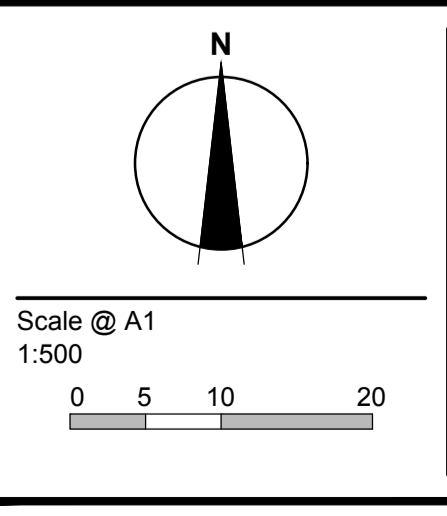

© SMEC Australia Pty Ltd
 ABN 47 065 475 148
 These designs and drawings are the copyright of SMEC Australia Pty Ltd.
 The drawing shall not be reproduced or copied, in whole or part, without the written permission of SMEC Australia Pty Ltd.
 The contents of this drawing are electronically generated, are confidential and may only be used for the purpose for which they are intended.

URBAN DEVELOPMENT
 Level 10, 71 Queens Road, Melbourne VIC 3004
 p +61 3 9514 1500 | f +61 3 9514 1502 | www.smec.com

River Walk
 Stage 16
 Wyndham City Council
 Roadworks and Drainage
 Sales Plan

Drawing No. 1932E-16-98 Rev C
 Sheet No. 1 of 1

Subject to Approval